



# Conduit Seal

## Series EYS, EZS



### Selection Table

Version	Nominal diameter	Required sealing compound for 1 conduit seal	Type	Order number	Weight
					kg
Conduit seals Series EYS 1 ... 3, for vertical conduits  <small>00695E00</small>	NPT 1/2"	0.035 kg	<b>EYS1</b>	<b>108211</b>	0.097
	NPT 3/4"	0.050 kg	<b>EYS2</b>	<b>108212</b>	0.147
	NPT 1"	0.100 kg	<b>EYS3</b>	<b>108213</b>	0.242
Conduit seals Series EYS 5 ... 8, for vertical conduits  <small>00696E00</small>	NPT 1 1/2"	0.240 kg	<b>EYS5</b>	<b>108214</b>	0.528
	NPT 2"	0.380 kg	<b>EYS6</b>	<b>108215</b>	0.634
	NPT 2 1/2"	1.250 kg	<b>EYS7</b>	<b>108216</b>	1.580
	NPT 3"	1.250 kg	<b>EYS8</b>	<b>108217</b>	1.480
Conduit seals Series EZS, for vertical and horizontal conduits  <small>00700E00</small>	NPT 1/2"	0.140 kg	<b>EZS1</b>	<b>108218</b>	0.260
	NPT 3/4"	0.140 kg	<b>EZS2</b>	<b>108219</b>	0.250
	NPT 1"	0.140 kg	<b>EZS3</b>	<b>108220</b>	0.270
	NPT 1 1/2"	0.390 kg	<b>EZS5</b>	<b>108221</b>	0.480
	NPT 2"	0.570 kg	<b>EZS6</b>	<b>108222</b>	0.700
	NPT 2 1/2"	1.000 kg	<b>EZS7</b>	<b>108223</b>	1.500
	NPT 3"	1.000 kg	<b>EZS8</b>	<b>108224</b>	1.740
Conduit seals prevent the passage of gases, vapours or flame through the Ex d conduit systems from one part of the electrical system to another. The seals must be installed as close as possible to the Ex d enclosure, and completely stopped with an approved sealing material. To support the sealing compound until it sets, the seal is plugged with mineral fiber.					

### Explosion Protection

#### Europe (ATEX)

Gas and dust

CESI 03 ATEX 085

⊕ II 2 G Ex d IIC

⊕ II 2 D Ex tD A21 IP66

#### Certifications and certificates

Certificates

ATEX, Kazakhstan (TR), Russia (TR), Belarus (TR)

### Technical Data

#### Mechanical data

Material

aluminium alloy (copper-free)

E10

WebCode EYSA

# Conduit Seal

## Series EYS, EZS

### Accessories and Spare Parts

Designation	Packaging unit	Type	Order number	Weight
	pieces			kg
Sealing compound	1.0 kg	<b>CRV420/1000</b>	<b>109359</b>	1.000
Mineral fiber	0.5 kg	<b>F050</b>	<b>108245</b>	0.500
	1.0 kg	<b>F100</b>	<b>108246</b>	1.010

### Dimensional Drawings (All Dimensions in mm) - Subject to Alterations

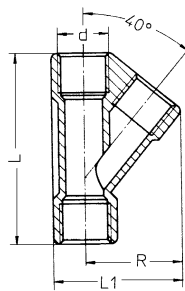

04547E00

**Conduit seals**  
**Series EYS 1 ... 3**

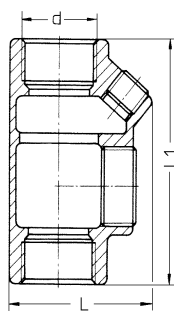

04548E00

**Conduit seals**  
**Series EYS 5 ... 8**

Type	Dimensions d	Dimensions	
		L [mm]	L <sub>1</sub> [mm]
EYS 1	NPT 1/2"	77	56
EYS 2	NPT 3/4"	87	66
EYS 3	NPT 1"	105	82
EYS 5	NPT 1 1/2"	145	84
EYS 6	NPT 2"	150	95
EYS 7	NPT 2 1/2"	200	134
EYS 8	NPT 3"	200	134

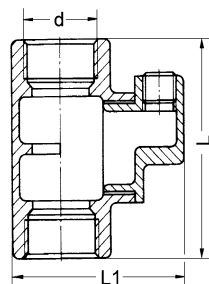

04549E00

**Conduit seals**  
**Series EZS**

Type	Dimensions d	Dimensions	
		L [mm]	L <sub>1</sub> [mm]
EZS 1	NPT 1/2"	86	83
EZS 2	NPT 3/4"	86	83
EZS 3	NPT 1"	87	92
EZS 5	NPT 1 1/2"	109	110
EZS 6	NPT 2"	125	120
EZS 7	NPT 2 1/2"	161	160
EZS 8	NPT 3"	161	160

We reserve the right to make alterations to the technical data, dimensions, weights, designs and products available without notice. The illustrations cannot be considered binding.