

# EXLUX Emergency Luminaire with LED

## Series L409/4 Industrial Design

STAHL

E2

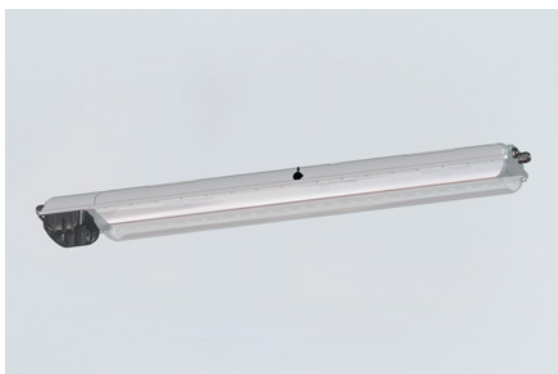

- Long-lasting LED version of the EXLUX family in an industrial design
- Robust, durable enclosure with central lock for use as humid or lighting
- Integrated, automatically started test function for the integrated battery
- Up to 3 hours battery runtime with a luminous flux of 1000 lm in emergency operation
- Available with warm white, neutral white and cold white colour temperatures

### MY R. STAHL L409A

The EXLUX L409/4 light fitting completes the LED linear luminaire range. The industrial design of the emergency luminaires offers all the advantages of the robust enclosure technology and long-lasting LED technology for which the EXLUX range is known. This automatically starts all test functions set out as mandatory in standards and the ergonomic light fitting device provides clear signals. The entire range of installation material for the EXLUX family is also available.

#### Selection Table

Size	2							
Lamp wattage	25 W							
Luminaire efficacy	116 lm/W							
Luminous flux	2910 lm							
Colour temperature	5000 K							
Operating time	Ballast	Threaded plate	Drilled holes	Cable glands and entries	Stopping plugs	Product Type	Art. No.	Weight
1.5 h emergency lighting operation	LED NLE 80W 110-240V/7Ah/1.5h/	2x plastic	3 x M25	2 x M25 Ø 7 ...	2 x M25 x 1.5	L409/4328-5101-162-1110-11-850011	278302	5.4 kg
		2x SS430 stainless steel	3 x M20	Can be ordered as accessories	Can be ordered as accessories	L409/4328-5101-162-2220-22-850011	278303	5.4 kg
Size	4							
Lamp wattage	45 W							
Luminaire efficacy	129 lm/W							
Luminous flux	5810 lm							
Colour temperature	5000 K							
Operating time	Ballast	Threaded plate	Drilled holes	Cable glands and entries	Stopping plugs	Product Type	Art. No.	Weight
1.5 h emergency lighting operation	LED NLE 80W 110-240V/7Ah/1.5h/	2x plastic	3 x M25	2 x M25 Ø 7 ...	2 x M25 x 1.5	L409/4348-5101-162-1110-11-850011	278304	8.1 kg
		2x SS430 stainless steel	3 x M20	Can be ordered as accessories	Can be ordered as accessories	L409/4348-5101-162-2220-22-850011	278305	8.1 kg

#### Variants with 2 x threaded plate plastic and 3 x drilled holes M25:

Cable glands 2 x M25 Ø 7 -17 mm and 2 x stopping plugs M 25 x 1,5 are included loose with the product (installation required). Threaded plate included.

#### Variants with 2 x threaded plate stainless steel SS430 and 3 x drilled holes M20:

Cable glands and stopping plugs can be ordered as accessories. Threaded plate included.



The light fittings are supplied without mounting material.

#### Technical Data

Variant	Size 2	Size 4
<b>Electrical Data</b>		
Rated operational voltage AC	110 ... 240 V	110 ... 240 V
Battery operating voltage	6 V	6 V
Battery capacity	7 Ah	7 Ah
Frequency range	50 – 60 Hz	50 – 60 Hz
Battery version	NiCd battery, gas-tight	NiCd battery, gas-tight

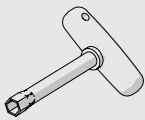
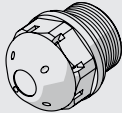
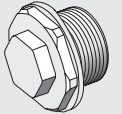
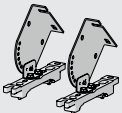
Technical Data		
Variant	Size 2	Size 4
<b>Ambient Conditions</b>		
Ambient temperature	-30 °C ... +50 °C Note: Through wiring Max. 3x16 A -30 °C ... +55 °C Note: Through wiring 2 Max. 3x10 A	-30 °C ... +50 °C Note: Through wiring Max. 3x16 A -30 °C ... +55 °C Note: Through wiring 2 Max. 3x10 A
<b>Lighting Data</b>		
Number of lamps	1	1
Lamp	LED	LED
Light colour	5000 K – neutral white	5000 K – neutral white
Light distribution	120°x120° with diffusing glass	120°x120° with diffusing glass
Emergency light output	65% – 1.5 h	35% – 1.5 h
Colour rendering	≥ 80	≥ 80
<b>Mechanical Data</b>		
Enclosure material	Polyester resin, Glass fibre reinforced	Polyester resin, Glass fibre reinforced
Diffuser	With diffuser	With diffuser
Sealing material	Silicone	Silicone
Installed terminal strip	PE + N + L1 + L2 + L3 + L´	PE + N + L1 + L2 + L3 + L´
Max. solid connection terminals	6 mm <sup>2</sup>	6 mm <sup>2</sup>
Max. finely stranded connection terminals	4 mm <sup>2</sup>	4 mm <sup>2</sup>
Type of connection cable	Finely stranded Solid	Finely stranded Solid
Impact strength (IEC 62262)	IK10	IK10
Enclosure colour	Light grey (RAL 7035)	Light grey (RAL 7035)
Notes	Connection terminals: Spring clamp terminal (2 free clamping units per pole)	
<b>Components</b>		
Through wiring	With 6 conductors 2.5 mm <sup>2</sup>	With 6 conductors 2.5 mm <sup>2</sup>
Cable entry material	Polyamide, black	Polyamide, black
Stopping plug material	Polyamide, black	Polyamide, black

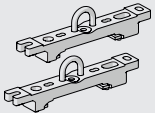
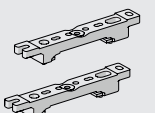
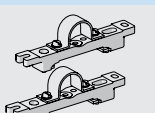
Accessories			
Figure	Description	Art. No.	Weight
<b>Box spanner</b>			
	M8 / A/F 13; For actuating the central lock	222430	110 g
<b>Breather</b>			
	Thread: M25 x 1.5 (20 pieces); without jam nut	285780	200 g
	M25 x 1.5 in order to avoid condensate formation	115738	17 g
	Thread: M25 x 1.5 (1 piece); for installation in light fittings; made from stainless steel; without jam nut	296608	76 g
<b>Ceiling and wall mounting bracket</b>			
	mounted on a mounting rail for a variable mounting distance; Material: stainless steel; Lamp can be swiveled in steps of 15°; 1 pair	222827	1.2 kg

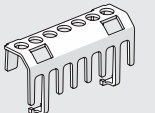
Accessories			
Figure	Description	Art. No.	Weight
<b>Holder for translucent cover</b>			
	The fall prevention system for the light fitting cover prevents the light fitting cover from falling accidentally when the light fitting is opened.	226791	21 g
<b>Mounting bracket</b>			
	mounting clamp mounted on a mounting rail for a variable mounting distance; 1 pair	222456	400 g
<b>Mounting rail</b>			
	for a variable mounting distance; 1 pair	222826	350 g
<b>Pipe clamp</b>			
	R 1 1/2"; with mounting rail for a variable mounting distance; material: stainless steel; 1 pair	222459	700 g
	R 1 1/4"; with mounting rail for a variable mounting distance; Material: stainless steel; 1 pair	222458	700 g
	R 2"; with mounting rail for a variable mounting distance; Material: stainless steel; 1 pair	222460	750 g
<b>Pole mounting sleeve</b>			
	for the subsequent mounting on lights size 2 and size 4, completely with assembly parts (for pipe diameter 42 mm)	227512	3.2 kg
<b>Protection against accidental contact</b>			
	The protection against accidental contact prevents maintenance technicians and electrical installers from accidentally touching conductive parts. The degree of protection is increased to IP20 when the protection against accidental contact is used.	283153	14 g

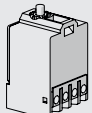
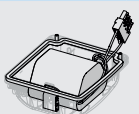
Spare Parts			
Figure	Description	Art. No.	Weight
<b>Cover</b>			
	for luminaire size 4	222428	1.15 kg
	for luminaire size 2	222427	639 g
<b>Contact element</b>			
	8080/1-3-L 2 NC contact element	132527	26 g
<b>Battery set</b>			
	Battery cover with built-in battery. Gas-tight NiCd battery; 7 Ah / 6 V	223532	1.2 kg

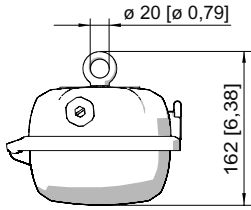

Ring bolt fitted in insert nut of the luminaire

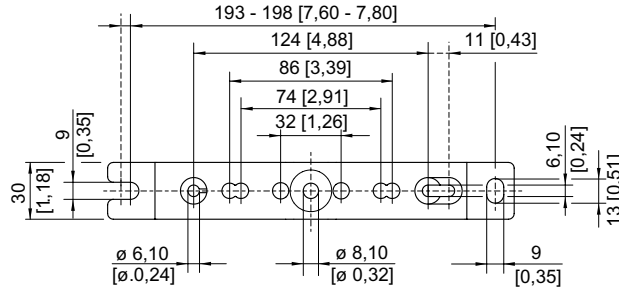
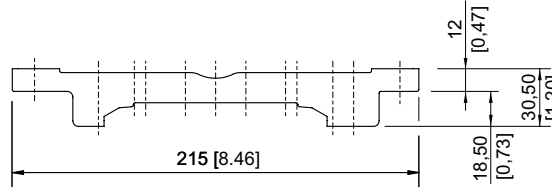

Mounting rail

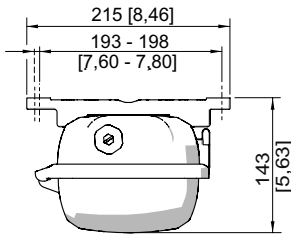

Mounting rail

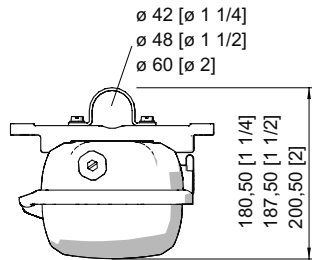

Pipe clamp fitted in mounting rail

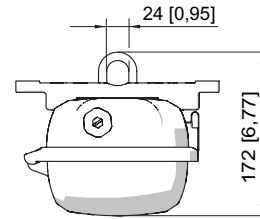

Mounting bracket fitted in mounting rail

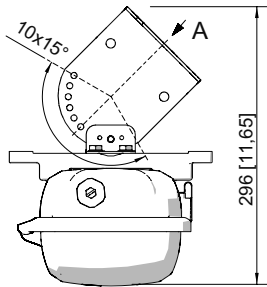

A

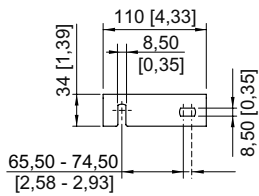

Wall mounting bracket fitted in mounting rail

# EXLUX Emergency Luminaire with LED

Series L409/4 Industrial Design



E2

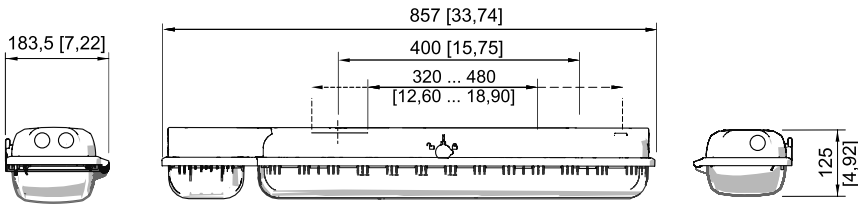

Size 2

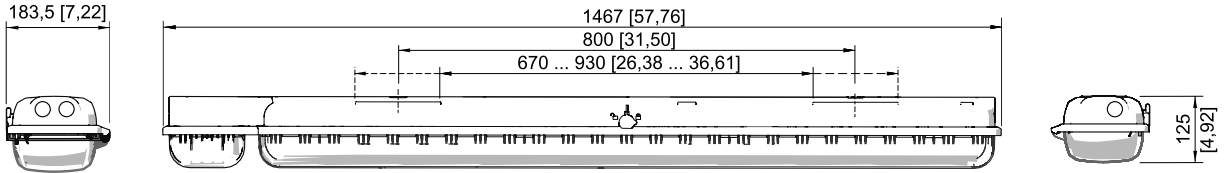

Size 4

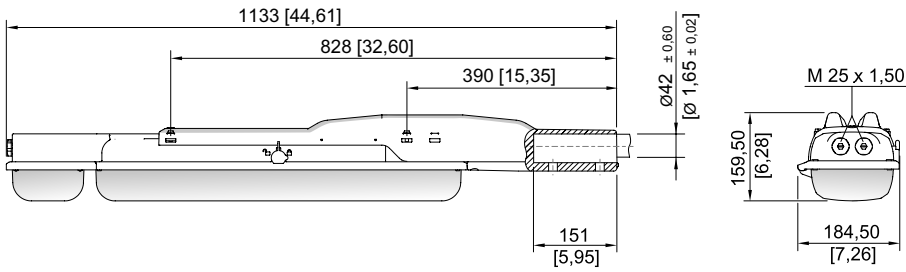

Size 2

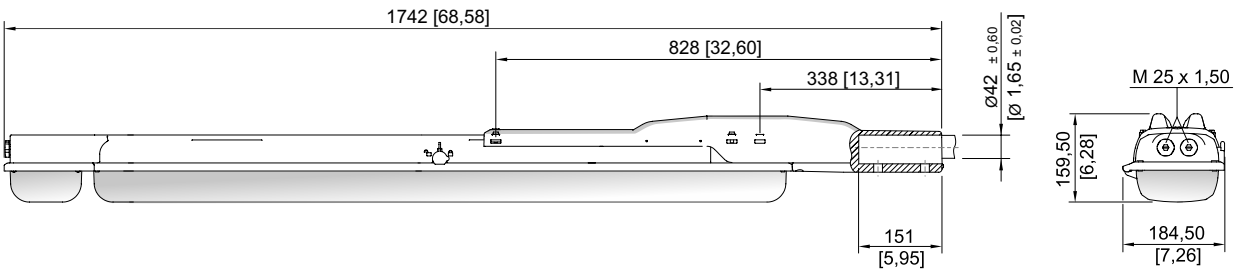

Size 4