



- Checked and approved in accordance with Ex ec type of protection, so vapour tightness test is not applicable
- Stainless steel enclosure as standard for a long service life and safety even under harsh ambient conditions
- Extremely wide range of ambient temperatures – between -60 °C and +60 °C
- Robust design with IK10 and IP66
- Wide-range input with optional 100 V to 277 V
- DALI versions available for lighting control, monitoring and switching

E2

## MY R. STAHL 6525C



The revised generation of LED floodlights for Zone 2 now includes a version with Ex ec type of protection especially for the European market. This eliminates the time-consuming vapour tightness test. The wide-range input now also meets the electrical installation conditions for global use. With an optional DALI interface, the floodlight paves the way to a digital lighting solution. Its extremely low start-up current can also support existing installations, as the circuit breakers that are already installed do not need to be replaced.

	IECEX / ATEX					
Zone	0	1	2	20	21	22
Installation in			•		•	•

Selection Table									
Enclosure material		Stainless steel 1.4301, Powder-coated Single-layer powder-coated							
Lamp wattage	Light distribution	Luminous flux	Luminaire efficacy	Drilled holes	Cable glands and entries	Stopping plugs	Product Type	Art. No.	Weight
100 W	Wide beam	10824 lm	108 lm/W	3 x M25	CMP-25A2F 1 x M25 x 1.5	2 x M25 x 1.5	6525/2224-1501-6015-331	284537	16 kg
160 W	Medium-beam	15413 lm	99 lm/W	3 x M25	CMP-25A2F 1 x M25 x 1.5	2 x M25 x 1.5	6525/2222-3501-6015-331	284539	15 kg
	Wide beam	15550 lm	100 lm/W	3 x M25	CMP-25A2F 1 x M25 x 1.5	2 x M25 x 1.5	6525/2224-3501-6015-331	284538	18 kg
225 W	Narrow-beam	21490 lm	98 lm/W	3 x M25	CMP-25A2F 1 x M25 x 1.5	2 x M25 x 1.5	6525/2221-5501-6015-331	284551	18.5 kg
	Wide beam	20909 lm	95 lm/W	3 x M25	CMP-25A2F 1 x M25 x 1.5	2 x M25 x 1.5	6525/2224-5501-6015-331	284540	18.5 kg
Enclosure material		Stainless steel 1.4404, Powder-coated Double powder-coated							
Lamp wattage	Light distribution	Luminous flux	Luminaire efficacy	Drilled holes	Cable glands and entries	Stopping plugs	Product Type	Art. No.	Weight
100 W	Wide beam	10824 lm	108 lm/W	3 x M25	CMP-25A2F 1 x M25 x 1.5	2 x M25 x 1.5	6525/2224-1501-6015-242	282367	16 kg
160 W	Medium-beam	15413 lm	99 lm/W	3 x M25	CMP-25A2F 1 x M25 x 1.5	2 x M25 x 1.5	6525/2222-3501-6015-242	282369	18 kg
	Wide beam	15550 lm	100 lm/W	3 x M25	CMP-25A2F 1 x M25 x 1.5	2 x M25 x 1.5	6525/2224-3501-6015-242	282368	18 kg
225 W	Narrow-beam	21490 lm	98 lm/W	3 x M25	CMP-25A2F 1 x M25 x 1.5	2 x M25 x 1.5	6525/2221-5501-6015-242	282370	18.5 kg
	Wide beam	20909 lm	95 lm/W	3 x M25	CMP-25A2F 1 x M25 x 1.5	2 x M25 x 1.5	6525/2224-5501-6015-242	282377	18.5 kg

Technical Data			
Variant	Floodlight LED 100 W	Floodlight LED 160 W	Floodlight LED 225 W
<b>Explosion Protection</b>			
IECEX gas explosion protection	Ex db ec IIC T4 Gc	Ex db ec IIC T4 Gc	Ex db ec IIC T4 Gc
IECEX dust explosion protection	Ex tb op is IIIC T100 °C Db	Ex tb op is IIIC T100 °C Db	Ex tb op is IIIC T100 °C Db
ATEX gas explosion protection	⊕ II 3 G Ex db ec IIC T4 Gc	⊕ II 3 G Ex db ec IIC T4 Gc	⊕ II 3 G Ex db ec IIC T4 Gc
ATEX dust explosion protection	⊕ II 2 D Ex tb op is IIIC T100 °C Db	⊕ II 2 D Ex tb op is IIIC T100 °C Db	⊕ II 2 D Ex tb op is IIIC T100 °C Db
Certificates	ATEX (BVIS), IECEx (BVIS), India (PESO)	ATEX (BVIS), IECEx (BVIS), India (PESO)	ATEX (BVIS), IECEx (BVIS), India (PESO)
Declaration of Conformity	ATEX (EUK)	ATEX (EUK)	ATEX (EUK)
<b>Electrical Data</b>			
Rated operational voltage AC	110 ... 277 V	110 ... 277 V	110 ... 277 V
Frequency range	50 – 60 Hz	50 – 60 Hz	50 – 60 Hz
<b>Ambient Conditions</b>			
Ambient temperature	-50 °C ... +60 °C	-60 °C ... +60 °C	-60 °C ... +60 °C
Min. ambient temperature note	Energise above -40 °C	Energise above -40 °C	Energise above -40 °C
Storage temperature	-40 °C ... +75 °C	-40 °C ... +75 °C	-40 °C ... +75 °C
<b>Lighting Data</b>			
Lamp	LED	LED	LED
Colour rendering	≥ 80	≥ 80	≥ 80
Colour temperature	5000 K	5000 K	5000 K
<b>Mechanical Data</b>			
Degree of protection (IP)	IP66	IP66	IP66
Class	I	I	I
Sealing material	Silicone	Silicone	Silicone
Pane material	Reinforced glass	Reinforced glass	Reinforced glass
Max. solid connection terminals	6 mm <sup>2</sup>	6 mm <sup>2</sup>	6 mm <sup>2</sup>
Impact strength (IEC 62262)	IK10	IK10	IK10
Fastening	With bracket, SS316L	With bracket, SS316L	With bracket, SS316L

**Light Distribution Curves – Subject to Alterations**

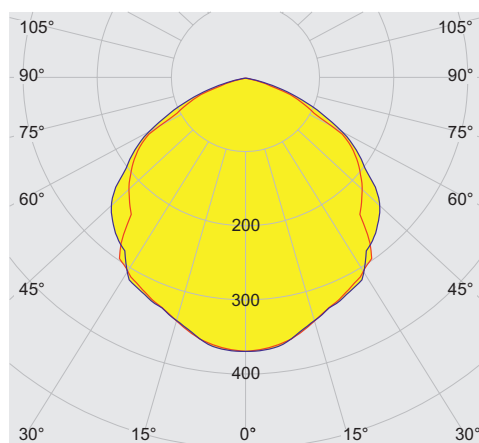

cd/klm 100%  
 — C0 - C180 — C90 - C270  
 typ. broad beam

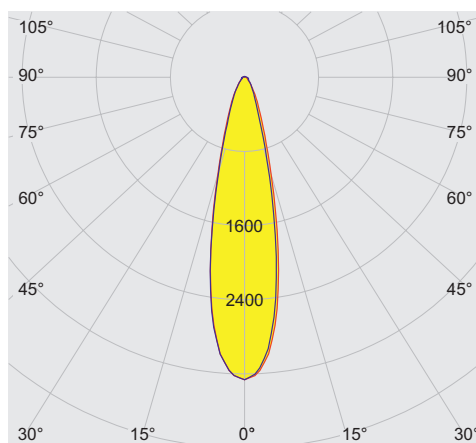

cd/klm 100%  
 — C0 - C180 — C90 - C270  
 typ. narrow beam

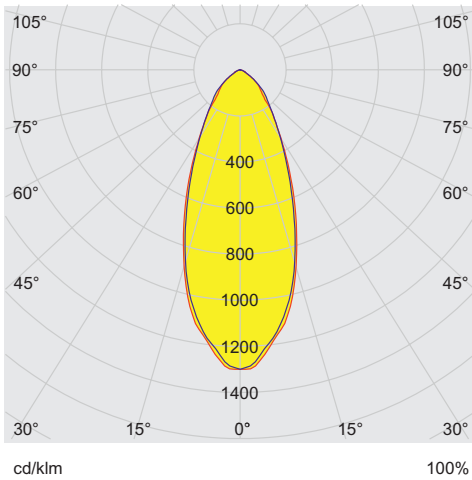

— C0 - C180      — C90 - C270

typ. medium beam

Accessories			
Figure	Description	Art. No.	Weight
<b>Mounting set</b>			
	for pole mounting with pole diameter of 50 mm - stainless steel SS316L (1.4404 or V4A) without powder coating	283361	5 kg
	for pole mounting with pole diameter of 60 mm - stainless steel SS316L (1.4404 or V4A) without powder coating	263824	5 kg
<b>Ring bolt</b>			
	M6 (4 pieces), direct mounting in insert nuts	254234	202 g
<b>Mounting bracket</b>			
	Sheet steel, single powder coated	244604	3.09 kg
	Stainless steel SS316L (1.4404 or V4A) without powder coating	221589	3.13 kg

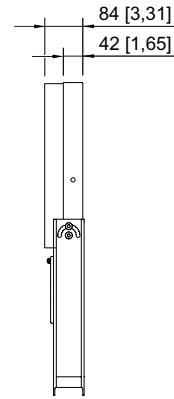
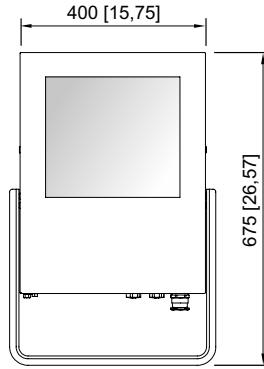
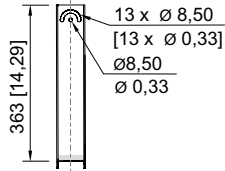
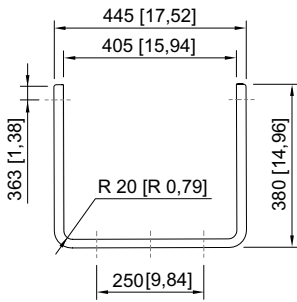

Floodlight with cooling element

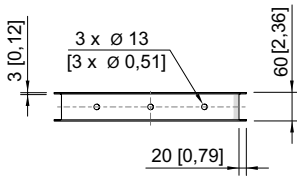

Mounting bracket

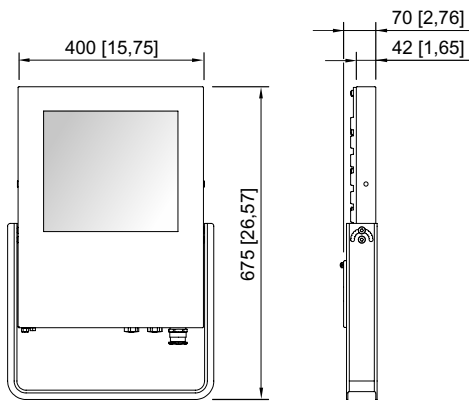

Floodlight without cooling element

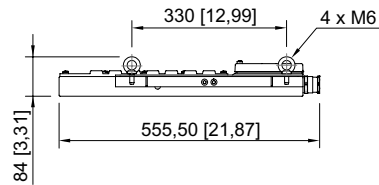

84 [3,31]

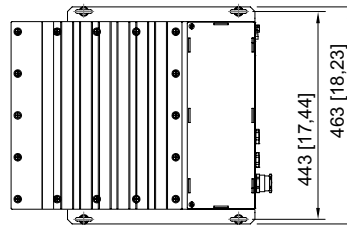

Floodlight without cooling element, with ring eyes

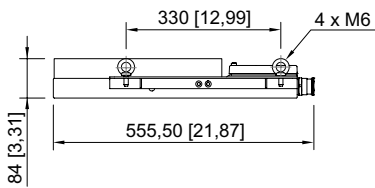

84 [3,31]

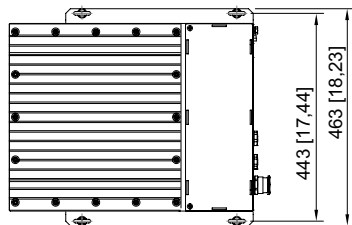

Floodlight with cooling element, with ring eyes

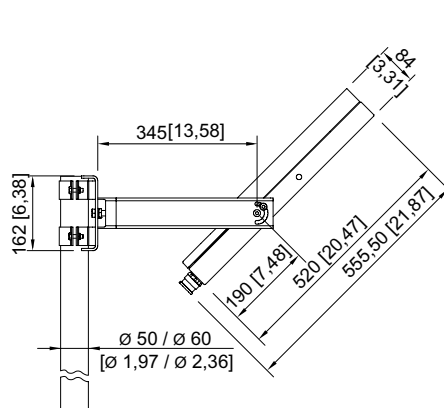

Floodlight with pole mounting

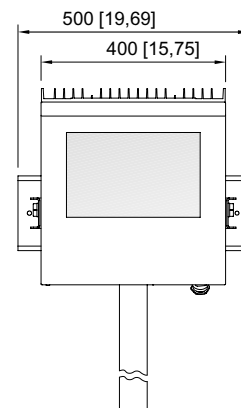

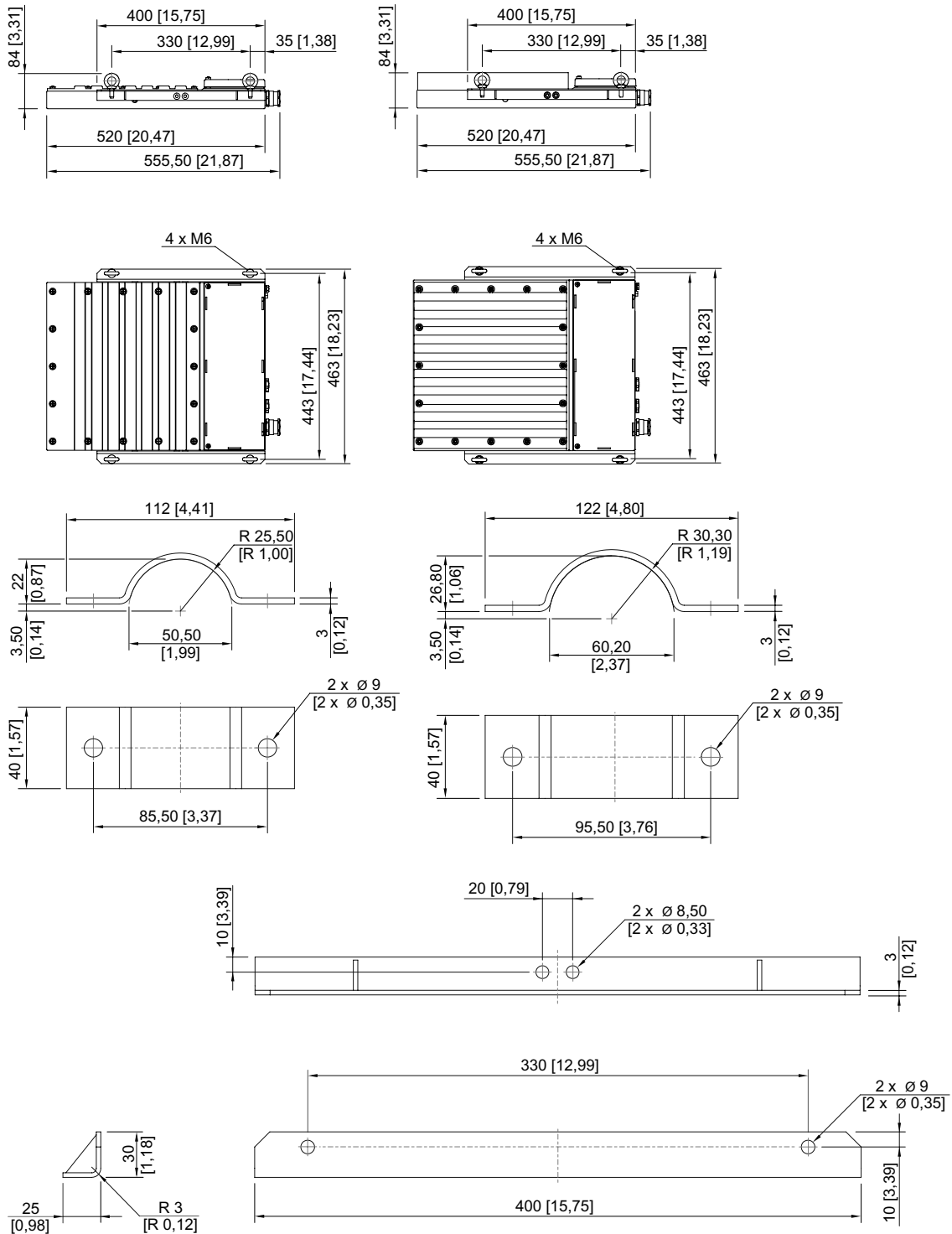

E2

