



- For safely running cables into Ex e and Ex i areas
- Can be used in a temperature range from -60 to +75 °C, degree of protection IP68
- Available in Ex e and Ex i versions; the Ex i version is identified by a blue cap nut
- Cable dia. ranges from 1 to 48 mm
- Versions with multi-seal inserts

## MY R. STAHL 8161B



R. STAHL's Series 8161/7 and 8161/8 cable glands can be used to safely run cables into Ex e enclosures. They are suitable for cable diameters between 1 and 48 mm. They are available for Ex e and Ex i electrical circuits – the Ex i version can be distinguished by its blue cap nut. A stopping plug for unused entries can be integrated into the entries.

|                 | IECEX / ATEX |   |   |    |    |    |
|-----------------|--------------|---|---|----|----|----|
| Zone            | 0            | 1 | 2 | 20 | 21 | 22 |
| Installation in |              | • | • |    | •  | •  |

| Selection Table     |                |                                 |                      |               |              |        |          |                    |          |        |
|---------------------|----------------|---------------------------------|----------------------|---------------|--------------|--------|----------|--------------------|----------|--------|
| Product Description |                | Cable gland For low temperature |                      |               |              |        |          |                    |          |        |
| Ambient temperature |                | -60 °C ... +75 °C               |                      |               |              |        |          |                    |          |        |
| Variant             |                | Standard thread                 |                      |               |              |        |          |                    |          |        |
| Ex version          |                | Ex e                            |                      |               |              |        |          |                    |          |        |
| Thread size         | Clamping range | Width across flats              | Width across corners | Thread length | Total length | Colour | Lot size | Product Type       | Art. No. | Weight |
| M20                 | 7-13 mm        | 24 mm                           | 27 mm                | 10 mm         | 36 to 43 mm  | Black  | 50       | 8161/7-M20-1307-LT | 239204   | 13 g   |
| M25                 | 10-17 mm       | 29 mm                           | 32 mm                | 10 mm         | 38 to 46 mm  | Black  | 50       | 8161/7-M25-1710-LT | 239205   | 19 g   |
| M32                 | 13-21 mm       | 36 mm                           | 40 mm                | 12 mm         | 42 to 50 mm  | Black  | 25       | 8161/7-M32-2113-LT | 239206   | 32 g   |
| M40                 | 17-28 mm       | 46 mm                           | 51 mm                | 12 mm         | 52 to 65 mm  | Black  | 10       | 8161/7-M40-2817-LT | 239207   | 68 g   |
| M50                 | 23-35 mm       | 55 mm                           | 61 mm                | 14 mm         | 59 to 72 mm  | Black  | 4        | 8161/7-M50-3523-LT | 239208   | 107 g  |
| M63                 | 34-48 mm       | 68 mm                           | 75 mm                | 15 mm         | 64 to 78 mm  | Black  | 1        | 8161/7-M63-4834-LT | 239209   | 155 g  |
| Product Description |                | Cable gland For low temperature |                      |               |              |        |          |                    |          |        |
| Ambient temperature |                | -60 °C ... +75 °C               |                      |               |              |        |          |                    |          |        |
| Variant             |                | Standard thread                 |                      |               |              |        |          |                    |          |        |
| Ex version          |                | Ex i                            |                      |               |              |        |          |                    |          |        |
| Thread size         | Clamping range | Width across flats              | Width across corners | Thread length | Total length | Colour | Lot size | Product Type       | Art. No. | Weight |
| M20                 | 7-13 mm        | 24 mm                           | 27 mm                | 10 mm         | 36 to 43 mm  | Blue   | 50       | 8161/8-M20-1307-LT | 239212   | 13 g   |
| M25                 | 10-17 mm       | 29 mm                           | 32 mm                | 10 mm         | 38 to 46 mm  | Blue   | 50       | 8161/8-M25-1710-LT | 239213   | 19 g   |
| M32                 | 13-21 mm       | 36 mm                           | 40 mm                | 12 mm         | 42 to 50 mm  | Blue   | 25       | 8161/8-M32-2113-LT | 239214   | 32 g   |

| Selection Table     |                |                    |  |               |              |        |          |                           |          |        |
|---------------------|----------------|--------------------|--|---------------|--------------|--------|----------|---------------------------|----------|--------|
| Product Description |                |                    | Cable gland For low temperature                |               |              |        |          |                           |          |        |
| Ambient temperature |                |                    | -60 °C ... +75 °C                              |               |              |        |          |                           |          |        |
| Variant             |                |                    | Standard thread                                |               |              |        |          |                           |          |        |
| Ex version          |                |                    | Ex i   |               |              |        |          |                           |          |        |
| Thread size         | Clamping range | Width across flats | Width across corners                           | Thread length | Total length | Colour | Lot size | Product Type              | Art. No. | Weight |
| M40                 | 17-28 mm       | 46 mm              | 51 mm  | 12 mm         | 52 to 65 mm  | Blue   | 10       | 8161/8-M40-2817-LT        | 239215   | 68 g   |
| M50                 | 23-35 mm       | 55 mm              | 61 mm  | 14 mm         | 59 to 72 mm  | Blue   | 4        | 8161/8-M50-3523-LT        | 239216   | 107 g  |
| M63                 | 34-48 mm       | 68 mm              | 75 mm  | 15 mm         | 64 to 78 mm  | Blue   | 1        | 8161/8-M63-4834-LT        | 239217   | 155 g  |
| Product Description |                |                    | Cable gland For low temperature                |               |              |        |          |                           |          |        |
| Ambient temperature |                |                    | -40 °C ... +75 °C                              |               |              |        |          |                           |          |        |
| Variant             |                |                    | Standard thread                                |               |              |        |          |                           |          |        |
| Ex version          |                |                    | Ex e   |               |              |        |          |                           |          |        |
| Thread size         | Clamping range | Width across flats | Width across corners                           | Thread length | Total length | Colour | Lot size | Product Type              | Art. No. | Weight |
| M16                 | 5-9 mm         | 20 mm              | 22 mm  | 9 mm          | 31 to 37 mm  | Black  | 50       | 8161/7-M16-0905-LT        | 239203   | 9 g    |
| Product Description |                |                    | Cable gland For low temperature                |               |              |        |          |                           |          |        |
| Ambient temperature |                |                    | -40 °C ... +75 °C                              |               |              |        |          |                           |          |        |
| Variant             |                |                    | Standard thread                                |               |              |        |          |                           |          |        |
| Ex version          |                |                    | Ex i   |               |              |        |          |                           |          |        |
| Thread size         | Clamping range | Width across flats | Width across corners                           | Thread length | Total length | Colour | Lot size | Product Type              | Art. No. | Weight |
| M16                 | 5-9 mm         | 20 mm              | 22 mm  | 9 mm          | 31 to 37 mm  | Blue   | 50       | 8161/8-M16-0905-LT        | 239211   | 9 g    |
| Product Description |                |                    | Cable gland with multiple sealing insert Black |               |              |        |          |                           |          |        |
| Number of cables    |                |                    | 4  |               |              |        |          |                           |          |        |
| Ambient temperature |                |                    | -40 °C ... +75 °C                              |               |              |        |          |                           |          |        |
| Ex version          |                |                    | Ex e   |               |              |        |          |                           |          |        |
| Thread size         | Clamping range | Width across flats | Width across corners                           | Thread length | Total length | Colour | Lot size | Product Type              | Art. No. | Weight |
| M25                 | 3.20-3.5 mm    | 29 mm              | 32 mm  | 10 mm         | 38 to 46 mm  | Black  | 50       | 8161/7-M25-9999-MFD-04035 | 265083   | 20 g   |
| Product Description |                |                    | Cable gland with multiple sealing insert Black |               |              |        |          |                           |          |        |
| Number of cables    |                |                    | 4  |               |              |        |          |                           |          |        |
| Ambient temperature |                |                    | -40 °C ... +75 °C                              |               |              |        |          |                           |          |        |
| Ex version          |                |                    | Ex i   |               |              |        |          |                           |          |        |
| Thread size         | Clamping range | Width across flats | Width across corners                           | Thread length | Total length | Colour | Lot size | Product Type              | Art. No. | Weight |
| M25                 | 3.20-3.5 mm    | 29 mm              | 32 mm  | 10 mm         | 38 to 46 mm  | Blue   | 50       | 8161/8-M25-9999-MFD-04035 | 265084   | 20 g   |
| Product Description |                |                    | Cable gland with multiple sealing insert Green |               |              |        |          |                           |          |        |
| Number of cables    |                |                    | 4  |               |              |        |          |                           |          |        |
| Ambient temperature |                |                    | -40 °C ... +75 °C                              |               |              |        |          |                           |          |        |
| Ex version          |                |                    | Ex e   |               |              |        |          |                           |          |        |
| Thread size         | Clamping range | Width across flats | Width across corners                           | Thread length | Total length | Colour | Lot size | Product Type              | Art. No. | Weight |
| M25                 | 4.10-4.5 mm    | 29 mm              | 32 mm  | 10 mm         | 38 to 46 mm  | Black  | 50       | 8161/7-M25-9999-MFD-04045 | 265085   | 20 g   |
| Product Description |                |                    | Cable gland with multiple sealing insert Green |               |              |        |          |                           |          |        |
| Number of cables    |                |                    | 4  |               |              |        |          |                           |          |        |
| Ambient temperature |                |                    | -40 °C ... +75 °C                              |               |              |        |          |                           |          |        |
| Ex version          |                |                    | Ex i   |               |              |        |          |                           |          |        |
| Thread size         | Clamping range | Width across flats | Width across corners                           | Thread length | Total length | Colour | Lot size | Product Type              | Art. No. | Weight |
| M25                 | 4.10-4.5 mm    | 29 mm              | 32 mm  | 10 mm         | 38 to 46 mm  | Blue   | 50       | 8161/8-M25-9999-MFD-04045 | 265086   | 20 g   |

| Selection Table  |                |                    |                      |  |              |        |          |                           |          |        |  |
|--|----------------|--------------------|----------------------|--|--------------|--------|----------|---------------------------|----------|--------|--|
| Product Description<br>Number of cables<br>Ambient temperature<br>Ex version |                |                    |                      | Cable gland with multiple sealing insert Red<br>4<br>-40 °C ... +75 °C<br>Ex e               |              |        |          |                           |          |        |  |
| Thread size  | Clamping range | Width across flats | Width across corners | Thread length  | Total length | Colour | Lot size | Product Type              | Art. No. | Weight |  |
| M25  | 4.70-5.2 mm    | 29 mm              | 32 mm                | 10 mm  | 38 to 46 mm  | Black  | 50       | 8161/7-M25-9999-MFD-04052 | 265087   | 20 g   |  |
| M32  | 4.50-5 mm      | 36 mm              | 40 mm                | 12 mm  | 42 to 50 mm  | Black  | 25       | 8161/7-M32-9999-MFD-04050 | 265089   | 36 g   |  |
| Product Description<br>Number of cables<br>Ambient temperature<br>Ex version |                |                    |                      | Cable gland with multiple sealing insert Red<br>4<br>-40 °C ... +75 °C<br>Ex i               |              |        |          |                           |          |        |  |
| Thread size  | Clamping range | Width across flats | Width across corners | Thread length  | Total length | Colour | Lot size | Product Type              | Art. No. | Weight |  |
| M25  | 4.70-5.2 mm    | 29 mm              | 32 mm                | 10 mm  | 38 to 46 mm  | Blue   | 50       | 8161/8-M25-9999-MFD-04052 | 265088   | 20 g   |  |
| M32  | 4.50-5 mm      | 36 mm              | 40 mm                | 12 mm  | 42 to 50 mm  | Blue   | 25       | 8161/8-M32-9999-MFD-04050 | 265090   | 36 g   |  |
| Product Description<br>Number of cables<br>Ambient temperature<br>Ex version |                |                    |                      | Cable gland with multiple sealing insert White<br>4<br>-40 °C ... +75 °C<br>Ex e             |              |        |          |                           |          |        |  |
| Thread size  | Clamping range | Width across flats | Width across corners | Thread length  | Total length | Colour | Lot size | Product Type              | Art. No. | Weight |  |
| M25  | 3.60-4 mm      | 29 mm              | 32 mm                | 10 mm  | 38 to 46 mm  | Black  | 50       | 8161/7-M25-9999-MFD-04040 | 261983   | 20 g   |  |
| M25  | 5.40-6 mm      | 29 mm              | 32 mm                | 10 mm  | 38 to 46 mm  | Black  | 50       | 8161/7-M25-9999-MFD-04060 | 261981   | 20 g   |  |
| M32  | 6.30-7 mm      | 36 mm              | 40 mm                | 12 mm  | 42 to 50 mm  | Black  | 25       | 8161/7-M32-9999-MFD-04070 | 265091   | 36 g   |  |
| Product Description<br>Number of cables<br>Ambient temperature<br>Ex version |                |                    |                      | Cable gland with multiple sealing insert White<br>4<br>-40 °C ... +75 °C<br>Ex i             |              |        |          |                           |          |        |  |
| Thread size  | Clamping range | Width across flats | Width across corners | Thread length  | Total length | Colour | Lot size | Product Type              | Art. No. | Weight |  |
| M25  | 3.60-4 mm      | 29 mm              | 32 mm                | 10 mm  | 38 to 46 mm  | Blue   | 50       | 8161/8-M25-9999-MFD-04040 | 261984   | 20 g   |  |
| M25  | 5.40-6 mm      | 29 mm              | 32 mm                | 10 mm  | 38 to 46 mm  | Blue   | 50       | 8161/8-M25-9999-MFD-04060 | 261982   | 20 g   |  |
| M32  | 6.30-7 mm      | 36 mm              | 40 mm                | 12 mm  | 42 to 50 mm  | Blue   | 25       | 8161/8-M32-9999-MFD-04070 | 265092   | 36 g   |  |
| Product Description<br>Ambient temperature<br>Variant<br>Ex version          |                |                    |                      | Cable gland Without reduction sealing insert<br>-40 °C ... +75 °C<br>Standard thread<br>Ex e |              |        |          |                           |          |        |  |
| Thread size  | Clamping range | Width across flats | Width across corners | Thread length  | Total length | Colour | Lot size | Product Type              | Art. No. | Weight |  |
| M16  | 5-9 mm         | 20 mm              | 22 mm                | 9 mm   | 31 to 37 mm  | Black  | 50       | 8161/7-M16-0905           | 239171   | 9 g    |  |
| M20  | 7-13 mm        | 24 mm              | 27 mm                | 10 mm  | 36 to 43 mm  | Black  | 50       | 8161/7-M20-1307           | 239172   | 13 g   |  |
| M25  | 10-17 mm       | 29 mm              | 32 mm                | 10 mm  | 38 to 46 mm  | Black  | 50       | 8161/7-M25-1710           | 239173   | 19 g   |  |

**Selection Table**

| Product Description |                | Cable gland Without reduction sealing insert |                      |               |              |        |          |                   |          |        |
|---------------------|----------------|--|----------------------|---------------|--------------|--------|----------|-------------------|----------|--------|
| Ambient temperature |                | -40 °C ... +75 °C                            |                      |               |              |        |          |                   |          |        |
| Variant             |                | Standard thread                              |                      |               |              |        |          |                   |          |        |
| Ex version          |                | Ex e   |                      |               |              |        |          |                   |          |        |
| Thread size         | Clamping range | Width across flats                           | Width across corners | Thread length | Total length | Colour | Lot size | Product Type      | Art. No. | Weight |
| M32                 | 13-21 mm       | 36 mm  | 40 mm                | 12 mm         | 42 to 50 mm  | Black  | 25       | 8161/7-M32-2113   | 239174   | 32 g   |
| M40                 | 17-28 mm       | 46 mm  | 51 mm                | 12 mm         | 52 to 65 mm  | Black  | 10       | 8161/7-M40-2817   | 239175   | 68 g   |
| M50                 | 23-35 mm       | 55 mm  | 61 mm                | 14 mm         | 59 to 72 mm  | Black  | 4        | 8161/7-M50-3523   | 239176   | 107 g  |
| M63                 | 34-48 mm       | 68 mm  | 75 mm                | 15 mm         | 64 to 78 mm  | Black  | 1        | 8161/7-M63-4834   | 239177   | 155 g  |
| Product Description |                | Cable gland Without reduction sealing insert |                      |               |              |        |          |                   |          |        |
| Ambient temperature |                | -40 °C ... +75 °C                            |                      |               |              |        |          |                   |          |        |
| Variant             |                | Standard thread                              |                      |               |              |        |          |                   |          |        |
| Ex version          |                | Ex i   |                      |               |              |        |          |                   |          |        |
| Thread size         | Clamping range | Width across flats                           | Width across corners | Thread length | Total length | Colour | Lot size | Product Type      | Art. No. | Weight |
| M16                 | 5-9 mm         | 20 mm  | 22 mm                | 9 mm          | 31 to 37 mm  | Blue   | 50       | 8161/8-M16-0905   | 239179   | 9 g    |
| M20                 | 7-13 mm        | 24 mm  | 27 mm                | 10 mm         | 36 to 43 mm  | Blue   | 50       | 8161/8-M20-1307   | 239180   | 13 g   |
| M25                 | 10-17 mm       | 29 mm  | 32 mm                | 10 mm         | 38 to 46 mm  | Blue   | 50       | 8161/8-M25-1710   | 239181   | 19 g   |
| M32                 | 13-21 mm       | 36 mm  | 40 mm                | 12 mm         | 42 to 50 mm  | Blue   | 25       | 8161/8-M32-2113   | 239182   | 32 g   |
| M40                 | 17-28 mm       | 46 mm  | 51 mm                | 12 mm         | 52 to 65 mm  | Blue   | 10       | 8161/8-M40-2817   | 239183   | 68 g   |
| M50                 | 23-35 mm       | 55 mm  | 61 mm                | 14 mm         | 59 to 72 mm  | Blue   | 4        | 8161/8-M50-3523   | 239184   | 107 g  |
| M63                 | 34-48 mm       | 68 mm  | 75 mm                | 15 mm         | 64 to 78 mm  | Blue   | 1        | 8161/8-M63-4834   | 239185   | 155 g  |
| Product Description |                | Cable gland Without reduction sealing insert |                      |               |              |        |          |                   |          |        |
| Ambient temperature |                | 15 °C ... +65 °C                             |                      |               |              |        |          |                   |          |        |
| Variant             |                | Standard thread                              |                      |               |              |        |          |                   |          |        |
| Ex version          |                | Ex e   |                      |               |              |        |          |                   |          |        |
| Thread size         | Clamping range | Width across flats                           | Width across corners | Thread length | Total length | Colour | Lot size | Product Type      | Art. No. | Weight |
| M12                 | 3-6 mm         | 16 mm  | 18 mm                | 9 mm          | 29 to 34 mm  | Black  | 50       | 8161/7-M12-0603   | 239170   | 7 g    |
| Product Description |                | Cable gland Without reduction sealing insert |                      |               |              |        |          |                   |          |        |
| Ambient temperature |                | 15 °C ... +65 °C                             |                      |               |              |        |          |                   |          |        |
| Variant             |                | Standard thread                              |                      |               |              |        |          |                   |          |        |
| Ex version          |                | Ex i   |                      |               |              |        |          |                   |          |        |
| Thread size         | Clamping range | Width across flats                           | Width across corners | Thread length | Total length | Colour | Lot size | Product Type      | Art. No. | Weight |
| M12                 | 3-6 mm         | 16 mm  | 18 mm                | 9 mm          | 29 to 34 mm  | Blue   | 50       | 8161/8-M12-0603   | 239178   | 7 g    |
| Product Description |                | Cable gland With reduction sealing insert    |                      |               |              |        |          |                   |          |        |
| Ambient temperature |                | -40 °C ... +75 °C                            |                      |               |              |        |          |                   |          |        |
| Variant             |                | Long thread                                  |                      |               |              |        |          |                   |          |        |
| Ex version          |                | Ex e   |                      |               |              |        |          |                   |          |        |
| Thread size         | Clamping range | Width across flats                           | Width across corners | Thread length | Total length | Colour | Lot size | Product Type      | Art. No. | Weight |
| M16                 | 2-9 mm         | 20 mm  | 22 mm                | 15 mm         | 37 to 43 mm  | Black  | 50       | 8161/7-M16-0902-L | 239187   | 9 g    |
| M20                 | 4-13 mm        | 24 mm  | 27 mm                | 15 mm         | 41 to 48 mm  | Black  | 50       | 8161/7-M20-1304-L | 239188   | 13 g   |
| M25                 | 7-17 mm        | 29 mm  | 32 mm                | 15 mm         | 43 to 51 mm  | Black  | 50       | 8161/7-M25-1707-L | 239189   | 19 g   |

| Selection Table     |                |                    |   |               |              |        |          |                   |          |        |
|---------------------|----------------|--------------------|---|---------------|--------------|--------|----------|-------------------|----------|--------|
| Product Description |                |                    | Cable gland With reduction sealing insert |               |              |        |          |                   |          |        |
| Ambient temperature |                |                    | -40 °C ... +75 °C                         |               |              |        |          |                   |          |        |
| Variant             |                |                    | Long thread                               |               |              |        |          |                   |          |        |
| Ex version          |                |                    | Ex e                                      |               |              |        |          |                   |          |        |
| Thread size         | Clamping range | Width across flats | Width across corners                      | Thread length | Total length | Colour | Lot size | Product Type      | Art. No. | Weight |
| M32                 | 9-21 mm        | 36 mm              | 40 mm                                     | 15 mm         | 45 to 53 mm  | Black  | 25       | 8161/7-M32-2109-L | 239190   | 32 g   |
| M40                 | 12-28 mm       | 46 mm              | 51 mm                                     | 18 mm         | 58 to 71 mm  | Black  | 10       | 8161/7-M40-2812-L | 239191   | 68 g   |
| M50                 | 16-35 mm       | 55 mm              | 61 mm                                     | 18 mm         | 63 to 76 mm  | Black  | 4        | 8161/7-M50-3516-L | 239192   | 107 g  |
| M63                 | 28-48 mm       | 68 mm              | 75 mm                                     | 18 mm         | 67 to 81 mm  | Black  | 1        | 8161/7-M63-4828-L | 239193   | 155 g  |
| Product Description |                |                    | Cable gland With reduction sealing insert |               |              |        |          |                   |          |        |
| Ambient temperature |                |                    | -40 °C ... +75 °C                         |               |              |        |          |                   |          |        |
| Variant             |                |                    | Long thread                               |               |              |        |          |                   |          |        |
| Ex version          |                |                    | Ex i                                      |               |              |        |          |                   |          |        |
| Thread size         | Clamping range | Width across flats | Width across corners                      | Thread length | Total length | Colour | Lot size | Product Type      | Art. No. | Weight |
| M16                 | 2-9 mm         | 20 mm              | 22 mm                                     | 15 mm         | 37 to 43 mm  | Blue   | 50       | 8161/8-M16-0902-L | 239195   | 9 g    |
| M20                 | 4-13 mm        | 24 mm              | 27 mm                                     | 15 mm         | 41 to 48 mm  | Blue   | 50       | 8161/8-M20-1304-L | 239196   | 13 g   |
| M25                 | 7-17 mm        | 29 mm              | 32 mm                                     | 15 mm         | 43 to 51 mm  | Blue   | 50       | 8161/8-M25-1707-L | 239197   | 19 g   |
| M32                 | 9-21 mm        | 36 mm              | 40 mm                                     | 15 mm         | 45 to 53 mm  | Blue   | 25       | 8161/8-M32-2109-L | 239198   | 32 g   |
| M40                 | 12-28 mm       | 46 mm              | 51 mm                                     | 18 mm         | 58 to 71 mm  | Blue   | 10       | 8161/8-M40-2812-L | 239199   | 68 g   |
| M63                 | 28-48 mm       | 68 mm              | 75 mm                                     | 18 mm         | 67 to 81 mm  | Blue   | 1        | 8161/8-M63-4828-L | 239201   | 155 g  |
| Product Description |                |                    | Cable gland With reduction sealing insert |               |              |        |          |                   |          |        |
| Ambient temperature |                |                    | -40 °C ... +75 °C                         |               |              |        |          |                   |          |        |
| Variant             |                |                    | Standard thread                           |               |              |        |          |                   |          |        |
| Ex version          |                |                    | Ex e                                      |               |              |        |          |                   |          |        |
| Thread size         | Clamping range | Width across flats | Width across corners                      | Thread length | Total length | Colour | Lot size | Product Type      | Art. No. | Weight |
| M16                 | 2-9 mm         | 20 mm              | 22 mm                                     | 9 mm          | 31 to 37 mm  | Black  | 50       | 8161/7-M16-0902   | 239155   | 9 g    |
| M20                 | 4-13 mm        | 24 mm              | 27 mm                                     | 10 mm         | 36 to 43 mm  | Black  | 50       | 8161/7-M20-1304   | 239156   | 13 g   |
| M25                 | 7-17 mm        | 29 mm              | 32 mm                                     | 10 mm         | 38 to 46 mm  | Black  | 50       | 8161/7-M25-1707   | 239157   | 19 g   |
| M32                 | 9-21 mm        | 36 mm              | 40 mm                                     | 12 mm         | 42 to 50 mm  | Black  | 25       | 8161/7-M32-2109   | 239158   | 32 g   |
| M40                 | 12-28 mm       | 46 mm              | 51 mm                                     | 12 mm         | 52 to 65 mm  | Black  | 10       | 8161/7-M40-2812   | 239159   | 68 g   |
| M50                 | 16-35 mm       | 55 mm              | 61 mm                                     | 14 mm         | 59 to 72 mm  | Black  | 4        | 8161/7-M50-3516   | 239160   | 107 g  |
| M63                 | 28-48 mm       | 68 mm              | 75 mm                                     | 15 mm         | 64 to 78 mm  | Black  | 1        | 8161/7-M63-4828   | 239161   | 155 g  |
| Product Description |                |                    | Cable gland With reduction sealing insert |               |              |        |          |                   |          |        |
| Ambient temperature |                |                    | -40 °C ... +75 °C                         |               |              |        |          |                   |          |        |
| Variant             |                |                    | Standard thread                           |               |              |        |          |                   |          |        |
| Ex version          |                |                    | Ex i                                      |               |              |        |          |                   |          |        |
| Thread size         | Clamping range | Width across flats | Width across corners                      | Thread length | Total length | Colour | Lot size | Product Type      | Art. No. | Weight |
| M16                 | 2-9 mm         | 20 mm              | 22 mm                                     | 9 mm          | 31 to 37 mm  | Blue   | 50       | 8161/8-M16-0902   | 239163   | 9 g    |
| M20                 | 4-13 mm        | 24 mm              | 27 mm                                     | 10 mm         | 36 to 43 mm  | Blue   | 50       | 8161/8-M20-1304   | 239164   | 13 g   |

| Selection Table     |                |                    |   |               |              |        |          |                   |          |        |
|---------------------|----------------|--------------------|---|---------------|--------------|--------|----------|-------------------|----------|--------|
| Product Description |                |                    | Cable gland With reduction sealing insert |               |              |        |          |                   |          |        |
| Ambient temperature |                |                    | -40 °C ... +75 °C                         |               |              |        |          |                   |          |        |
| Variant             |                |                    | Standard thread                           |               |              |        |          |                   |          |        |
| Ex version          |                |                    | Ex i                                      |               |              |        |          |                   |          |        |
| Thread size         | Clamping range | Width across flats | Width across corners                      | Thread length | Total length | Colour | Lot size | Product Type      | Art. No. | Weight |
| M25                 | 7-17 mm        | 29 mm              | 32 mm                                     | 10 mm         | 38 to 46 mm  | Blue   | 50       | 8161/8-M25-1707   | 239165   | 19 g   |
| M32                 | 9-21 mm        | 36 mm              | 40 mm                                     | 12 mm         | 42 to 50 mm  | Blue   | 25       | 8161/8-M32-2109   | 239166   | 32 g   |
| M40                 | 12-28 mm       | 46 mm              | 51 mm                                     | 12 mm         | 52 to 65 mm  | Blue   | 10       | 8161/8-M40-2812   | 239167   | 68 g   |
| M50                 | 16-35 mm       | 55 mm              | 61 mm                                     | 14 mm         | 59 to 72 mm  | Blue   | 4        | 8161/8-M50-3516   | 239168   | 107 g  |
| M63                 | 28-48 mm       | 68 mm              | 75 mm                                     | 15 mm         | 64 to 78 mm  | Blue   | 1        | 8161/8-M63-4828   | 239169   | 155 g  |
| Product Description |                |                    | Cable gland With reduction sealing insert |               |              |        |          |                   |          |        |
| Ambient temperature |                |                    | 15 °C ... +65 °C                          |               |              |        |          |                   |          |        |
| Variant             |                |                    | Long thread                               |               |              |        |          |                   |          |        |
| Ex version          |                |                    | Ex e                                      |               |              |        |          |                   |          |        |
| Thread size         | Clamping range | Width across flats | Width across corners                      | Thread length | Total length | Colour | Lot size | Product Type      | Art. No. | Weight |
| M12                 | 1-6 mm         | 16 mm              | 18 mm                                     | 15 mm         | 35 to 40 mm  | Black  | 50       | 8161/7-M12-0601-L | 239186   | 7 g    |
| Product Description |                |                    | Cable gland With reduction sealing insert |               |              |        |          |                   |          |        |
| Ambient temperature |                |                    | 15 °C ... +65 °C                          |               |              |        |          |                   |          |        |
| Variant             |                |                    | Long thread                               |               |              |        |          |                   |          |        |
| Ex version          |                |                    | Ex i                                      |               |              |        |          |                   |          |        |
| Thread size         | Clamping range | Width across flats | Width across corners                      | Thread length | Total length | Colour | Lot size | Product Type      | Art. No. | Weight |
| M12                 | 1-6 mm         | 16 mm              | 18 mm                                     | 15 mm         | 35 to 40 mm  | Blue   | 50       | 8161/8-M12-0601-L | 239194   | 7 g    |
| Product Description |                |                    | Cable gland With reduction sealing insert |               |              |        |          |                   |          |        |
| Ambient temperature |                |                    | 15 °C ... +65 °C                          |               |              |        |          |                   |          |        |
| Variant             |                |                    | Standard thread                           |               |              |        |          |                   |          |        |
| Ex version          |                |                    | Ex e                                      |               |              |        |          |                   |          |        |
| Thread size         | Clamping range | Width across flats | Width across corners                      | Thread length | Total length | Colour | Lot size | Product Type      | Art. No. | Weight |
| M12                 | 1-6 mm         | 16 mm              | 18 mm                                     | 9 mm          | 29 to 34 mm  | Black  | 50       | 8161/7-M12-0601   | 239154   | 7 g    |
| Product Description |                |                    | Cable gland With reduction sealing insert |               |              |        |          |                   |          |        |
| Ambient temperature |                |                    | 15 °C ... +65 °C                          |               |              |        |          |                   |          |        |
| Variant             |                |                    | Standard thread                           |               |              |        |          |                   |          |        |
| Ex version          |                |                    | Ex i                                      |               |              |        |          |                   |          |        |
| Thread size         | Clamping range | Width across flats | Width across corners                      | Thread length | Total length | Colour | Lot size | Product Type      | Art. No. | Weight |
| M12                 | 1-6 mm         | 16 mm              | 18 mm                                     | 9 mm          | 29 to 34 mm  | Blue   | 50       | 8161/8-M12-0601   | 239162   | 7 g    |

Lot size: Purchase order quantity in [no. of units]; the delivery quantity is automatically rounded to the lot size.

| Technical Data                  |  |                        |
|---------------------------------|--|------------------------|
| Variant                         | 8161/-M.-....                                      | 8161/-M.-....-LT       |
| Explosion Protection            |  |                        |
| IECEX gas explosion protection  | Ex eb IIC Gb                                       | Ex eb IIC Gb           |
| IECEX dust explosion protection | Ex tb IIIC Db                                      | Ex tb IIIC Db          |
| ATEX gas explosion protection   | Ⓜ II 2 G Ex eb IIC Gb                              | Ⓜ II 2 G Ex eb IIC Gb  |
| ATEX dust explosion protection  | Ⓜ II 2 D Ex tb IIIC Db                             | Ⓜ II 2 D Ex tb IIIC Db |
| Certificates                    | ATEX (PTB), Brazil (ULB), IECEX (PTB), Korea (KGS) |                        |
| Declaration of Conformity       | ATEX (EUK)   |                        |

| Technical Data            |   |   |
|---------------------------|---|---|
| Variant                   | 8161/-M.-.....  | 8161/-M.-.....-LT   |
| Mechanical Data           |   |   |
| Material                  | Polyamide   | Polyamide   |
| Material                  | Polyamide, Glass fibre reinforced                               | Polyamide, Glass fibre reinforced                               |
| Degree of protection (IP) | IP66  | IP66  |
| Degree of protection note | IP68 at 5 bar 30 min. (IP protection according to IEC/EN 60529) | IP68 at 5 bar 30 min. (IP protection according to IEC/EN 60529) |
| Sealing material          | EPDM profile seal   | SI profile seal   |
| Silicone-free             | Yes   | No  |
| Self-extinguishing        | Yes   | Yes   |
| Flame-retardant           | Yes   | Yes   |
| Halogen-free              | Yes   | Yes   |
| Surface resistance        | $\leq 10^{13} \Omega$   | $\leq 10^{13} \Omega$   |

| Accessories   |   |               |          |         |
|---|---|---------------|----------|---------|
| Figure  | Description                                       |               | Art. No. | Weight  |
| Jam nut, nickel-plated brass  |   |               |          |         |
|   | Material: Nickel-plated brass<br>Thread size: M12 | Lot size: 100 | 241518   | 220 g   |
|   | Material: Nickel-plated brass<br>Thread size: M16 | Lot size: 100 | 241519   | 290 g   |
|   | Material: Nickel-plated brass<br>Thread size: M20 | Lot size: 100 | 241520   | 480 g   |
|   | Material: Nickel-plated brass<br>Thread size: M25 | Lot size: 100 | 241561   | 720 g   |
|   | Material: Nickel-plated brass<br>Thread size: M32 | Lot size: 50  | 241562   | 545 g   |
|   | Material: Nickel-plated brass<br>Thread size: M40 | Lot size: 50  | 241563   | 1.03 kg |
|   | Material: Nickel-plated brass<br>Thread size: M50 | Lot size: 25  | 241564   | 680 g   |
|   | Material: Nickel-plated brass<br>Thread size: M63 | Lot size: 10  | 241565   | 499 g   |
| Jam nut, plastic (-40 to +75 °C)<br>For mounting the cable entries in through holes |   |               |          |         |
|   | Material: Polyamide<br>Thread size: M12           | Lot size: 100 | 239460   | 1 g     |
|   | Material: Polyamide<br>Thread size: M16           | Lot size: 100 | 239461   | 2 g     |
|   | Material: Polyamide<br>Thread size: M20           | Lot size: 100 | 239462   | 2 g     |
|   | Material: Polyamide<br>Thread size: M25           | Lot size: 100 | 239463   | 3 g     |
|   | Material: Polyamide<br>Thread size: M40           | Lot size: 50  | 239465   | 7 g     |
|   | Material: Polyamide<br>Thread size: M50           | Lot size: 25  | 239466   | 12 g    |
|   | Material: Polyamide<br>Thread size: M63           | Lot size: 10  | 239467   | 18 g    |

**Accessories**

| Figure   | Description   | Art. No.          | Weight       |
|--|---|-------------------|--------------|
| <b>Reduction sealing insert (standard), EPDM (-40 to +75 °C)</b> |   |                   |              |
| <b>For cable glands</b>  |   |                   |              |
|  | Connection thread: M16 x 1.5<br>Clamping range: 2 to 6 mm     | Batch size: 50    | 239445 1 g   |
|  | Connection thread: M20 x 1.5<br>Clamping range: 4 to 8 mm     | Batch size: 50    | 239446 1 g   |
|  | Connection thread: M25 x 1.5<br>Clamping range: 7 to 12 mm    | Batch size: 25    | 239447 3 g   |
|  | Connection thread: M32 x 1.5<br>Clamping range: 9 to 14 mm    | Batch size: 25    | 239448 3 g   |
|  | Connection thread: M40 x 1.5<br>Clamping range: 12 to 20 mm   | Batch size: 10    | 239449 7 g   |
| <b>Reduction sealing insert, silicone (-60 to +75 °C)</b>        |   |                   |              |
| <b>For low temperatures</b>                                      |   |                   |              |
|  | Connection thread: M16 x 1.5<br>Cable dia. range: 2 to 6 mm   | Lot size: 50      | 239453 1 g   |
|  | Connection thread: M20 x 1.5<br>Cable dia. range: 4 to 8 mm   | Lot size: 50      | 239454 1 g   |
|  | Connection thread: M25 x 1.5<br>Cable dia. range: 7 to 12 mm  | Lot size: 25      | 239455 2 g   |
|  | Connection thread: M32 x 1.5<br>Cable dia. range: 9 to 14 mm  | Lot size: 25      | 239456 3 g   |
|  | Connection thread: M40 x 1.5<br>Cable dia. range: 12 to 20 mm | Lot size: 10      | 239457 8 g   |
|  | Connection thread: M50 x 1.5<br>Cable dia. range: 16 to 25 mm | Lot size: 10      | 239458 15 g  |
| <b>Special key</b>   |   |                   |              |
|  | Thread size: M20  | Packaging unit: 1 | 114208 132 g |
|  | Thread size: M25  | Packaging unit: 1 | 114205 163 g |
| <b>Special key</b>   |   |                   |              |
| <b>For tightening cable glands and cap nuts</b>                  |   |                   |              |
|  | Thread size: M16  | Packaging unit: 1 | 114207 120 g |
|  | Thread size: M32  | Packaging unit: 1 | 114209 237 g |
|  | Thread size: M40  | Packaging unit: 1 | 114210 274 g |
| <b>Plug (-60 to +75 °C; depending on the cable gland used)</b>   |   |                   |              |
| <b>For sealing unused cable glands</b>                           |   |                   |              |
| <b>Material: Polyamide</b>                                       |   |                   |              |
|  | Diameter: 3 mm  | Lot size: 50      | 240044 1 g   |
|  | Diameter: 6 mm  | Lot size: 50      | 240046 1 g   |
|  | Diameter: 8 mm  | Lot size: 50      | 240048 1 g   |
|  | Diameter: 12 mm   | Lot size: 50      | 240049 2 g   |
|  | Diameter: 17 mm   | Lot size: 50      | 240056 3 g   |
|  | Diameter: 14 mm   | Lot size: 50      | 240050 3 g   |
|  | Diameter: 20 mm   | Lot size: 25      | 240057 4 g   |
|  | Diameter: 28 mm   | Lot size: 25      | 240059 9 g   |
|  | Diameter: 25 mm   | Lot size: 25      | 240058 7 g   |
|  | Diameter: 35 mm   | Lot size: 10      | 240060 10 g  |
|  | Diameter: 48 mm   | Lot size: 10      | 240062 28 g  |



## Spare Parts

| Figure  | Description  |               | Art. No. | Weight |
|---|--|---------------|----------|--------|
| Flat seal (standard), EPDM (-40 to +75 °C)              |  |               |          |        |
| Replacement seals for cable glands                      |  |               |          |        |
|   | For cable glands 8161/-M12-06...<br>Connection thread: M12 x 1.5 | Lot size: 100 | 240245   | 1 g    |
|   | For cable glands 8161/-M12-06..<br>Connection thread: M12 x 1.5  | Lot size: 50  | 240244   | 1 g    |
|   | For cable glands 8161/-M16-09..<br>Connection thread: M16        | Lot size: 100 | 222370   | 1 g    |
|   | For cable glands 8161/-M16-09...<br>Connection thread: M16       | Lot size: 50  | 222363   | 1 g    |
|   | For cable glands 8161/-M20-13<br>Connection thread: M20          | Lot size: 100 | 222371   | 1 g    |
|   | For cable glands 8161/-M20-13<br>Connection thread: M20          | Lot size: 50  | 222364   | 1 g    |
|   | For cable glands 8161/-M25-17<br>Connection thread: M25          | Lot size: 100 | 222372   | 1 g    |
|   | For cable glands 8161/-M25-17<br>Connection thread: M25          | Lot size: 50  | 222365   | 1 g    |
|   | For cable glands 8161/-M32-21<br>Connection thread: M32          | Lot size: 100 | 222373   | 1 g    |
|   | For cable glands 8161/-M32-21<br>Connection thread: M32          | Lot size: 50  | 222366   | 1 g    |
|   | For cable glands 8161/-M40-28<br>Connection thread: M40          | Lot size: 100 | 222374   | 2 g    |
|   | For cable glands 8161/-M40-28<br>Connection thread: M40          | Lot size: 50  | 222367   | 2 g    |
|   | For cable glands 8161/-M50-35<br>Connection thread: M50          | Lot size: 100 | 222375   | 2 g    |
|   | For cable glands 8161/-M50-35<br>Connection thread: M50          | Lot size: 50  | 222368   | 2 g    |
|   | For cable glands 8161/-M63-48<br>Connection thread: M63          | Lot size: 100 | 222376   | 2 g    |
| For cable glands 8161/-M63-48<br>Connection thread: M63 | Lot size: 50   | 222369        | 2 g      |        |
| Silicone flat seal (-60 to +75 °C)                      |  |               |          |        |
| Replacement seals for low temperatures                  |  |               |          |        |
|   | For cable glands 8161/-M16-09..<br>Connection thread: M16        | Lot size: 100 | 240248   | 1 g    |
|   | For cable glands 8161/-M20-13<br>Connection thread: M20          | Lot size: 100 | 240249   | 1 g    |
|   | For cable glands 8161/-M25-17<br>Connection thread: M25          | Lot size: 100 | 240250   | 1 g    |
|   | For cable glands 8161/-M32-21<br>Connection thread: M32          | Lot size: 100 | 240251   | 1 g    |
|   | For cable glands 8161/-M40-28<br>Connection thread: M40          | Lot size: 100 | 240252   | 2 g    |
|   | For cable glands 8161/-M50-35<br>Connection thread: M50          | Lot size: 100 | 240253   | 2 g    |
|   | For cable glands 8161/-M63-48<br>Connection thread: M63          | Lot size: 100 | 240254   | 2 g    |

Lot size: Purchase order quantity in [no. of units]; the delivery quantity is automatically rounded to the lot size.

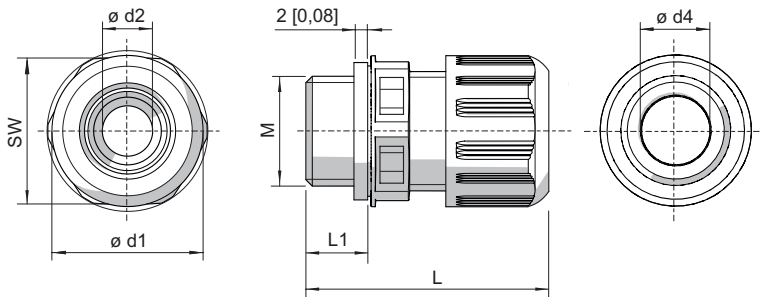

M = Thread size SW = Width across flats  
 L1 = Thread length L = Total length

**Cable glands without bend protection**

| Thread size | Width across flats | Total length | Total length (with long thread) | Thread length | Thread length (long thread) | Clamping range | Clamping range + reduction sealing insert | Dimension d1 | Dimension d2 | Dimension d4 |
|-------------|--------------------|--------------|---------------------------------|---------------|-----------------------------|----------------|---|--------------|--------------|--------------|
| M12         | 16.00 mm           | 29 to 34 mm  | 35 to 40 mm                     | 9 mm          | 15 mm                       | 3-6 mm         | 1-6 mm                                    | 18 mm        | 7.3 mm       | 6.3 mm       |
| M16         | 20.00 mm           | 31 to 37 mm  | 37 to 43 mm                     | 9 mm          | 15 mm                       | 5-9 mm         | 2-9 mm                                    | 22 mm        | 10.3 mm      | 9.3 mm       |
| M20         | 24.00 mm           | 36 to 43 mm  | 41 to 48 mm                     | 10 mm         | 15 mm                       | 7-13 mm        | 4-13 mm                                   | 27 mm        | 13.3 mm      | 13.3 mm      |
| M25         | 29.00 mm           | 38 to 46 mm  | 43 to 51 mm                     | 10 mm         | 15 mm                       | 10-17 mm       | 7-17 mm                                   | 32 mm        | 17.3 mm      | 17.3 mm      |
| M32         | 36.00 mm           | 42 to 50 mm  | 45 to 53 mm                     | 12 mm         | 15 mm                       | 13-21 mm       | 9-21 mm                                   | 40 mm        | 21.3 mm      | 21.3 mm      |
| M40         | 46.00 mm           | 52 to 65 mm  | 58 to 71 mm                     | 12 mm         | 18 mm                       | 17-28 mm       | 12-28 mm                                  | 51 mm        | 28.3 mm      | 30 mm        |
| M50         | 55.00 mm           | 59 to 72 mm  | 63 to 76 mm                     | 14 mm         | 18 mm                       | 23-35 mm       | 16-35 mm                                  | 61 mm        | 35.3 mm      | 40 mm        |
| M63         | 68.00 mm           | 64 to 78 mm  | 67 to 81 mm                     | 15 mm         | 18 mm                       | 34-48 mm       | 28-48 mm                                  | 75 mm        | 48.3 mm      | 53 mm        |