

- Enclosure with Ex d type of protection
- With miniature circuit breaker, tripping characteristic C
- With residual current circuit breaker and overcurrent release, tripping characteristic B or C
- Advantage: Short delivery times

E8

MY R. STAHL 8264A



R. STAHL Series 8264/-ExV CUBEx lighting and heating circuit distribution boards are modular and are therefore available in a large number of standard variants which are ready for rapid delivery; further versions are available on request. They are lightweight, saltwater-resistant and suitable for a wide range of temperatures. The Ex d enclosures are wall-mounted using screws or rails.

	IECEX / ATEX					
Zone	0	1	2	20	21	22
Installation in		•	•		•	•

Selection Table						
Product Description Built-in unit 1		Circuit distribution board light With miniature circuit breaker 1 x Load and motor switch				
Layout No.	Built-in unit 2	Entry 1	Entry 2	Product Type	Art. No.	Weight
01	12 x Miniature circuit breaker 1-pole 16 A/C	1 x M50 x 1.5	12 x M20 x 1.5	8264/5-ExV-01-12L16C1P-D	143210	100 kg
02	24 x Miniature circuit breaker 1-pole 16 A/C	1 x M50 x 1.5	24 x M20 x 1.5	8264/5-ExV-02-24L16C1P-D	143212	156 kg
Product Description Built-in unit 1		Heating circuit distrib.boards With residual current circuit breaker With overcurrent release 1 x Load and motor switch				
Layout No.	Built-in unit 2	Entry 1	Entry 2	Product Type	Art. No.	Weight
01	12 x Residual current circuit breaker 1-pole 16 A+N/30 mA/ B	1 x M50 x 1.5	12 x M20 x 1.5	8264/5-ExV-01-12H16B1N-D	143214	100 kg
	12 x Residual current circuit breaker 1-pole 16 A+N/30 mA/ C	1 x M50 x 1.5	12 x M20 x 1.5	8264/5-ExV-01-12H16C1N-D	143217	100 kg
02	24 x Residual current circuit breaker 1-pole 16 A+N/30 mA/ B	1 x M50 x 1.5	24 x M20 x 1.5	8264/5-ExV-02-24H16B1N-D	143216	156 kg
	24 x Residual current circuit breaker 1-pole 16 A+N/30 mA/ C	1 x M50 x 1.5	24 x M20 x 1.5	8264/5-ExV-02-24H16C1N-D	143218	156 kg

Technical Data	
Explosion Protection	
IECEX gas explosion protection	Ex db IIB+H2 / IIB T6 / T4 Gb
IECEX dust explosion protection	Ex tb IIIC T95 °C / T130 °C Db
ATEX gas explosion protection	Ⓜ II 2 G Ex db IIB+H2 / IIB T6 / T4 Gb

Technical Data

Explosion Protection

ATEX dust explosion protection	Ⓔ II 2 D Ex tb IIIC T95 °C / T130 °C Db
IECEX gas explosion protection 2	Ex db IIB T4 Gb
IECEX dust explosion protection 2	Ex tb IIIC T130 °C Db
ATEX gas explosion protection 2	Ⓔ II 2 G Ex db IIB T4 Gb
ATEX dust explosion protection 2	Ⓔ II 2 D Ex tb IIIC T130 °C Db
Certificates	ATEX (DEK), Brazil (ULB), Canada / USA (UL), China (NEPSI), IECEX (DEK), India (PESO), Korea (KGS), Taiwan (ITRI)
Declaration of Conformity	ATEX (EUK), China (CCC)
Notes	Product label may vary. Series devices are labelled with ATEX and IECEX.

Electrical Data

Rated operational voltage AC	230 – 400 V
Notes	Depending on the terminal type and the explosion-protected components used

Ambient Conditions

Ambient temperature	-20 °C ... +40 °C (IIB+H2 T6) (T95 °C) -55 °C ... +60 °C (IIB T4) (T130 °C)
Notes	The ambient temperatures depend on the components used

Mechanical Data

Degree of protection (IP) (IEC 60529)	IP65
Impact strength (IEC 60079)	7 J
Enclosure material	Aluminium, Seawater-resistant
Material note	Also available in stainless steel

Technical Drawings – Subject to Alterations

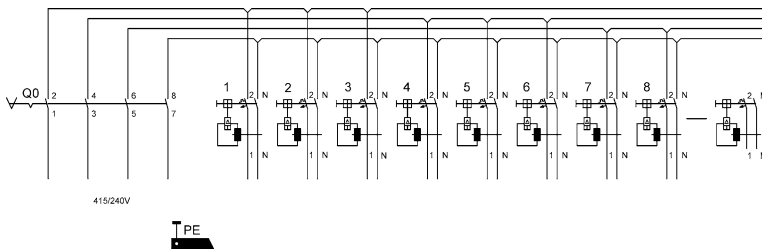

Circuit diagram
8146/5-ExV-...1N-D; 8264/5-ExV-...1N-D

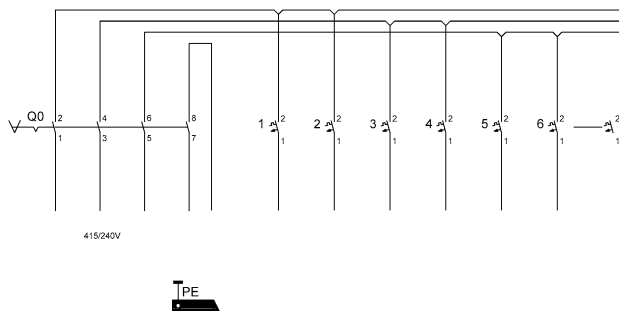

Circuit diagram
8146/5-ExV-...1P-D; 8264/5-ExV-...1P-D

Dimensional Drawings (All Dimensions in mm [inches]) – Subject to Alterations

E8

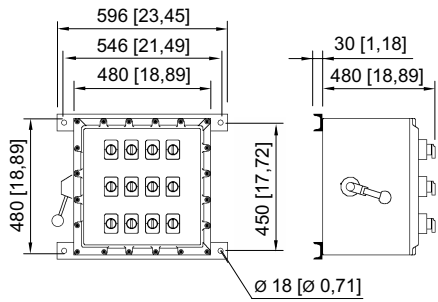

Layout 01

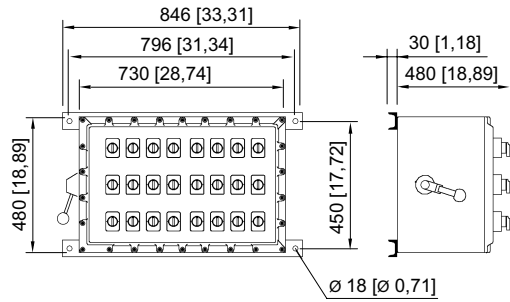

Layout 02