



- Ex e reducers made of glass fibre reinforced polyamide
- Wide selection of metric thread sizes

E10

MY R. STAHL ACC1L



The plastic Ex e reducers make it possible to easily adapt thread sizes. There is a wide selection of different versions available for this. They have global certification according to IECEx and ATEX.

	IECEx / ATEX					
Zone	0	1	2	20	21	22
Installation in		•	•		•	•

Selection Table							
Version	Metric / metric						
External thread	Internal thread	Thread length	Width across flats	Design	Impact strength (IEC 60079)	Art. No.	Weight
M20	M16	9 mm	24 mm	A	4 J	109385	9 g
M25	M20	10 mm	29 mm	B	7 J	109384	7 g
M32	M20	12 mm	36 mm	B	7 J	109383	14 g
	M25	12 mm	36 mm	B	7 J	109382	11 g
M40	M20	12 mm	46 mm	B	7 J	109381	21 g
	M25	12 mm	46 mm	B	7 J	109380	23 g
	M32	12 mm	46 mm	B	7 J	109379	19 g
M50	M20	14 mm	55 mm	B	7 J	109378	1 g
	M25	14 mm	55 mm	B	7 J	109377	1 g
	M32	14 mm	55 mm	B	7 J	109376	35 g
	M40	14 mm	55 mm	B	7 J	109375	24 g
M63	M20	15 mm	68 mm	B	7 J	109374	1 g
	M25	15 mm	68 mm	B	7 J	109373	1 g
	M32	15 mm	68 mm	B	7 J	109372	46 g
	M40	15 mm	68 mm	B	7 J	109371	46 g
	M50	15 mm	68 mm	B	7 J	109370	39 g

Technical Data	
Explosion Protection	
IECEx gas explosion protection	Ex eb IIC Gb
IECEx dust explosion protection	Ex tb IIIC Db

Technical Data	
Explosion Protection	
ATEX gas explosion protection	II 2 G Ex eb IIC Gb
ATEX dust explosion protection	II 2 D Ex tb IIIC Db
Ambient Conditions	
Ambient temperature	-40 °C ... +75 °C
Mechanical Data	
Degree of protection (IP)	IP66
Material	Polyamide
Material	Polyamide, Glass fibre reinforced
Silicone-free	Yes
Colour	Black

Dimensional Drawings (All Dimensions in mm [inches]) – Subject to Alterations

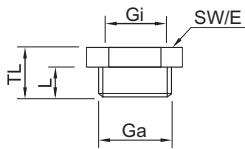

Design B

Ga = External thread Gi = Internal thread
 L = Thread length SW = Width across flats
 E = Width across corners TL = Length

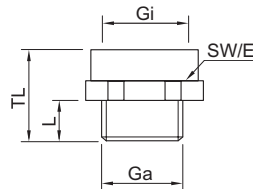

Design A

Ga = External thread Gi = Internal thread
 L = Thread length SW = Width across flats
 E = Width across corners TL = Length