

# EXLUX Linear Luminaire with LED

## Series 6402/4

STAHL



- State-of-the-art LED technology with high luminous efficacy and long service life
- Extremely high luminaire efficacy
- Luminous flux after 100,000 h still 90% of the starting luminous flux
- Optionally with DALI for controlling and monitoring the luminaire
- Optionally with address modules for directly actuation of a common battery system

E2

WebCode 6402C



The linear luminaire with Series 6402/4 LED is ideal for lighting surfaces at a mounting height of up to 10 m. It can also be used to illuminate equipment and objects, both inside and outside. The pole mounting sleeve accessory can be used to easily mount the luminaire on poles. Optionally, the luminaire can be equipped with an address module. It can be used to control and monitor the luminaire for the common battery systems.

	IECEX / ATEX					
Zone	0	1	2	20	21	22
Installation in			•		•	•

Selection Table									
Size	2								
Light distribution	120°x120°								
Lamp wattage	22 W								
Luminous flux	2550 lm								
Luminaire efficacy	116 lm/W								
Product variant	Translucent cover	Light colour	Disconnection of the luminaire	Diffuser	Drilled holes	Threaded plate	Product Type	Art. No.	Weight
standard	Translucent	5000 K – neutral white	No	Without diffuser	3 x M25	2x plastic	6402/4124-6100-152-1110-11-850S	285111	3.15 kg
		5000 K – neutral white	No	Without diffuser	3 x M20	2x SS430 stainless steel	6402/4124-6100-152-2220-22-850S	285113	3.25 kg
Size	2								
Light distribution	120°x120° with diffusing glass								
Lamp wattage	22 W								
Luminous flux	2910 lm								
Luminaire efficacy	132 lm/W								
Product variant	Translucent cover	Light colour	Disconnection of the luminaire	Diffuser	Drilled holes	Threaded plate	Product Type	Art. No.	Weight
Interfaces DALI	Clear	5000 K – neutral white	No	With diffuser	3 x M25	2x plastic	6402/4128-6110-172-1110-11-8500	270850	3.3 kg
standard	Clear	5000 K – neutral white	No	With diffuser	3 x M25	2x plastic	6402/4128-6100-152-1110-11-8500	267040	3.2 kg
		5000 K – neutral white	No	With diffuser	3 x M20	2x SS430 stainless steel	6402/4128-6100-152-2220-22-8500	271908	3.3 kg
with address module	Clear	5000 K – neutral white	No	With diffuser	3 x M25	2x plastic	6402/4128-6120-152-1110-11-8500	267039	3.3 kg

## Selection Table

Size		4							
Light distribution		120°x120°							
Lamp wattage		42 W							
Luminous flux		5100 lm							
Luminaire efficacy		121 lm/W							
Product variant	Translucent cover	Light colour	Disconnection of the luminaire	Diffuser	Drilled holes	Threaded plate	Product Type	Art. No.	Weight
standard	Translucent	5000 K – neutral white	No	Without diffuser	3 x M25	2x plastic	6402/4144-6100-152-1110-11-850S	285112	5.55 kg
		5000 K – neutral white	No	Without diffuser	3 x M20	2x SS430 stainless steel	6402/4144-6100-152-2220-22-850S	285114	5.55 kg
Size		4							
Light distribution		120°x120° with diffusing glass							
Lamp wattage		42 W							
Luminous flux		5810 lm							
Luminaire efficacy		138 lm/W							
Product variant	Translucent cover	Light colour	Disconnection of the luminaire	Diffuser	Drilled holes	Threaded plate	Product Type	Art. No.	Weight
Interfaces DALI	Clear	5000 K – neutral white	No	With diffuser	3 x M25	2x plastic	6402/4148-6110-172-1110-11-8500	271475	5.65 kg
standard	Clear	5000 K – neutral white	No	With diffuser	3 x M25	2x plastic	6402/4148-6100-152-1110-11-8500	267054	5.6 kg
		5000 K – neutral white	No	With diffuser	3 x M20	2x SS430 stainless steel	6402/4148-6100-152-2220-22-8500	267055	5.7 kg
with address module	Clear	5000 K – neutral white	No	With diffuser	3 x M25	2x plastic	6402/4148-6120-152-1110-11-8500	267057	5.6 kg
Size		6							
Light distribution		120°x120° with diffusing glass							
Lamp wattage		50 W							
Luminous flux		6960 lm							
Luminaire efficacy		139 lm/W							
Product variant	Translucent cover	Light colour	Disconnection of the luminaire	Diffuser	Drilled holes	Threaded plate	Product Type	Art. No.	Weight
standard	Clear	5000 K – neutral white	No	With diffuser	3 x M25	2x plastic	6402/4168-6200-152-1110-11-8500	276351	7 kg
		5000 K – neutral white	No	With diffuser	3 x M20	2x SS430 stainless steel	6402/4168-6200-152-2220-22-8500	276354	7 kg

### Variants with 2 x threaded plate plastic and 3 x drilled holes M25:

Cable glands 2 x M25 Ø 7 -17 mm and 2 x stopping plugs M 25 x 1,5 are included loose with the product (installation required). Threaded plate included.

### Variants with 2 x threaded plate stainless steel SS430 and 3 x drilled holes M20:

Cable glands and stopping plugs can be ordered as accessories. Threaded plate included.

The light fittings are supplied without mounting material.

## Technical Data





Variant	standard / product variant "-" without disconnection	Interfaces DALI	with address module
Explosion Protection			
IECEX gas explosion protection	Ex ec IIC T4 Gc	Ex ec IIC T4 Gc	Ex ec nC IIC T4 Gc
IECEX dust explosion protection	Ex tb op is / tc IIIC T100 °C Db	Ex tb op is / tc IIIC T100 °C Db	Ex tb op is / tc IIIC T100 °C Db
ATEX gas explosion protection	⊕ II 3 G Ex ec IIC T4 Gc	⊕ II 3 G Ex ec IIC T4 Gc	⊕ II 3 G Ex ec nC IIC T4 Gc
ATEX dust explosion protection	⊕ II 2 D Ex tb op is / tc IIIC T100 °C Db	⊕ II 2 D Ex tb op is / tc IIIC T100 °C Db	⊕ II 2 D Ex tb op is / tc IIIC T100 °C Db
Certificates	ATEX (IBE), IECEX (IBE)	ATEX (IBE), IECEX (IBE)	ATEX (IBE), IECEX (IBE)
Electrical Data			
Rated operational voltage AC	100 – 240 V	100 – 240 V	220 – 230 V
Frequency range	50 – 60 Hz	50 – 60 Hz	50 Hz
Rated operational voltage DC	110 – 250 V	110 – 250 V	194 – 250 V

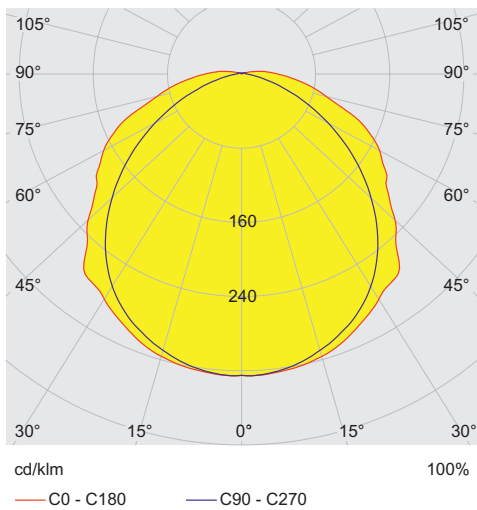

Technical Data			
Variant	standard / product variant "-"- without disconnection	Interfaces DALI	with address module
<b>Ambient Conditions</b>			
Ambient temperature	-40 °C ... +55 °C (T100 °C) Note: Through wiring Max. 3x16 A -40 °C ... +60 °C (T100 °C) Note: Through wiring 2 Max. 3x10 A	-40 °C ... +55 °C (T100 °C) Note: Through wiring Max. 3x16 A -40 °C ... +60 °C (T100 °C) Note: Through wiring 2 Max. 3x10 A	-30 °C ... +45 °C (T100 °C) Note: Through wiring Max. 3x16 A -30 °C ... +50 °C (T100 °C) Note: Through wiring 2 Max. 3x10 A
<b>Lighting Data</b>			
Number of lamps	1	1	1
Lamp	LED	LED	LED
Colour rendering	≥ 80	≥ 80	≥ 80
Colour temperature	5000 K	5000 K	5000 K
<b>Mechanical Data</b>			
IP degree of protection (IEC 60598)	IP66/IP67	IP66/IP67	IP66/IP67
Enclosure material	Polyester resin, Glass fibre reinforced	Polyester resin, Glass fibre reinforced	Polyester resin, Glass fibre reinforced
Sealing material	Silicone	Silicone	Silicone
Max. solid connection terminals	6 mm <sup>2</sup>	6 mm <sup>2</sup>	6 mm <sup>2</sup>
Max. finely stranded connection terminals	4 mm <sup>2</sup>	4 mm <sup>2</sup>	4 mm <sup>2</sup>
Type of connection cable	Finely stranded Solid	Finely stranded Solid	Finely stranded Solid
Impact strength (IEC 62262)	IK10	IK10	IK10
Enclosure colour	Light grey (RAL 7035)	Light grey (RAL 7035)	Light grey (RAL 7035)
Notes	Connection terminals: Spring clamp terminal (2 free clamping units per pole)		
<b>Components</b>			
Cable entry material	Polyamide, black	Polyamide, black	Polyamide, black
Stopping plug material	Polyamide, black	Polyamide, black	Polyamide, black
Address module			UNI Modul ADR 20-ILS-Z2
Ballast	VG Luxtronic 40 W 300 mA	VG Luxtronic 40 W 300 mA	VG Luxtronic 40 W 300 mA
Through wiring	With 5 conductors 2.5 mm <sup>2</sup>	With 7 conductors 2.5 mm <sup>2</sup>	With 5 conductors 2.5 mm <sup>2</sup>

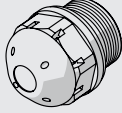
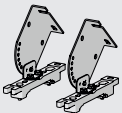
### Light Distribution Curves – Subject to Alterations

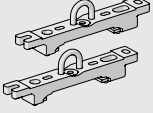
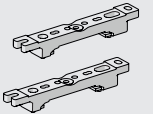
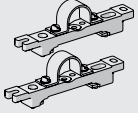

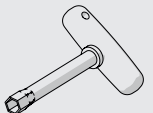
typical with diffuser, clear translucent cover

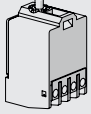
Accessories			
Figure	Description	Art. No.	Weight
<b>Breather</b>			
	Thread: M25 x 1.5; 20 pc; without counter nut	285780	200 g
	Thread: M25 x 1.5; 1 pc; for installation in lights; in moulded material; without counter nut	138573	10 g
<b>Ceiling and wall mounting bracket</b>			
	mounted on a mounting rail for a variable mounting distance; Material: stainless steel; Lamp can be swiveled in steps of 15°; 1 pair	222827	1.2 kg
<b>Cover</b>			
	for luminaire size 2 (diffuse), the visibility of the indicator LED may be restricted when used on a single supplied emergency luminaire	276669	1 kg
	for luminaire size 4 (diffuse), the visibility of the indicator LED may be restricted when used on a single supplied emergency luminaire	276670	1.2 kg
<b>Mounting bracket</b>			
	mounting clamp mounted on a mounting rail for a variable mounting distance; 1 pair	222456	400 g
<b>Mounting rail</b>			
	for a variable mounting distance; 1 pair	222826	350 g
<b>Pipe clamp</b>			
	R 1 1/2"; with mounting rail for a variable mounting distance; material: stainless steel; 1 pair	222459	700 g
	R 1 1/4"; with mounting rail for a variable mounting distance; Material: stainless steel; 1 pair	222458	700 g
	R 2"; with mounting rail for a variable mounting distance; Material: stainless steel; 1 pair	222460	750 g
<b>Pole mounting sleeve</b>			
	for the subsequent mounting on lights size 2 and size 4, completely with assembly parts (for pipe diameter 42 mm)	227512	3.2 kg
<b>Ring bolt</b>			
	M8, direct mounting in insert nuts; 1 pair	115736	115 g
<b>Socket key</b>			
	M8 / wrench size 13; to open/close the central locking	222430	110 g

Spare Parts			
Figure	Description	Art. No.	Weight
<b>Contact element</b>			
	8080/1-3-L 2 NC contact element	132527	26 g
<b>Cover</b>			
	for luminaire size 4	222428	1.15 kg
	for luminaire size 6	222429	1.45 kg
	for luminaire size 2	222427	639 g

**Dimensional Drawings (All Dimensions in mm [inches]) – Subject to Alterations**

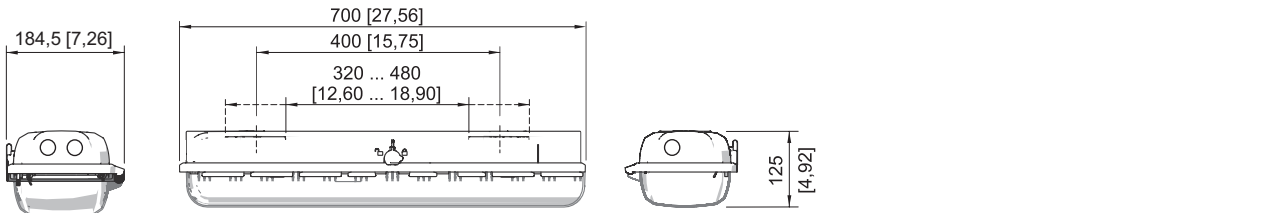

Size 2

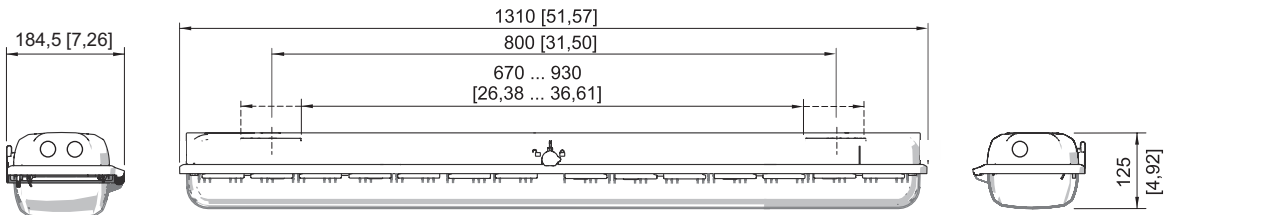

Size 4

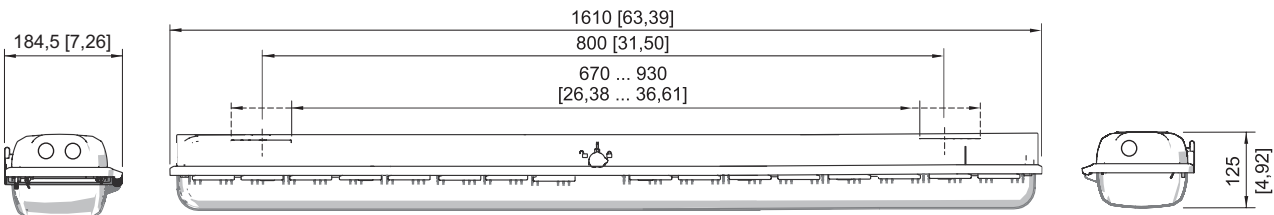

Size 6

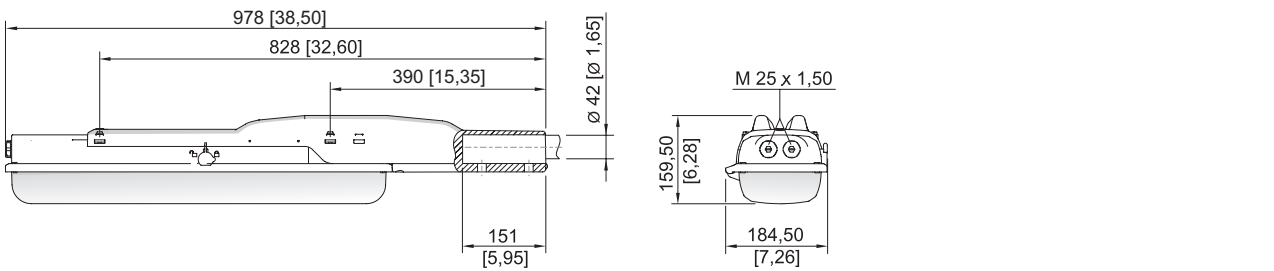

Size 2

E2

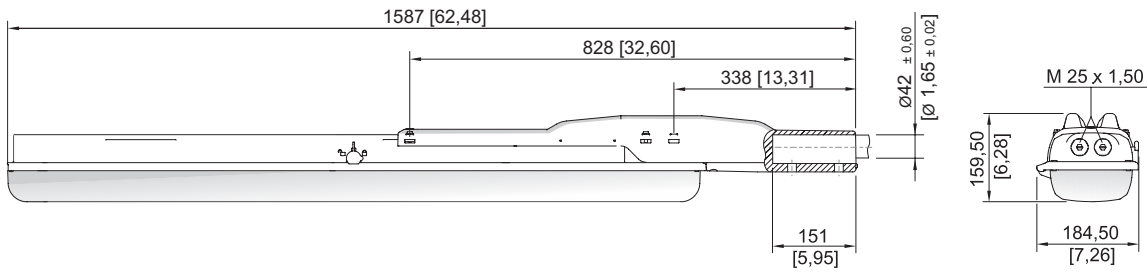

Size 4

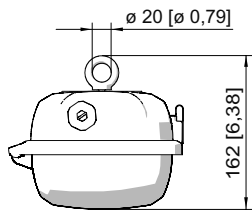

Ring bolt fitted in insert nut of the luminaire

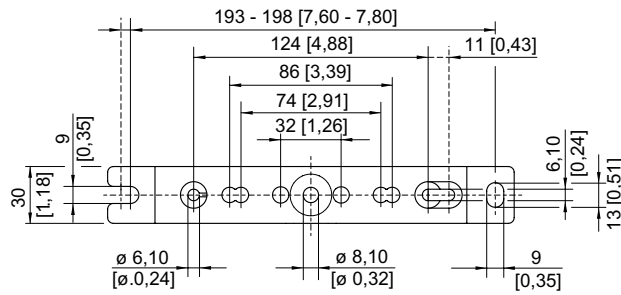
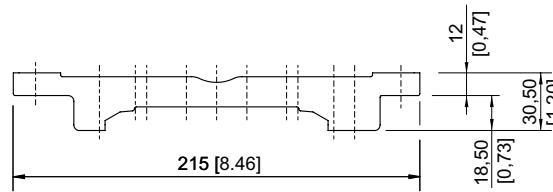

Mounting rail

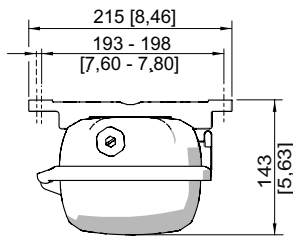

Mounting rail

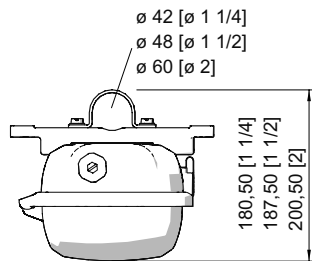

Pipe clamp fitted in mounting rail

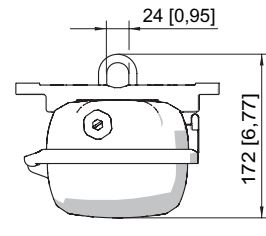

Mounting bracket fitted in mounting rail

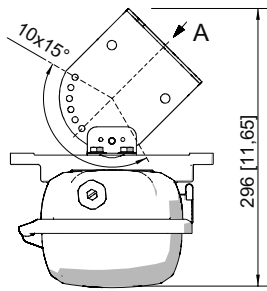

A

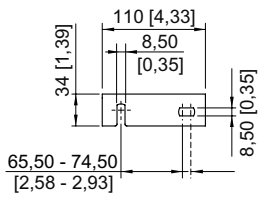

Wall mounting bracket fitted in mounting rail