

Control and signalling devices

Control device system Series ConSig 8040

LED indicator lamp and twin pushbutton

8040/12E8X-54C01SA70-23D08SA05 Art. No. 287014



ConSig



- Quad certified control stations (NEC®, CE Code, ATEX, IECEx)
- Lightweight enclosure made of glass fibre reinforced polyester (FRP), excellent for corrosive atmospheres
- Offers a variety of pushbuttons, illuminated pushbuttons, control switches and LEDs for different configurations
- Customisable control stations available upon request with different entry, contact options and additional certifications

MY R. STAHL 8040E



R. STAHL's series 8040 NEC® / CE Code control stations utilize explosion-protected components with non-metallic enclosures for the ultimate flexibility, safety and durability in hazardous and hostile locations. Choose from one of the standard versions or contact us for a customised solution.

Technical Data

Explosion Protection

| | |
|---------------------------------|--------------------------------------------------------------------------------------------------------------------------------------|
| Area of application | European Union (ATEX) Canada IECEx USA |
| Application range (zones) | 1, 2, 21, 22 |
| IECEx gas certificate | IECEx PTB 06.0025 |
| IECEx gas explosion protection | Ex db eb IIC T6 Gb |
| IECEx dust certificate | PTB 01 ATEX 1105 |
| IECEx dust explosion protection | Ex tb IIIC T80 °C Db |
| ATEX gas certificate | PTB 01 ATEX 1105 |
| ATEX gas explosion protection | ⊕ II 2 G Ex db eb IIC T6 Gb |
| ATEX dust certificate | PTB 01 ATEX 1105 |
| ATEX dust explosion protection | ⊕ II 2 D Ex tb IIIC T80 °C Db |
| Certificate ULus | E182378V1S5 |
| Marking ULus | Class I, Div. 2, Groups A,B,C,D Class II, III, Div. 2, Groups F,G Class I, Zone 1, AEx db eb IIC T6 Enclosure Type 3, 4, 4X |
| Certificate cUL | E182378V1S5 |
| Marking cUL | Ex db eb IIC T6 Class I, Div. 2, Groups A,B,C,D Class II, III, Div. 2, Groups F,G Enclosure Type 3, 4, 4X |
| Certificates | ATEX (PTB), Brazil (ULB), Canada (UL), China (NEPSI), IECEx (PTB), India (PESO), Korea (KGS), Taiwan (ITRI), USA (UL) |
| Ship approval | DNVGL |
| Notes | Product label for standard configurations as NEC®, CE Code, ATEX, and IECEx. For additional certifications, contact factory. |

Electrical Data

| | |
|------------------------------|-------|
| AC rated operational voltage | 690 V |
|------------------------------|-------|

Control and signalling devices

Control device system Series ConSig 8040

LED indicator lamp and twin pushbutton

8040/12E8X-54C01SA70-23D08SA05 Art. No. 287014



Electrical Data

| | |
|---------------------------|------|
| Rated operational current | 10 A |
|---------------------------|------|

Ambient Conditions

| | |
|---------------------|--------------------|
| Ambient temperature | -50 °C ... 40 °C |
| Ambient temperature | -58 °F ... +104 °F |

Mechanical Data

| | |
|----------------------------------------------|------------------------------------------------|
| Degree of protection IP (IEC 60529) | IP66 |
| Enclosure type (UL50 & UL50E) | 3, 4, 4X |
| Enclosure material | Polyester resin, Glass fibre reinforced |
| Enclosure colour | Dark grey |
| Silicone-free | No |
| Clamping range AWG | 14 AWG |
| Connection cross-section max. | 2.5 mm ² |
| Solid connection cross section | 0.32 – 2.5 mm ² |
| Connection cross-section AWG single stranded | 22 AWG ... 14 AWG |
| Finely stranded connection cross section | 0.32 – 2.5 mm ² |
| Finely stranded connection cross-section AWG | 22 AWG ... 14 AWG |
| Cover fixing type | With captive screws, M4 stainless steel screws |
| Width | 80 mm |
| Width, inches | 3.15 in |
| Height | 139 mm |
| Height in inches | 5.47 in |
| Depth | 72 mm |
| Depth in inches | 2.76 in |
| Seal | Silicone, foamed |
| Weight | 900 g |

Mounting / Installation

| | |
|-------------------------------------------|-------------|
| Tightening torque of cover screw 1 | 1.4 N · m |
| Tightening torque of cover screw 1 lbf in | 12.4 lbf in |

Components

| | |
|------------------------------|-----------------------------------------------------------------|
| Installation position top | Indicator lamp bezel, Red, With silicone seal |
| Built-in element top | LED indicator lamp |
| Installation position bottom | Twin pushbutton, "STOP"/red – "START"/green, With silicone seal |
| Built-in element bottom | Contact element NC/NO |
| Flange and plates | Metal plate, bottom |
| Cable glands and entries | NPT 3/4 |
| Entry type | CMP |
| Entry 1 type | Metal adaptor |
| Entry 1 | NPT 3/4" |
| Metal entry possible 1 | Yes |

Control and signalling devices



Control device system Series ConSig 8040

LED indicator lamp and twin pushbutton

8040/12E8X-54C01SA70-23D08SA05 Art. No. 287014

Technical Drawings – Subject to Alterations

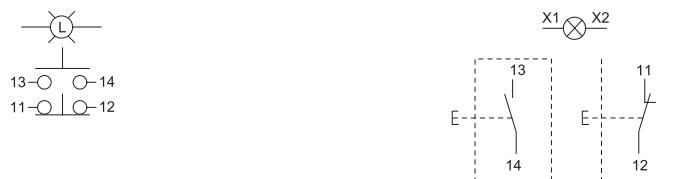

Dimensional Drawings (All Dimensions in mm [inches]) – Subject to Alterations

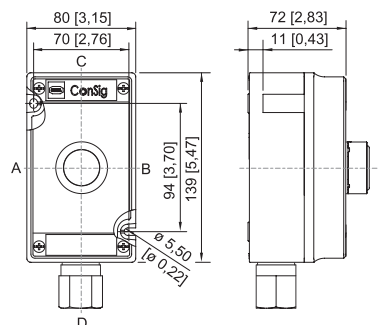

ConSig 8040/12 NEC

Accessories

Indicator lamp bezel

| | | |
|--|---------------------------------------------------------------------------------|-----------------------------------|
| | <p>BG054</p> <p>Diameter 39 mm All colours Silicone-free: No</p> | <p>Art. No. 223123</p> |
|--|---------------------------------------------------------------------------------|-----------------------------------|

Twin pushbutton

| | | |
|--|---------------------------------------------------------------------------------|-----------------------------------|
| | <p>BG023</p> <p>Black Front panel mounting Silicone-free: No</p> | <p>Art. No. 244639</p> |
|--|---------------------------------------------------------------------------------|-----------------------------------|

Spare Parts

Caps for BG054

| | | |
|--|-------------------------------------------------|-----------------------------------|
| | <p>for indicator lamp, all colours packaged</p> | <p>Art. No. 248685</p> |
|--|-------------------------------------------------|-----------------------------------|

Designation plates set for BG001, BG023

| | | |
|--|--------------------------------------------------------------------------------------------------------------------------------------------------------------------------------------------------------------------------|-----------------------------------|
| | <p>The button label set contains nine labels 6x blank disc without text in red, green, white, blue, yellow and black 1x red label, text: STOP 1x green label, text: START 1x blue label, text: RESET</p> | <p>Art. No. 321791</p> |
|--|--------------------------------------------------------------------------------------------------------------------------------------------------------------------------------------------------------------------------|-----------------------------------|





Control and signalling devices

Control device system Series ConSig 8040

LED indicator lamp and twin pushbutton

8040/12E8X-54C01SA70-23D08SA05 Art. No. 287014

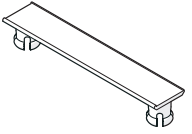

| Label holder | | Art. No. |
|------------------------------------------------------------------------------------|----------------------------------------------------------------------------------------|----------|
|  | Size 1, without insert disc, 1-line label for actuators Ø 39 | 223566 |
|  | Size 2, without insert disc, 1- or 2-line label for actuators Ø 39 | 223567 |
|  | Size 3, without insert disc, 1-, 2- or 3-line label for actuators Ø 39 | 223568 |
| Special key | | Art. No. |
|  | for tightening plastic locking nut | 169101 |
| Tag label | | Art. No. |
|  | plain for attaching to enclosure 8040; moulded material; with paper insert strip | 130673 |

We reserve the right to make alterations to the technical data, dimensions, weights, designs and products available without notice. The illustrations cannot be considered binding.