

8040/1395-C2462 Art. No. 288552



- Quad certified control stations (NEC®, CE Code, ATEX, IECEX)
- Lightweight enclosure made of glass fibre reinforced polyester (FRP), excellent for corrosive atmospheres
- Offers a variety of pushbuttons, illuminated pushbuttons, control switches and LEDs for different configurations
- Customisable control stations available upon request with different entry, contact options and additional certifications

### MY R. STAHL 8040E



R. STAHL's series 8040 NEC® / CE Code control stations utilize explosion-protected components with non-metallic enclosures for the ultimate flexibility, safety and durability in hazardous and hostile locations. Choose from one of the standard versions or contact us for a customised solution.

## Technical Data

### Explosion Protection

Area of application	Canada USA
Application range (zones)	1, 2, 21, 22
Certificate ULus	E182378V1S5
Marking ULus	Class I, Div. 2, Groups A,B,C,D Class II, III, Div. 2, Groups F,G Class I, Zone 1, AEx db eb IIC T6 Enclosure Type 3, 4, 4X
Certificate cUL	E182378V1S5
Marking cUL	Ex db eb IIC T6 Class I, Div. 2, Groups A,B,C,D Class II, III, Div. 2, Groups F,G Enclosure Type 3, 4, 4X
Certificates	Canada (UL), USA (UL)
Notes	Product label for standard configurations as NEC® and CE Code. For additional certifications, contact factory.

### Electrical Data

AC rated operational voltage	690 V
------------------------------	-------

### Ambient Conditions

Ambient temperature	-50 °C ... 40 °C
Ambient temperature	-58 °F ... +104 °F

### Mechanical Data

Degree of protection IP (IEC 60529)	IP66
Enclosure type (UL50 & UL50E)	3, 4, 4X
Enclosure material	Polyester resin, Glass fibre reinforced
Enclosure colour	Dark grey
Silicone-free	No
Connection cross-section max.	2.5 mm <sup>2</sup>
Solid connection cross section	0.32 – 2.5 mm <sup>2</sup>

8040/1395-C2462 Art. No. 288552

### Mechanical Data

Connection cross-section AWG single stranded	22 AWG ... 14 AWG
Finely stranded connection cross section	0.32 – 2.5 mm <sup>2</sup>
Finely stranded connection cross-section AWG	22 AWG ... 14 AWG
Cover fixing type	With captive screws, M4 stainless steel screws
Width	80 mm
Width, inches	3.15 in
Height	185 mm
Height in inches	7.28 in
Depth	72 mm
Depth in inches	2.76 in
Seal	Silicone, foamed
Weight	1.02 kg

### Mounting / Installation

Tightening torque of cover screw 1	1.4 N · m
Tightening torque of cover screw 1 lbf in	12.4 lbf in

### Components

Installation position top	Large handle, 0/OFF-I/ON (1x 90°), With silicone seal
Built-in element top	Control switch 002
No. poles on top built-in el.	2
Installation position bottom	LED illuminated pushbutton, Blue, With silicone seal
Built-in element bottom	Contact element NO/LED/NO
Flange and plates	Metal flange, Top and bottom
Entry 1 type	Threaded hole
Entry 1	M20 x 1.5
Metal entry possible 1	Yes

### Dimensional Drawings (All Dimensions in mm [inches]) – Subject to Alterations

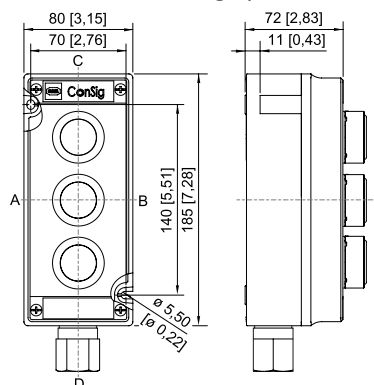

ConSig 8040/13E

8040/1395-C2462 Art. No. 288552

---

**Spare Parts**

---

**Tag label**

**Art. No.**

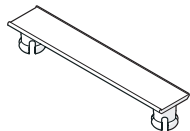

plain  
for attaching to enclosure 8040; moulded material;  
with paper insert strip

130673

---

We reserve the right to make alterations to the technical data, dimensions, weights, designs and products available without notice. The illustrations cannot be considered binding.