

Control and signalling devices

Control devices for panel mounting

Ex e

8003/111 UL Art. No. 127158



PanSiG



- Flexible configuration thanks to pushbutton, mushroom push-button, mushroom stay-put button, mushroom stay-put button with key lock, key-operated button and key-operated switch
- Easy to install using a single hole
- Codable "latching", "spring return" and "key not removable" functions
- Spring clamp terminals with connection chamber

MY R. STAHL 8003A



R. STAHL Series 8003 switches and control buttons for panel mounting take on various switching functions in latching and spring return positions up to 6 A, which can be subsequently recoded. They are fully certified, explosion-protected equipment with an Ex e connection chamber. With the patented mounting mechanism, panel mounting with drilled holes or openings of 30.5 mm is quick and easy.

Compatible actuators are available for a comprehensive range of applications.

Technical Data

Explosion Protection

| | |
|---------------------------------|---|
| Area of application | European Union (ATEX) CE Code IECEX NEC® |
| Application range (zones) | 1, 2, 21, 22 |
| IECEX gas certificate | IECEX PTB 06.0065X |
| IECEX gas explosion protection | Ex db eb IIC T6 Gb |
| IECEX dust certificate | IECEX PTB 06.0065X |
| IECEX dust explosion protection | Ex tb IIIC T80 °C Db |
| ATEX gas certificate | PTB 02 ATEX 1057 X |
| ATEX gas explosion protection | ⊕ II 2 G Ex db eb IIC T6 Gb |
| ATEX dust certificate | PTB 02 ATEX 1057 X |
| ATEX dust explosion protection | ⊕ II 2 D Ex tb IIIC T80 °C Db |
| Certificates | ATEX (PTB), Canada (UL), China (CQST), IECEX (PTB), Korea (KGS), USA (UL) |
| Declaration of conformity | ATEX (EUK), ATEX (Simple apparatus), China (CCC) |
| Notes | Product label may vary. Series devices are labelled with ATEX, IECEX, NEC® and CE Code. |

Electrical Data

| | |
|--|----------------------------|
| AC rated operational voltage | 500 V |
| Rated operational current | 6 A |
| Rated operational current | 6 A |
| Switching capacity AC-12 | 500 V / 6 A / max. 3000 VA |
| Switching capacity AC-15 | 400 V / 6 A / max. 1250 VA |
| Switching capacity DC-13 | 110 V / 1 A / max. 110 W |
| Switching capacity DC-13 2 contact elements in series | 60 V/6 A |

Control and signalling devices

Control devices for panel mounting



Ex e

8003/111 UL Art. No. 127158

Ambient Conditions

| | |
|--------------------------|--------------------|
| Ambient temperature | -20 °C ... 60 °C |
| Ambient temperature | -4 °F ... +140 °F |
| Ambient temperature NEC® | -30 °C ... +60 °C |
| Ambient temperature NEC® | -22 °F ... +140 °F |

Mechanical Data

| | |
|---------------------------------------|----------------------------------|
| Degree of protection (IP) (IEC 60529) | Reverse side IP65 |
| Enclosure material | Polyamide |
| Contact material | Silver-nickel |
| Number of NCs | 1 |
| Number of NOs | 1 |
| Connection cross-section | 0.75 ... 1.5 mm ² |
| Connection cross-section AWG | 18 AWG ... 12 AWG |
| Mounting depth | 130 mm |
| Mounting depth in inches | 5.12 in |
| Service life, min. | 10 ⁵ operating cycles |
| Weight | 125 g |

Mounting / Installation

| | |
|--------------------------|--------------|
| Tightening torque | 3 N · m |
| Tightening torque lbf in | 26.55 lbf in |

Components

| | |
|---------------|--|
| Actuator note | Switching element only; please order actuator separately |
| Entry 1 | 8161/7-M16-0902 |
| Entry 1 type | Polyamide cable gland, black |

Technical Drawings – Subject to Alterations

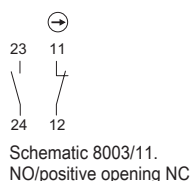

Dimensional Drawings (All Dimensions in mm [inches]) – Subject to Alterations

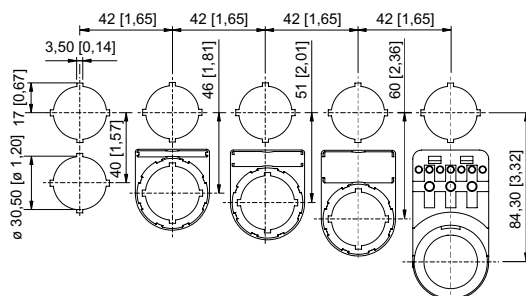
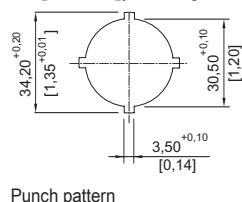
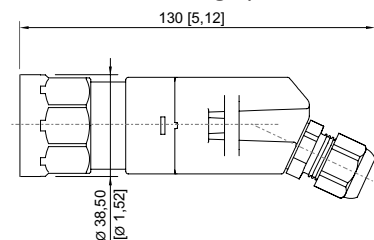

Cut-out with/without additional designation plate

Control and signalling devices

Control devices for panel mounting



Ex e

8003/111 UL Art. No. 127158

Accessories

Closing part

Art. No.



8602C3-733-B
for closing unused holes in cover, dia. 30.5 mm, NBR

244306

8602C3-733-S
for closing unused holes in cover, dia. 30.5 mm, silicone

244307

We reserve the right to make alterations to the technical data, dimensions, weights, designs and products available without notice. The illustrations cannot be considered binding.