

8008/2-027 Art. No. 128418



- Two-, three- or four-pole control switch: Three-pole load disconnect switch with one auxiliary contact
- Suitable for EM-STOP functions (in accordance with IEC/EN 60204 and DIN VDE 0113)
- Maintained-contact and momentary-contact positions possible

MY R. STAHL 8008A



R. STAHL's 8008 series control switches are available as two-, three- or four-pole control switches or three-pole load disconnect switches with one auxiliary contact. Their positive-opening NC contacts also make them suitable for EM-STOP functions. You can choose the switching function and set it to the maintained-contact or momentary-contact position.

### Technical Data

#### Explosion Protection

Application range (zones)	1 2
IECEX gas certificate	IECEX PTB 06.0010 U
IECEX gas explosion protection	Ex db eb IIC T6
IECEX firedamp certificate	IECEX PTB 06.0010U
IECEX firedamp protection	Ex de I
ATEX gas certificate	PTB 00 ATEX 1111U
ATEX gas explosion protection	Ex II 2 G Ex db eb IIC T6
ATEX firedamp certificate	PTB 00 ATEX 1111 U
ATEX firedamp protection	Ex I M2 Ex de I
Marking ULus	Class I, Zone 1 AEx db eb IIC T6 Gb Class I, Div. 2, Groups A,B,C,D
Marking cUL	Class I, Zone 1 Ex db eb IIC T6 Gb Class I, Div. 2, Groups A,B,C,D
Certificates	ATEX (PTB), Brazil (ULB), Canada / USA (UL), Canada (FM), Canada (UL), China (CQST), IECEX (PTB), Korea (KTL), USA (FM)

#### Electrical Data

Rated operational voltage AC	690 V
Rated operational voltage DC	230 V
AC UL rated operational voltage	600 V
Rated operational current for AC	16 A
Rated operational current for DC	0.4 A
UL rated operational current	6 A
No. of poles	2
Switching angle	45 °

#### Ambient Conditions

Ambient temperature	-50 °C ... +60 °C
---------------------	-------------------

8008/2-027 Art. No. 128418

### Mechanical Data

Degree of protection (IP)	IP00
Enclosure material	Epoxy resin
Contact material	Silver-nickel
Connection cross-section	2.5 mm <sup>2</sup>
Number of switching positions	3
Assembly for switching arrangement	027
Weight	128 g
Weight	0.28 lb

### Mounting / Installation

Tightening torque	1.8 Nm
Max. USA solid connection terminals	14 AWG

### Technical Drawings – Subject to Alterations

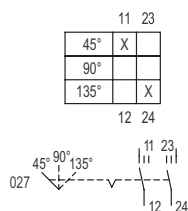

### Dimensional Drawings (All Dimensions in mm [inches]) – Subject to Alterations

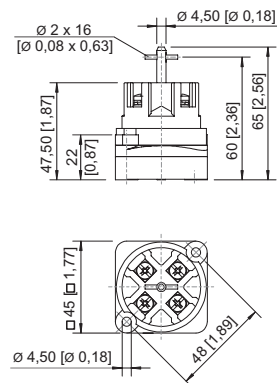

8008/2-0 control switch 1 or 2 pole

### Accessories

#### Rotary actuator, small, lockable

Art. No.

	Ø39, can be locked with one lock, 45° position with standard seal for up to -20 °C	227391
	Ø39, can be locked with one lock, 90° position with standard seal for up to -20 °C	227359

8008/2-027 Art. No. 128418

	Diameter 39 mm, Padlockable using 1 lock, 45° position Seal: Silicone, up to -60 °	227392
--	---	--------

**Rotary actuator, small, padlockable**

**Art. No.**

	Diameter 39 mm, Padlockable using 1 lock, 90° position Seal: Silicone, up to -60 °	227360
--	---	--------

We reserve the right to make alterations to the technical data, dimensions, weights, designs and products available without notice. The illustrations cannot be considered binding.