

Control and signalling devices

Contact element For mounting rail mounting

Ex e

8082/1-1-00 Art. No. 132636



- Wide selection of different actuators
- Versions as NC with positive opening, NO or disconnect terminal

MY R. STAHL 8082A



R. STAHL Series 8082 contact elements have an NO contact and a positive opening NC contact, either made of silver-nickel or gold-plated. They can easily be combined to form contact blocks and enable customised installations, in part due to the wide selection of different actuators.

Technical Data

Explosion Protection

Application range (zones)	1 2
IECEX gas certificate	IECEX PTB 06.0011U
IECEX gas explosion protection	Ex db eb IIC T6 Gb
IECEX firedamp certificate	IECEX PTB 06.0011U
IECEX firedamp protection	Ex db eb I Mb
ATEX gas certificate	PTB 00 ATEX 1031 U
ATEX gas explosion protection	Ex II 2 G Ex db eb IIC T6 Gb
ATEX firedamp certificate	PTB 00 ATEX 1031 U
ATEX firedamp protection	Ex I M2 Ex db eb I Mb
UL gas certificate	E182378V1S1
Inmetro gas certificate	ULBR130645U
Certificates	ATEX (PTB), Brazil (ULB), Canada / USA (UL), Canada (UL), China (CQST), IECEX (PTB), Korea (KTL), SIL (exida)
Notes	Product label may vary. Series devices are labelled with ATEX, IECEX, NEC and CE Code.

Functional Safety

SIL-capable	without actuators or with actuators 8602/3-006, 8602/3-009, 8602/3-010, 8602/3-012
-------------	--

Electrical Data

Max. rated operational voltage	550 V
Min. rated operational voltage	24 V
Rated operational voltage AC UL	600 V
Rated operational current	150 mA / 10 A
UL rated operational current	600 A
Electrical service life	10 ⁶ operating cycles
Mechanical service life	10 ⁶ operating cycles

Control and signalling devices

Contact element For mounting rail mounting

Ex e

8082/1-1-00 Art. No. 132636



Electrical Data

Switching capacity AC-12	250 V / 10 A 400 V / 7.5 A 550 V / 5 A
Switching capacity AC-15	110 V / 10 A 250 V / 6 A 400 V / 4 A
Switching capacity DC-13	60 V / 6 A
Switching capacity DC-13 2 contact elements in series	230 V/1 A 110 V/2.5 A

Ambient Conditions

Ambient temperature	-60 °C ... +70 °C (T6)
Operating temperature	-60 °C ... +100 °C

Mechanical Data

Degree of protection (IP) (IEC 60529)	IP20
Enclosure material	Polyamide
Contact material	Silver-nickel
Silicone-free	Yes
Max. connection cross-section, finely stranded	2,5 mm ²
Solid connection cross section	0.75-2.5 mm ²
Finely stranded connection cross section	0.75-2.5 mm ²
Connection cross-section, finely stranded with core end sleeve	0.75-2.5 mm ²
Number of NCs	1
Positive opening operation	Yes
Contacts	1 NC
Packaging unit	1
Weight	25 g
Weight	0.055 lb

Mounting / Installation

Tightening torque	1.2 Nm
Tightening torque lbf in	10.62 lbf in
Connection type	Screw terminal
Max. USA solid connection terminals	14 AWG

Technical Drawings – Subject to Alterations

 11
 12
 NC

Control and signalling devices

Contact element For mounting rail mounting

Ex e

8082/1-1-00 Art. No. 132636



Dimensional Drawings (All Dimensions in mm [inches]) – Subject to Alterations

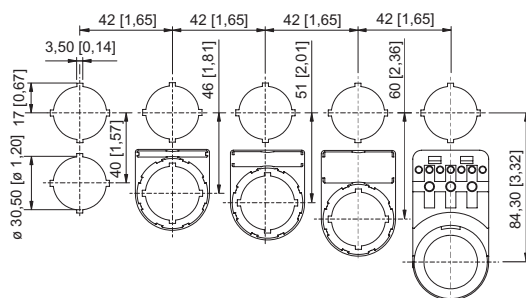
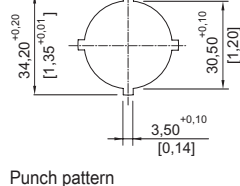
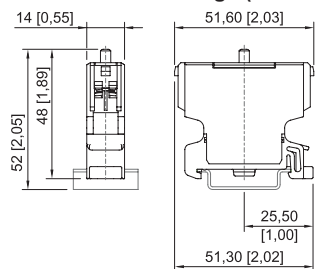

Cut-out with/without additional designation plate

Accessories

Pushbutton BG001



Ø 39 mm
Black
Designation plate: Black, blank disc without text
Silicone-free: Yes

Art. No.

223691

Ø 39 mm
Black
Designation plate: Black, blank disc without text
Silicone-free: No

223692

Mushroom pushbutton, black BG003



Ø 39 mm
Black
Designation plate: Black, blank disc without text
Silicone-free: Yes

Art. No.

244563

Ø 39 mm
Black
Designation plate: Black, blank disc without text
Silicone-free: No

244564

Mushroom pushbutton, red BG004



Ø 39 mm
Red/black
Designation plate: Red, blank disc without text
Silicone-free: Yes

Art. No.

244565

Ø 39 mm
Red/black
Designation plate: Red, blank disc without text
Silicone-free: No

244566

Mushroom stay-put button with key BG006



Ø 39 mm
Red/black
Closing: MS1
Silicone-free: Yes

Art. No.

223695

Ø 39 mm
Red/black
Closing: MS1
Silicone-free: No

223696

Control and signalling devices



Contact element For mounting rail mounting

Ex e

8082/1-1-00 Art. No. 132636



Key-operated switch actuator

		Art. No.
	Ø 39 mm Black Closing: MS1 Number of switching positions: 2 Switching function: Latching / Latching Silicone-free: No	244574
	Ø 39 mm Black Closing: MS1 Number of switching positions: 3 Switching function: Latching / Latching / Latching Silicone-free: No	244633

Mushroom stay-put button with EM-STOP key

		Art. No.
	Ø 39 mm Yellow/red Designation plate: With yellow backing plate Closing: MS1 Silicone-free: Yes	223693
	Ø 39 mm Yellow/red Designation plate: With yellow backing plate Closing: MS1 Silicone-free: No	223694

Mushroom stay-put button EM-STOP

		Art. No.
	Ø 39 mm Yellow/red Designation plate: With yellow backing plate Silicone-free: Yes	223697
	Ø 39 mm Yellow/red Designation plate: With yellow backing plate Silicone-free: No	223698

Mushroom stay-put button, black

		Art. No.
	Ø 39 mm Black Silicone-free: Yes	223699
	Ø 39 mm Black Silicone-free: No	223700

Control and signalling devices

Contact element For mounting rail mounting

Ex e

8082/1-1-00 Art. No. 132636



Mushroom pushbutton, 55 mm, red

		Art. No.
	Ø 55 mm Black/red Designation plate: Red, blank disc without text Silicone-free: Yes	244634
	Ø 55 mm Black/red Designation plate: Red, blank disc without text Silicone-free: No	244635

Mushroom stay-put button, 55 mm, EM-STOP

		Art. No.
	Ø 55 mm Yellow/red Designation plate: With yellow backing plate Silicone-free: Yes	244636

Mushroom stay-put button 55 mm EM-STOP

		Art. No.
	Ø 55 mm Yellow/red Designation plate: With yellow backing plate Silicone-free: No	244637

Twin pushbutton

		Art. No.
	Black Silicone-free: Yes	244638
	Black Silicone-free: No	244639

Mushroom pushbutton, 55 mm, black

		Art. No.
	Ø 55 mm Black Designation plate: Black, blank disc without text Silicone-free: Yes	244642
	Ø 55 mm Black Designation plate: Black, blank disc without text Silicone-free: No	244643

Small rotary actuator, not lockable

		Art. No.
	Ø 39 mm Black Designation plate: 0/OFF – I/ON Number of switching positions: 2 Lockable in: Not padlockable Switching function: Latching / Latching Silicone-free: Yes	244646

Control and signalling devices

Contact element For mounting rail mounting

Ex e

8082/1-1-00 Art. No. 132636



Small rotary actuator, not lockable

		Art. No.
	<p>Ø 39 mm Black Designation plate: 0/OFF – I/ON Number of switching positions: 2 Lockable in: Not padlockable Switching function: Latching / Latching Silicone-free: No</p>	244647

Small rotary actuator, not lockable

		Art. No.
	<p>Ø 39 mm Black Designation plate: I – 0 – II Number of switching positions: 3 Lockable in: Not padlockable Switching function: Latching / Latching / Latching Silicone-free: Yes</p>	244648
	<p>Ø 39 mm Black Designation plate: I – 0 – II Number of switching positions: 3 Lockable in: Not padlockable Switching function: Latching / Latching / Latching Silicone-free: No</p>	244649

Rotary actuator, small, lockable

		Art. No.
	<p>Ø 39 mm Black Designation plate: 0/OFF – I/ON Number of switching positions: 2 Lockable in: One pos. with one lock Switching function: Latching / Latching Silicone-free: Yes</p>	244650
	<p>Ø 39 mm Black Designation plate: 0/OFF – I/ON Number of switching positions: 2 Lockable in: One pos. with one lock Switching function: Latching / Latching Silicone-free: No</p>	244651
	<p>Ø 39 mm Black Designation plate: I – 0 – II Number of switching positions: 3 Lockable in: One pos. with one lock Switching function: Latching / Latching / Latching Silicone-free: Yes</p>	244652
	<p>Ø 39 mm Black Designation plate: I – 0 – II Number of switching positions: 3 Lockable in: One pos. with one lock Switching function: Latching / Latching / Latching Silicone-free: No</p>	244653

Control and signalling devices

Contact element For mounting rail mounting

Ex e

8082/1-1-00 Art. No. 132636



Illuminated pushbutton (spring return)

		Art. No.
	Ø 39 mm Black All colours Silicone-free: Yes	244654
	Ø 39 mm Black All colours Silicone-free: No	244655

Spare Parts

Mushroom stay-put button with key

		Art. No.
	Ø 39 mm Red/black Closing: MS2 Silicone-free: Yes	270409
	Ø 39 mm Red/black Closing: MS2 Silicone-free: No	270412
	Ø 39 mm Red/black Closing: MS3 Silicone-free: Yes	270410
	Ø 39 mm Red/black Closing: MS3 Silicone-free: No	270413
	Ø 39 mm Red/black Closing: MS4 Silicone-free: Yes	270411
	Ø 39 mm Red/black Closing: MS4 Silicone-free: No	270414

Control and signalling devices

Contact element For mounting rail mounting

Ex e

8082/1-1-00 Art. No. 132636



Key-operated switch actuator

BG008

Art. No.

		Art. No.
	Ø 39 mm Black Closing: MS1 Number of switching positions: 2 Switching function: Latching / Latching Silicone-free: Yes	244573
	Ø 39 mm Black Closing: MS2 Number of switching positions: 2 Switching function: Latching / Latching Silicone-free: Yes	272935
	Ø 39 mm Black Closing: MS2 Number of switching positions: 2 Switching function: Latching / Latching Silicone-free: No	270418
	Ø 39 mm Black Closing: MS3 Number of switching positions: 2 Switching function: Latching / Latching Silicone-free: Yes	274089
	Ø 39 mm Black Closing: MS3 Number of switching positions: 2 Switching function: Latching / Latching Silicone-free: No	270419
	Ø 39 mm Black Closing: MS4 Number of switching positions: 2 Switching function: Latching / Latching Silicone-free: Yes	272936
	Ø 39 mm Black Closing: MS4 Number of switching positions: 2 Switching function: Latching / Latching Silicone-free: No	270420

Control and signalling devices

Contact element For mounting rail mounting

Ex e

8082/1-1-00 Art. No. 132636



	Ø 39 mm Black Closing: MS1 Number of switching positions: 3 Switching function: Latching / Latching / Latching Silicone-free: Yes	244632
	Ø 39 mm Black Closing: MS2 Number of switching positions: 3 Switching function: Latching / Latching / Latching Silicone-free: Yes	274090
	Ø 39 mm Black Closing: MS2 Number of switching positions: 3 Switching function: Latching / Latching / Latching Silicone-free: No	270421
	Ø 39 mm Black Closing: MS3 Number of switching positions: 3 Switching function: Latching / Latching / Latching Silicone-free: Yes	274091
	Ø 39 mm Black Closing: MS3 Number of switching positions: 3 Switching function: Latching / Latching / Latching Silicone-free: No	270422
	Ø 39 mm Black Closing: MS4 Number of switching positions: 3 Switching function: Latching / Latching / Latching Silicone-free: Yes	274092
	Ø 39 mm Black Closing: MS4 Number of switching positions: 3 Switching function: Latching / Latching / Latching Silicone-free: No	270423

Control and signalling devices

Contact element For mounting rail mounting

Ex e

8082/1-1-00 Art. No. 132636



Mushroom stay-put button with EM-STOP key

BG009

Art. No.

		Art. No.
	Ø 39 mm Yellow/red Designation plate: With yellow backing plate Closing: MS2 Silicone-free: Yes	274099
	Ø 39 mm Yellow/red Designation plate: With yellow backing plate Closing: MS2 Silicone-free: No	270415
	Ø 39 mm Yellow/red Designation plate: With yellow backing plate Closing: MS3 Silicone-free: Yes	274100
	Ø 39 mm Yellow/red Designation plate: With yellow backing plate Closing: MS3 Silicone-free: No	270416
	Ø 39 mm Yellow/red Designation plate: With yellow backing plate Closing: MS4 Silicone-free: Yes	274101
	Ø 39 mm Yellow/red Designation plate: With yellow backing plate Closing: MS4 Silicone-free: No	270417

We reserve the right to make alterations to the technical data, dimensions, weights, designs and products available without notice. The illustrations cannot be considered binding.