

Load disconnect switches and motor starters

Direct-on-line mtr strtr (DOL)



8264/5-SM-ES45kW400V-T Art. No. 143175



- Motor control units with international certification
- Robust structure: Seawater-resistant enclosure, can be used in a large temperature range
- Control units: Direct-on-line motor starters (DOL), YD star-delta contactor combinations, reversing contactor combinations

MY R. STAHL 8264D



R. STAHL Series 8264/5 "CUBEx" standard motor control units are installed in a seawater-resistant Ex d enclosure and are suitable for a large temperature range. They are available in various control versions. As an option, the control units can be fitted with main switches, control transformers, main and control fuses, and control and signalling devices as per the customer's requirements.

Technical Data

Explosion Protection	
Application range (zones)	1, 2, 21, 22
IECEX gas certificate	IECEX KEM 07.0051X
IECEX gas explosion protection	Ex db IIB+H2 T6 Gb
IECEX dust certificate	IECEX KEM 07.0051 X
IECEX dust explosion protection	Ex tb IIIC T80 °C Db
ATEX gas certificate	KEMA 01 ATEX 2145 X
ATEX gas explosion protection	Ex II 2 G Ex db IIB+H2 T6 Gb
ATEX dust certificate	KEMA 01 ATEX 2145 X
ATEX dust explosion protection	Ex II 2 D Ex tb IIIC T80 °C Db
Certificates	ATEX (DEK), Brazil (ULB), Canada / USA (UL), China (NEPSI), IECEX (DEK), India (PESO), Korea (KGS), Taiwan (ITRI)
Declaration of conformity	ATEX (EUK), China (CCC)
Electrical Data	
Rated operational voltage AC	400 V
Switching capacity	45 kW
Ambient Conditions	
Ambient temperature	-20 °C ... +40 °C
Mechanical Data	
Degree of protection (IP)	IP65
Degree of protection (IP) (IEC 60529)	IP66
Enclosure material	Aluminium, copper-free, Seawater-resistant
Dimensions (W x H x D)	360,000 x 360,000 x 270,000 mm
Dimensions (W x H x D) inches	360,000 x 360,000 x 270,000 mm
Width	360 mm
Height	360 mm
Depth	270 mm
Weight	39 kg

Load disconnect switches and motor starters

Direct-on-line mtr strtr (DOL)



8264/5-SM-ES45kW400V-T Art. No. 143175

Mechanical Data

Weight	85.98 lb
--------	----------

Technical Drawings – Subject to Alterations

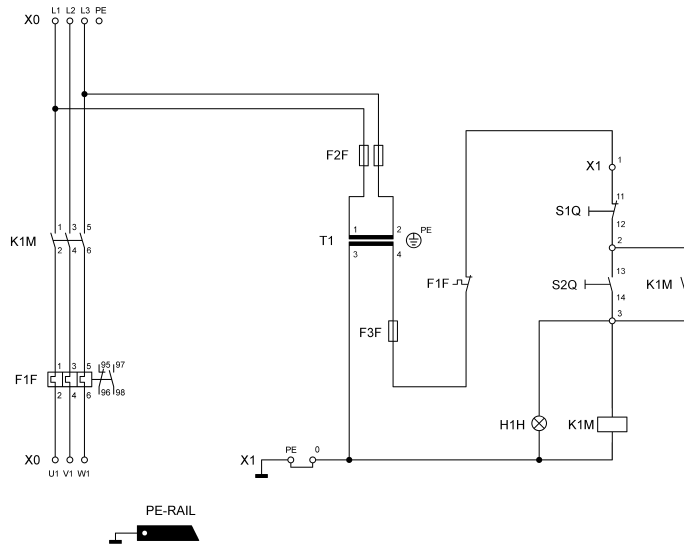

Schematic

Dimensional Drawings (All Dimensions in mm [inches]) – Subject to Alterations

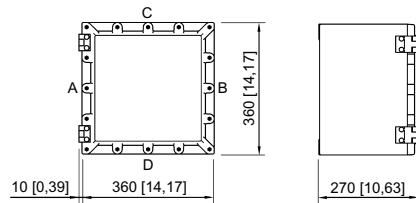

8264/5222

We reserve the right to make alterations to the technical data, dimensions, weights, designs and products available without notice. The illustrations cannot be considered binding.