

8265/64-0000 Art. No. 165780



- Six basic enclosure sizes, optional inspection windows
- International certification, wide temperature range, seawater-resistant light-metal enclosure
- Empty enclosure
- Custom entries available upon request
- For use in Class I, Div. 1 & 2

MY R. STAHL 8265K



R. STAHL series 8265 are explosionproof and dust-ignitionproof empty enclosures globally certified. The large cover opening allows easier access for mounting and maintenance of components within the enclosure. The cover is also available with a window. R. STAHL can install various equipment in the enclosure including arc and sparking components according to customer requirements. Check with your R. STAHL representative to see if your specified equipment can be mounted in the enclosure.

Technical Data

Explosion Protection

Application range (zones)	1 2 21 22
IECEX gas certificate	IECEX PTB 07.0027 U
IECEX gas explosion protection	Ex db eb IIC Gb
IECEX dust certificate	IECEX PTB 07.0027 U
IECEX dust explosion protection	Ex tb IIIC Db
ATEX gas certificate	PTB 06 ATEX 1023 U
ATEX gas explosion protection	Ex II 2 G Ex db eb IIC Gb
ATEX dust certificate	PTB 06 ATEX 1023 U
ATEX dust explosion protection	Ex II 2 D Ex tb IIIC Db
Certificate ULus	E307783
Marking ULus	Class I, Div. 1, Groups A,B,C,D Class II,III, Div. 1, E, F, G Class I, Zone 1, Group IIC Enclosure Type 3, 4, 4X
Certificate cUL	E307783
Marking cUL	Class I, Zone 1, Group IIC Class I, Div. 1, Groups A,B,C,D Class II,III, Div. 1, E, F, G Enclosure Type 3, 4, 4X
Marking Notes	also for installation in Class I, II & III, Div. 2
Certificates	ATEX (PTB), Canada / USA (UL), Canada (UL), IECEX (PTB), USA (UL)

Ambient Conditions

Ambient temperature	-25 °C ... +50 °C
Ambient temperature	-13°F ... +122°F

8265/64-0000 Art. No. 165780

Mechanical Data

Degree of protection (IP)	IP54
Degree of protection note	IP66 with O-ring silicone
Enclosure type (NEMA250)	3, 4, 4X
Enclosure material	Aluminium, copper-free, Seawater-resistant
Enclosure colour	without
Clamping range max.	95 mm ²
Cover	Closed
Design	Without entry
Width	236 mm
Width in inches	9.29 in
Height	227 mm
Height, inches	8.94 in
Length	236 mm
Length, inches	9.29 in
Diameter	289 mm
Diameter inch	11.38 in
Enclosure size	4
Weight	10.6 kg
Weight	23.46 lb

Dimensional Drawings (All Dimensions in mm [inches]) – Subject to Alterations

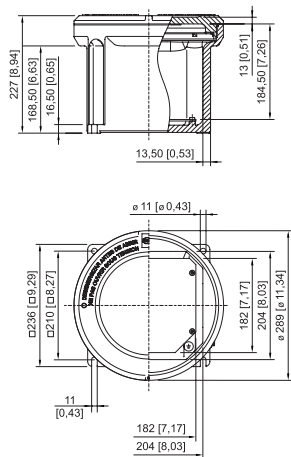

Enclosure size 4 without inspection window

Accessories

Cover without sight glass





Enclosure: 8265/.4-0000

Art. No.

143472

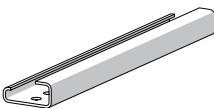
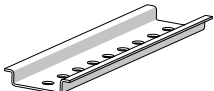
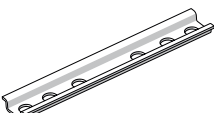
8265/64-0000 Art. No. 165780

Mounting rail		Art. No.
	G32 length: 189 mm [7.44 in] for enclosure size 4	137945
	TS35 length: 189 mm [7.44 in] for enclosure size 4	137976
	TS15 length: 189 mm [7.44 in] for enclosure size 4	137908

Mounting plate		Art. No.
	for enclosure size 4 M5 x 8 screws are included.	316170

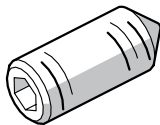
Threaded pin		Art. No.
	M5x16-A2 with allen screw and point	110216

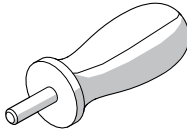
Box spanner		Art. No.
	to open the enclosure cover for size 1, 2, 3, 4 2 box spanner are required	142059

Spare Parts

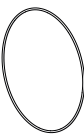
O-ring		Art. No.
	silicone, for enclosure size 4	305631

We reserve the right to make alterations to the technical data, dimensions, weights, designs and products available without notice. The illustrations cannot be considered binding.