

Signalling devices



Visual signalling device LED continuous beacon

In flameproof enclosure Increased safety

6161/3-10-321-0-1 Art. No. 219831



- Lamp: Flashing beacon – XENON (5 J)/continuous beacon – LED
- Type of protection: Ex d with Ex e connection chamber
- Class: IP66 (IEC 60529)
- Robust aluminium enclosure (powder-coated)
- Six lens colours can be ordered

MY R. STAHL 6161A



The **6161 product series** can be used as a signal lamp or warning lamp in areas with an explosive gas atmosphere or explosive dust atmosphere.

Technical Data

Explosion Protection

| | |
|---------------------------------|--|
| Scope of validity | IECEX European Union (ATEX) |
| Application range (zones) | 1 2 21 22 |
| IECEX gas certificate | IECEX EPS 20.0004X |
| IECEX gas explosion protection | Ex db eb IIC T6 Gb |
| IECEX dust certificate | IECEX EPS 20.0004X |
| IECEX dust explosion protection | Ex tb IIIC T65 °C / T75 °C Db |
| ATEX gas certificate | EPS 20 ATEX 1 008 X |
| ATEX gas explosion protection | ⊕ II 2 G Ex db eb IIC T6 Gb |
| ATEX dust certificate | EPS 20 ATEX 1 008 X |
| ATEX dust explosion protection | ⊕ II 2 D Ex tb IIIC T65 °C / T75 °C Db |
| Certificates | ATEX (BVIS), IECEX (BVIS) |
| Declaration of Conformity | ATEX (EUK) |

Electrical Data

| | |
|------------------------------|-------|
| Rated operational voltage AC | 230 V |
| Back-up fuse | 4 AT |

Lighting Data

| | |
|------|-----|
| Lamp | LED |
|------|-----|

Ambient Conditions

| | |
|---------------------|---|
| Ambient temperature | -40 °C ... +40 °C (T6) -40 °C ... +50 °C |
|---------------------|---|

Mechanical Data

| | |
|---------------------------------------|--|
| Degree of protection (IP) | IP66 |
| Degree of protection (IP) (IEC 60529) | IP66 |
| Enclosure material | Aluminium, powder-coated, Seawater-resistant |
| Enclosure colour | Yellow / black, powder-coated |

Signalling devices



Visual signalling device LED continuous beacon

In flameproof enclosure Increased safety

6161/3-10-321-0-1 Art. No. 219831

Mechanical Data

| | |
|---|---------------------------------|
| Sealing material | NBR O-ring seal |
| Material dome | Polycarbonate (Lexan) Prismatic |
| Wire guard material | Stainless steel |
| Terminal marking | PE + N + L1 |
| Max. solid connection terminals | 4 mm ² |
| Max. finely stranded connection terminals | 2.5 mm ² |
| Clamping range | 4 ... 13 mm |
| Type of connection cable | Solid Finely stranded |
| Width | 76 mm |
| Height | 260 mm |
| Length | 91 mm |
| Lens colour | Red |
| Weight | 1.4 kg |
| Weight | 3.09 lb |

Mounting / Installation

| | |
|------------------------|-------------------------------|
| Connection type | Screw terminals, 3-pin |
| Mounting part material | Stainless steel |
| Note about mounting | Can be ordered as accessories |

Components

| | |
|--------------------------|-------------------------------|
| Drilled holes | 2 x M20 |
| Cable glands and entries | 1 x M20 Ø 4 ... 13 mm |
| Material cable gland | Polyamide, black |
| Stopping plugs | 1 x M20 x 1.5 |
| Stopping plug material | Polyamide, black |
| Wire guard | Can be ordered as accessories |

Dimensional Drawings (All Dimensions in mm [inches]) – Subject to Alterations

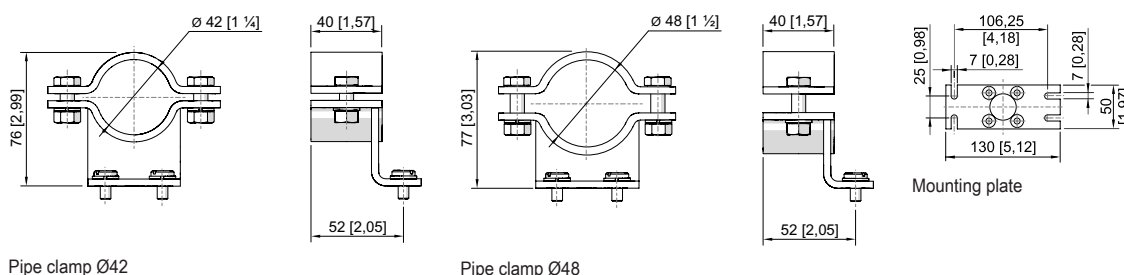
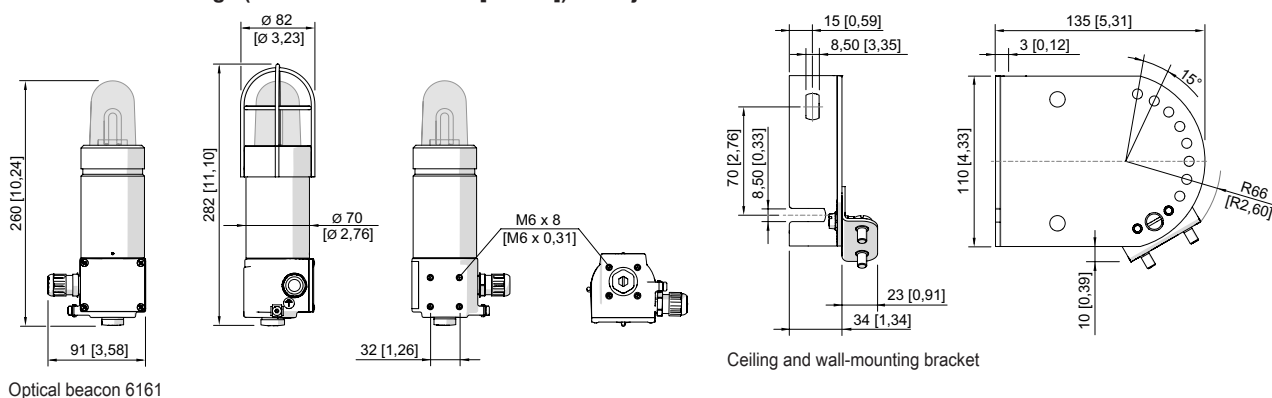

Signalling devices



Visual signalling device LED continuous beacon

In flameproof enclosure Increased safety

6161/3-10-321-0-1 Art. No. 219831

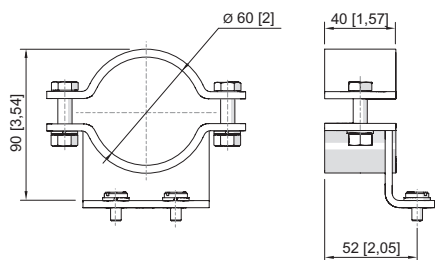

Pipe clamp Ø60

Accessories



Cable gland made of plastic

| | | Art. No. |
|--|--|----------|
|  | 8161/7-M20-1304, Ex e Plastic, M20 x 1.5, cable outer diameter 4 to 13 mm Lot size 50 pieces | 239156 |

Stopping plug

| | | Art. No. |
|---|---|----------|
|  | 8290/3-M20 Plastic, M20 x 1.5 Lot size 1 piece | 143522 |
| | 8290/3-M20 Plastic, M20 x 1.5 Lot size 100 pieces | 285773 |

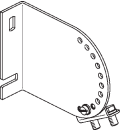
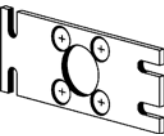
Mounting accessories

| | | Art. No. |
|--|---|----------|
|  | Mounting bracket for wall or floor mounting, stainless steel, incl. mounting screws | 120826 |
|  | Mounting plate for wall or floor mounting (stainless steel), incl. mounting screws | 120821 |
|  | Pipe clamp, R 1 1/4" | 120812 |
| | Pipe clamp, R 1 1/2" | 120819 |
| | Pipe clamp, R 2" | 120823 |
|  | Protective cage, stainless steel | 307544 |

We reserve the right to make alterations to the technical data, dimensions, weights, designs and products available without notice. The illustrations cannot be considered binding.