

# Signalling devices



Visual signalling device LED continuous beacon

In flameproof enclosure Increased safety

6161/3-70-221-0-1 Art. No. 219846



- Lamp: Flashing beacon – XENON (5 J)/continuous beacon – LED
- Type of protection: Ex d with Ex e connection chamber
- Class: IP66 (IEC 60529)
- Robust aluminium enclosure (powder-coated)
- Six lens colours can be ordered

MY R. STAHL 6161A



The **6161 product series** can be used as a signal lamp or warning lamp in areas with an explosive gas atmosphere or explosive dust atmosphere.

## Technical Data

### Explosion Protection

Scope of validity	IECEX European Union (ATEX)
Application range (zones)	1 2 21 22
IECEX gas certificate	IECEX EPS 20.0004X
IECEX gas explosion protection	Ex db eb IIC T6 Gb
IECEX dust certificate	IECEX EPS 20.0004X
IECEX dust explosion protection	Ex tb IIIC T65 °C / T75 °C Db
ATEX gas certificate	EPS 20 ATEX 1 008 X
ATEX gas explosion protection	⊕ II 2 G Ex db eb IIC T6 Gb
ATEX dust certificate	EPS 20 ATEX 1 008 X
ATEX dust explosion protection	⊕ II 2 D Ex tb IIIC T65 °C / T75 °C Db
Certificates	ATEX (BVIS), IECEX (BVIS)
Declaration of Conformity	ATEX (EUK)

### Electrical Data

Rated operational voltage AC	24 V
Rated operational voltage DC	24 V
Back-up fuse	4 AT

### Lighting Data

Lamp	LED
------	-----

### Ambient Conditions

Ambient temperature	-40 °C ... +40 °C (T6) -40 °C ... +50 °C
---------------------	---

### Mechanical Data

Degree of protection (IP)	IP66
Degree of protection (IP) (IEC 60529)	IP66
Enclosure material	Aluminium, powder-coated, Seawater-resistant

# Signalling devices



Visual signalling device LED continuous beacon

In flameproof enclosure Increased safety

6161/3-70-221-0-1 Art. No. 219846

## Mechanical Data

Enclosure colour	Yellow / black, powder-coated
Sealing material	NBR O-ring seal
Material dome	Polycarbonate (Lexan) Prismatic
Wire guard material	Stainless steel
Terminal marking	PE + N + L1
Max. solid connection terminals	4 mm <sup>2</sup>
Max. finely stranded connection terminals	2.5 mm <sup>2</sup>
Clamping range	4 ... 13 mm
Type of connection cable	Solid Finely stranded
Width	76 mm
Height	260 mm
Length	91 mm
Lens colour	Clear
Weight	1.4 kg
Weight	3.09 lb

## Mounting / Installation

Connection type	Screw terminals, 3-pin
Mounting part material	Stainless steel
Note about mounting	Can be ordered as accessories

## Components

Drilled holes	2 x M20
Cable glands and entries	1 x M20 Ø 4 ... 13 mm
Material cable gland	Polyamide, black
Stopping plugs	1 x M20 x 1.5
Stopping plug material	Polyamide, black
Wire guard	Can be ordered as accessories

## Dimensional Drawings (All Dimensions in mm [inches]) – Subject to Alterations

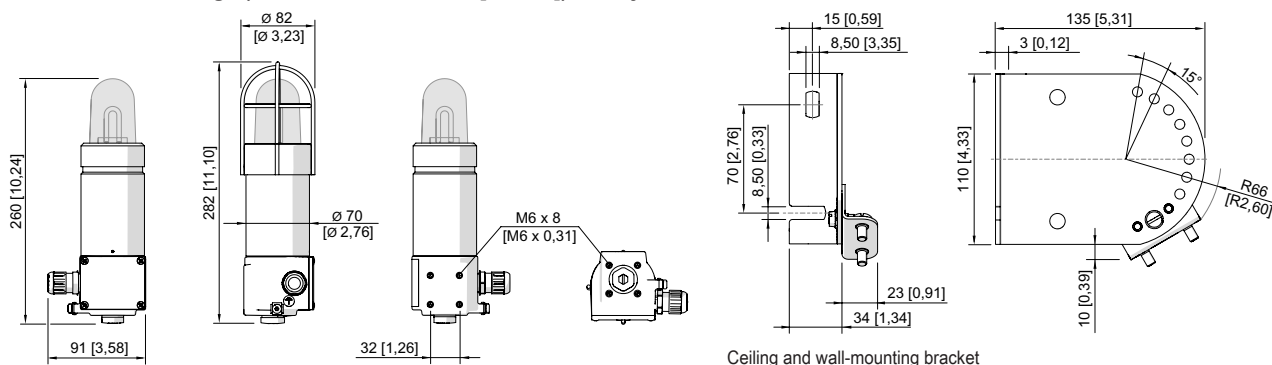

# Signalling devices

Visual signalling device LED continuous beacon

In flameproof enclosure Increased safety

6161/3-70-221-0-1 Art. No. 219846

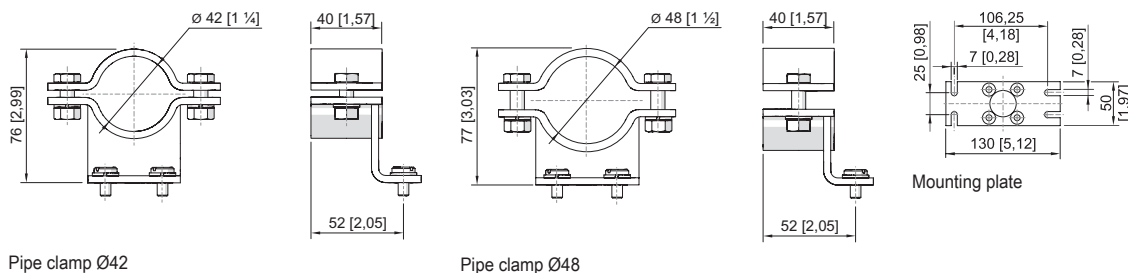

Pipe clamp Ø42

Pipe clamp Ø48

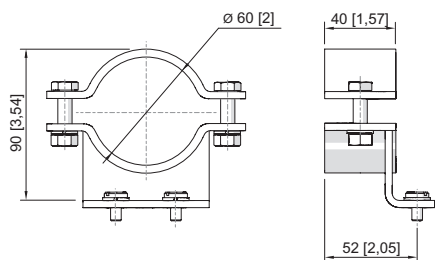

Pipe clamp Ø60

## Accessories

### Cable gland made of plastic



8161/7-M20-1304, Ex e  
Plastic, M20 x 1.5, cable outer diameter 4 to 13 mm  
Lot size 50 pieces

### Art. No.

239156

### Stopping plug



8290/3-M20  
Plastic, M20 x 1.5  
Lot size 1 piece  
8290/3-M20  
Plastic, M20 x 1.5  
Lot size 100 pieces

### Art. No.

143522

285773

### Mounting accessories

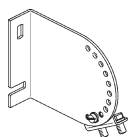

Mounting bracket for wall or floor mounting, stainless steel, incl. mounting screws

### Art. No.

120826

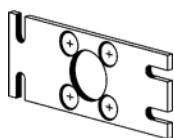

Mounting plate for wall or floor mounting (stainless steel), incl. mounting screws

120821



Pipe clamp, R 1 1/4"

120812

Pipe clamp, R 1 1/2"

120819

Pipe clamp, R 2"

120823

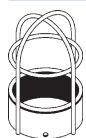

Protective cage, stainless steel

307544

## Signalling devices

Visual signalling device LED continuous beacon

In flameproof enclosure Increased safety

6161/3-70-221-0-1 Art. No. 219846

---



We reserve the right to make alterations to the technical data, dimensions, weights, designs and products available without notice. The illustrations cannot be considered binding.