

Installation equipment

Rotary actuator, small lockable



8602C3-734-B-45H-E08 Art. No. 227391



- Pushbutton, mushroom pushbutton, mushroom stay-put button with key lock, mushroom stay-put button, twin pushbutton and illuminated pushbutton, rotary actuator, key-operated switch, potentiometer bezel and indicator lamp bezel
- One axial actuator can actuate up to four Series 8082 contact elements
- Key-operated switches and rotary switches codable at any time as "latching/spring return" or "key not removable"

MY R. STAHL 8602A



Thanks to their special technical features, the actuators from the 8602/3 series can withstand the most extreme conditions. In addition to the application option for use in ambient temperatures from -60 °C to +70 °C, the IP degree of protection, IP66, is maintained in accordance with EN 60529. It is also possible to actuate up to four contact elements from the 8082 series with a single axial actuator from the 8602/3 series.

The coding option of the key switches and rotary switches is innovative and one-of-a-kind. Integrated coding allows you to adjust the "latching/spring return" and/or "key not removable" functions at any time without additional accessories. A versatile set of accessories consisting of label holders and locking devices is available.

Technical Data

Explosion Protection

| | |
|---------------------------------|--|
| Application range (zones) | 1, 2, 21, 22 |
| IECEX gas certificate | IECEX PTB 13.0047U |
| IECEX gas explosion protection | Ex eb IIC Gb |
| IECEX dust certificate | IECEX PTB 13.0047 U |
| IECEX dust explosion protection | Ex tb IIIC Db |
| ATEX gas explosion protection | Ex II 2 G Ex eb IIC Gb |
| ATEX dust explosion protection | Ex II 2 D Ex tb IIIC Db |
| UL gas certificate | E182378 V4 S2 |
| Certificate ULus | E182378 V4 S2 |
| Marking ULus | Class I, Zone 1, AEx eb IIC Gb Zone 21, AEx tb IIIC Db |
| Certificate cUL | E182378V4S2 |
| Marking cUL | Class I, Zone 1, Ex eb IIC Gb Zone 21, Ex tb IIIC Db |
| Inmetro gas certificate | UL-BR 14.0380U |
| Inmetro dust certificate | UL-BR 14.0380U |
| Certificates | ATEX (PTB), Brazil (ULB), Canada / USA (UL), Canada (UL), IECEX (PTB), Korea (KGS), USA (UL) |

Ambient Conditions

| | |
|---------------------|--------------------|
| Ambient temperature | -20 °C ... 60 °C |
| Ambient temperature | -4 °F ... +140 °F |
| Storage temperature | -25 °C ... 60 °C |
| Storage temperature | -13 °F ... +140 °F |

Installation equipment

Rotary actuator, small lockable



8602C3-734-B-45H-E08 Art. No. 227391

Ambient Conditions

| | |
|-------------------------|----------|
| Use at the height of | < 2000 m |
| Max. operating altitude | 2000 m |
| Degree of pollution | 3 |

Mechanical Data

| | |
|------------------------------|---|
| Version | lockable |
| Degree of protection (IP) | IP66 |
| Note on degree of protection | According to IEC/EN 60529 |
| Enclosure material | Polyamide |
| Silicone-free | Yes |
| Assembly | 734 |
| Diameter | 39 mm |
| Service life, min. | 10 ⁵ actuations |
| Impact strength (IEC 60079) | 7 J |
| Impact strength (IEC 62262) | min. IK08 |
| Colour | Black |
| Mounting | Thread type |
| Designation plate | 0/OFF - I/ON |
| Seal | Standard |
| Lockable in | One pos. with one lock |
| Packaging unit | 1 |
| Description note | 0/OFF-I/ON label provided separately. Cylinder lock not enclosed. Other labels must be ordered separately. |
| Weight | 40 g |
| Weight | 0.09 lb |

Mounting / Installation

| | |
|--------------------------|----------------------|
| Mounting type | Front panel mounting |
| Tightening torque | 3 N · m |
| Tightening torque lbf in | 26.55 lbf in |

Technical Drawings – Subject to Alterations

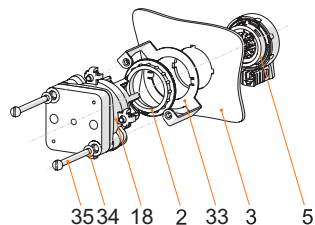

Front installation mounting with Series 8008 control switch

Key

- 2 = jam nut (order no. 205592)
- 3 = installation wall (wall thickness max. 2 mm [0.0787 inch])
- 4 = 8302/3 actuator with seal
- 18 = 8008/2- control switch
- 33 = front installation 8602/3 adaptor for type 8008/2
- 34 = M4 disc
- 35 = M4x screw

Installation equipment

Rotary actuator, small lockable



8602C3-734-B-45H-E08 Art. No. 227391

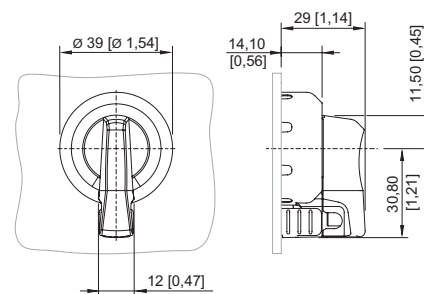
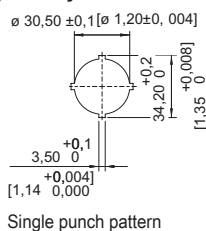
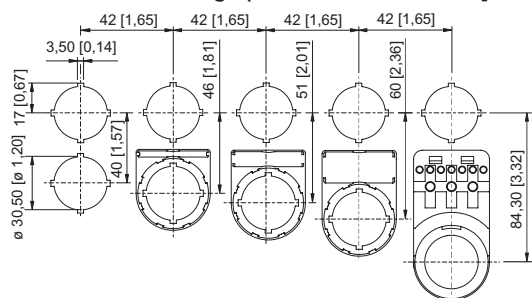

Dimensional Drawings (All Dimensions in mm [inches]) – Subject to Alterations





8602/3-734 rotary actuator, lockable using one lock
Actuator with radial actuation

Cut-out with/without additional designation plate

Accessories







| Cylinder lock | | Art. No. |
|--|--|----------|
|  | for closing (bracket Ø 3) | 107115 |
| Closing part | | Art. No. |
|  | 8602C3-733-B for closing unused holes in cover, dia. 30.5 mm, NBR | 244306 |

Spare Parts

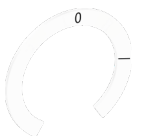
| Insert discs for label holder | | Art. No. |
|--|--|----------|
|  | One-line Plain Material: PVC Colour: White Self-adhesive | 238271 |
|  | Two-line Plain Material: PVC Colour: White Self-adhesive | 238272 |
|  | Three-line Plain Material: PVC Colour: White Self-adhesive | 238273 |

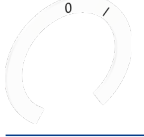
| Labels for small BG 732, BG 734 rotary actuator | | Art. No. |
|--|-------------------------|----------|
|  | Dia. 30.8 0/OFF I/ON | 227489 |

8602C3-734-B-45H-E08 Art. No. 227391

| Labels for small BG 732, BG 734 rotary actuator | | Art. No. |
|--|-------------------------------|----------|
|  | Dia. 30.8 0 I | 227490 |
|  | Dia. 30.8 I 0 II | 227491 |
|  | Dia. 30.8 0 I | 227492 |
|  | Dia. 30.8 MANUAL 0 AUTO | 227494 |
|  | Dia. 30.8 OFF ON | 269983 |
|  | Dia. 30.8 AUTO 0 MANUAL ON | 269984 |
|  | Dia. 30.8 AUTO 0 MANUAL | 269985 |

| Labels for small BG 732, BG 734 rotary actuator and BG 726, BG 727 axial rotary actuator | | Art. No. |
|--|--------------------|----------|
|  | Dia. 30.8 Plain | 227495 |

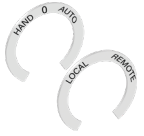
| Label set for BG732 | | Art. No. |
|--|---|----------|
|  | The label set contains three dia. 30.8 mm labels 1x label with text HAND-0-AUTO 1x label with text LOCAL-REMOTE 1x label blank | 321792 |





| Label holder | | Art. No. |
|--|---|----------|
|  | Size 1, without insert disc, 1-line label for actuators Ø 39 | 223566 |

Installation equipment

Rotary actuator, small lockable



8602C3-734-B-45H-E08 Art. No. 227391

| Label holder | | Art. No. |
|---|--|----------|
|  | Size 2, without insert disc, 1- or 2-line label for actuators Ø 39 | 223567 |
|  | Size 3, without insert disc, 1-, 2- or 3-line label for actuators Ø 39 | 223568 |
| Special key | | Art. No. |
|  | for tightening plastic locking nut | 169101 |
| Adaptor for front installation | | Art. No. |
|  | 8602/3 front installation for control switch of Series 8008 | 260081 |

We reserve the right to make alterations to the technical data, dimensions, weights, designs and products available without notice. The illustrations cannot be considered binding.