



- Smart Central Locking System – Allows effortless access for quick maintenance, minimizing downtime and enhancing operational efficiency.
- Advanced Surge Protection up to 6KV – Engineered for resilience, the robust design shields the luminaire from electrical surges, ensuring long-lasting performance.
- Superior Energy Efficiency – Achieves an outstanding 130 lumens per watt, delivering maximum illumination with minimal energy consumption.
- Long-Lasting LED Performance – Designed for durability, the luminaire delivers over 60,000 hours of service life even in +55°C ambient conditions.

MY R. STAHL 6602A

The 6602 linear LED luminaire is built to withstand harsh conditions, making it ideal for industries such as oil & gas, specialty chemicals, and pharmaceuticals and similar hazardous environments. With its high-performance illumination, it is perfect for lighting large surfaces at mounting heights of up to 10 meters, as well as illuminating equipment and objects both indoors and outdoors. For added flexibility, the luminaire can be easily mounted on poles using the pole mounting sleeve accessory, ensuring adaptable installation across various industrial settings.

Technical Data

| Explosion Protection | |
|-------------------------------------|---|
| Ex version | Yes |
| Application range (zones) | 2, 21, 22 |
| IECEX gas certificate | IECEX IBE 24.0030X |
| IECEX gas explosion protection | Ex ec mb IIC T4 Gc |
| IECEX dust certificate | IECEX IBE 24.0030X |
| IECEX dust explosion protection | Ex tb IIIC T85 °C Db |
| Certificates | IECEX (IBE), India (PESO) |
| Electrical Data | |
| Control gear service life | C10 ≥ 50 h, Ta ≤ 55 °C |
| LED service life | L70B50 ≥ 60 h |
| Lighting Data | |
| Number of lamps | 1 |
| Lamp wattage | 22 W |
| Lamp | LED |
| Light colour | 5700 K – cool white |
| Light distribution | 120°x120° with diffusing glass |
| Luminaire efficacy | 125 lm/W |
| Luminous flux | 2837 lm |
| Colour rendering | ≥ 80 |
| Colour temperature | 5700 K |
| Mechanical Data | |
| Version | Standard |
| IP degree of protection (IEC 60598) | IP66/IP67 |
| Enclosure material | Polyester resin, Glass fibre reinforced |
| Enclosure colour | Light grey (RAL 7035) |

Lighting

Linear luminaire With LED

GRP

6602/1123-0300-332-2220-22-857 Art. No. 325345



Mechanical Data

| | |
|---|--------------------------|
| Diffuser | With diffuser |
| Sealing material | Silicone |
| Silicone-free content | Contains silicone |
| Translucent cover material | Polycarbonate |
| Installed terminal strip | PE + N + L1 |
| Max. solid connection terminals | 4 mm ² |
| Max. finely stranded connection terminals | 4 mm ² |
| Type of connection cable | Finely stranded Solid |
| Size | 2 |
| Width | 184 mm |
| Height | 125 mm |
| Length | 700 mm |
| Impact strength (IEC 62262) | IK10 |
| Disconnection of the luminaire | No |
| Weight | 4.3 kg |
| Weight | 9.48 lb |

Components

| | |
|--------------------------|---------------------------------------|
| Threaded plate | 2x stainless steel |
| Ballast | 6049/111-110-10 |
| Through wiring | With 3 conductors 2.5 mm ² |
| Drilled holes | 3 x M20 |
| Cable glands and entries | can be ordered as an accessory |
| Stopping plugs | Can be ordered as accessories |
| Accessories | without |

Light Distribution Curves

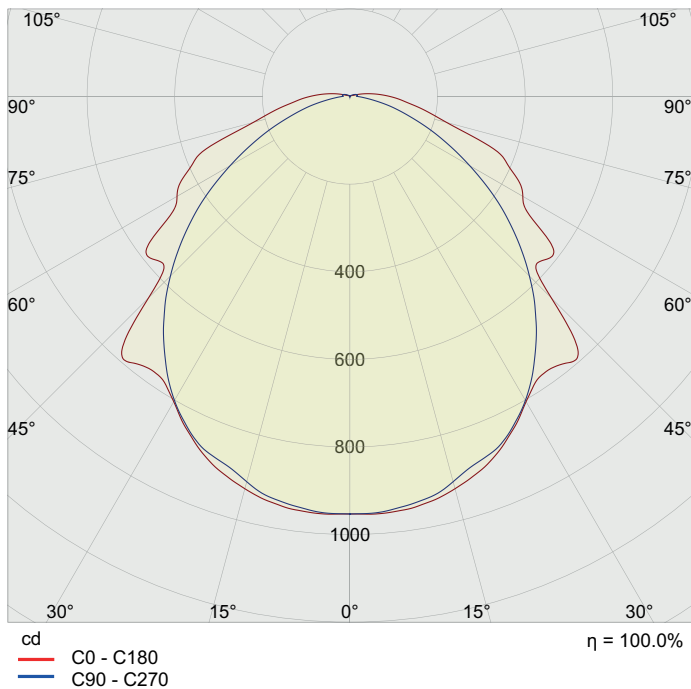

Size 2

Dimensional Drawings (All Dimensions in mm [inches]) – Subject to Alterations

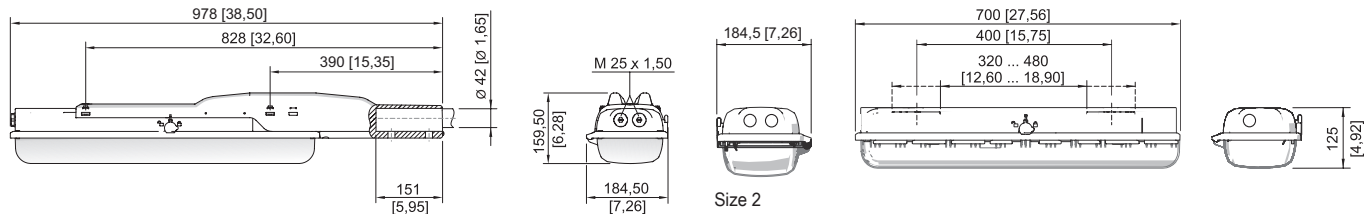

Size 2

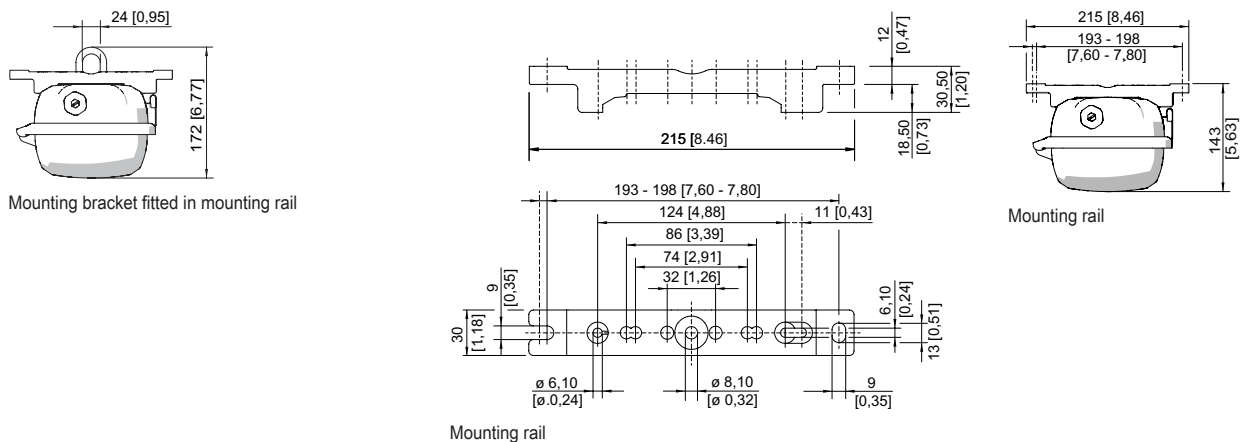

Lighting

Linear luminaire With LED

GRP

6602/1123-0300-332-2220-22-857 Art. No. 325345

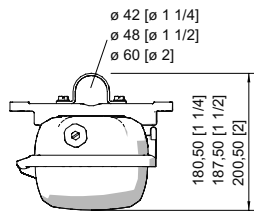

Pipe clamp fitted in mounting rail

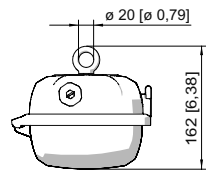

Ring bolt fitted in insert nut of the luminaire

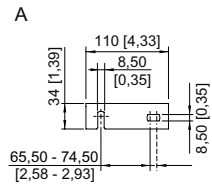
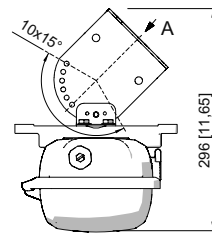

Wall mounting bracket fitted in mounting rail

Accessories

Box spanner

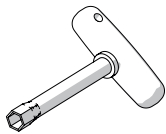

M8 / A/F 13;
For actuating the central lock

Art. No.

222430

Breather

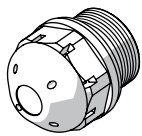

Thread: M25 x 1.5 (20 pieces); without jam nut

Art. No.

285780

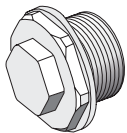

Thread: M25 x 1.5 (1 piece); for installation in light fittings; made from stainless steel; without jam nut

296608

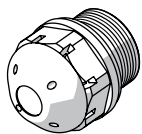

M25 x 1.5 in order to avoid condensate formation

115738

Ceiling and wall mounting bracket

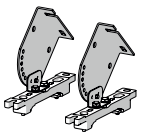

mounted on a mounting rail for a variable mounting distance; Material: stainless steel; Lamp can be swiveled in steps of 15°; 1 pair

Art. No.

222827

Mounting bracket

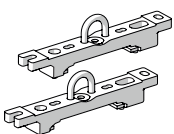

mounting clamp mounted on a mounting rail for a variable mounting distance; 1 pair

Art. No.

222456

Lighting

Linear luminaire With LED

GRP

6602/1123-0300-332-2220-22-857 Art. No. 325345

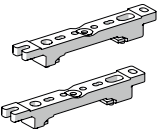

Mounting rail

| | | Art. No. |
|--|--|----------|
|  | for a variable mounting distance; 1 pair | 222826 |

Pipe clamp

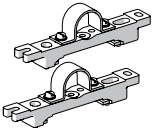
| | | Art. No. |
|--|--|----------|
|  | R 1 1/2"; with mounting rail for a variable mounting distance; material: stainless steel; 1 pair | 222459 |
| | R 1 1/4"; with mounting rail for a variable mounting distance; Material: stainless steel; 1 pair | 222458 |
| | R 2"; with mounting rail for a variable mounting distance; Material: stainless steel; 1 pair | 222460 |

Pole mounting

| | | Art. No. |
|--|--|----------|
|  | Pole mounting acces. 1.4301 ø38mm-1 pair | 324916 |
| | Pole mounting acces. 1.4301 ø42mm-1 pair | 324914 |
| | Pole mounting acces. 1.4301 ø50mm-1 pair | 324915 |
| | Pole mounting acces. 1.4301 ø60mm-1 pair | 324912 |
| | Pole mounting acces. 1.4404 ø50mm-1 pair | 324917 |
| | Pole mounting acces. 1.4404 ø60mm-1 pair | 324913 |

Pole mounting sleeve

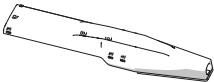
| | | Art. No. |
|--|---|----------|
|  | for the subsequent mounting on lights size 2 and size 4, completely with assembly parts (for pipe diameter 42 mm) | 227512 |

Ring bolt

| | | Art. No. |
|--|--|----------|
|  | M8, direct mounting in insert nuts; 1 pair | 115736 |

Wall mounting

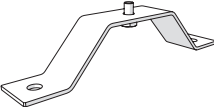
| | | Art. No. |
|--|-------------------------------------|----------|
|  | Wall/ceiling mtg.bkt. 1.4301w-1pair | 324918 |

Spare Parts

Cover

| | | Art. No. |
|--|----------------------|----------|
|  | for luminaire size 2 | 222427 |

We reserve the right to make alterations to the technical data, dimensions, weights, designs and products available without notice. The illustrations cannot be considered binding.