

EC-932-TXF3TV2W-SM-M Art. No. 338431



- Very high optical zoom (40x), electronic image stabiliser and edge recording
- Easy maintenance – innovative modular system
- Single mode fibre optic and 230 VAC power supply
- Cleaning wiper and day & night function
- Wide temperature range: -60 °C ... +60 °C, +75 °C peak

MY R. STAHL EC932A



The EC-932-TXF3TV2W-SM-M camera is a certified camera station made entirely of electropolished AISI316L stainless steel and specially designed for use in potentially explosive areas. It is equipped with the latest generation of a day/night IP camera, a sun shield, a heater and a wind-screen wiper.

The camera uses the latest technologies and is a great video surveillance solution for potentially explosive applications such as oil and gas exploration/production, oil and gas refining/transportation, and installations in the harshest environments, both onshore and offshore.

The camera has been designed with ease of maintenance in mind. The well thought-out enclosure concept allows easy access to all relevant internal components.

The EC-932-TXF3TV2W-SM-M camera offers multi-stream H264/H265/MJPEG encoding, is ON-VIF® compliant and compatible with most VMS solutions available on the market.

The camera is equipped with a 230 VAC power supply module and a single mode fibre optic converter.

Technical Data

General

Series	Bullet Autofokus Zoom Camera - EC-932
Version	Autofocus zoom camera
Description	3MP bullet camera
Variant	Single mode media converter

Explosion Protection

Application range (zones)	1, 2, 21, 22
Scope	EU (CE / ATEX) Global (IECEX) United Kingdom (UKCA) United Kingdom (UKEX) Brazil (INMETRO) United Arab Emirates (ECAS)
IECEX gas certificate	IECEX EXV 22.0032X
IECEX gas explosion protection	Ex db IIC T6...T4 Gb
IECEX dust certificate	IECEX EXV 22.0032X
IECEX dust explosion protection	Ex tb IIIC T85°C...T135°C Db
ATEX gas certificate	ExVeritas 22ATEX1325X
ATEX gas explosion protection	Ex II 2 G Ex db IIC T6...T4 Gb
ATEX dust certificate	ExVeritas 22ATEX1325X
ATEX dust explosion protection	Ex II 2 D Ex tb IIIC T85°C...T135

EC-932-TXF3TV2W-SM-M Art. No. 338431

Explosion Protection

UKEX certification	ExVeritas 22UKEX1326X
INMETRO certification	CPEx 23.1071 X
ECAS certification	24-11-130192/E24-11-134907/NB0001
UKEX gas explosion protection	⊕ II 2 G Ex db IIC T6/5/4 Gb
UKEX dust explosion protection	⊕ II 2 D Ex tb IIIC T85/100/135°C Db
INMETRO gas explosion protection	Ex db IIC T6...T4 Gb
INMETRO dust explosion protection	Ex tb IIIC T85°C...T135°C Db
EMC Directive	EN 55032; EN 55035; EN/IEC 61000-3-2; EN/IEC 61000-3-3; EN/IEC 61000-6-2; EN/IEC 61000-6-4; CISPR-32; CISPR-35; DNV-CG-0339
RoHS Directive	2011/65/EU + 2015/863/EU (RoHS 3)
WEEE Directive	2012/19/EU
Low-voltage Directive	EN/IEC 62368-1
FCC certification	FCC part 15B

Electrical Data

Rated operational voltage AC	230 V
Frequency	50/60 Hz
Power consumption	Max. 40 W
Interfaces	FX (single-mode)
Connection	Ethernet LAN 100Base-TX, RJ45
I/O relay	External input

Camera Data

Sensor	1/2.8" progressive CMOS
Day/night camera	Yes
Resolution	5 MP, 2092x1944 pixels
Zoom	40x optical, 10x digital
Viewing angle	62.6° - 1.9° H, 48,8° - 1.4° V
Focus	Automatic focus
Min.light. B/W (ICR-ON)	0,002 lx
Minimum illumination color (ICR-OFF)	0.04 lx
Frame rate (fps)	60fps (2MP), 30fps (3MP/WDR)
Compression	H.264, H.265, MJPEG
White balance	Yes
Wide Dynamik Range	Yes
Web server	Yes
Streaming	ONVIF Profile S, T, G, M
Special feature	Edge recording, NDAA-compliant,
Analytics	Motion detection / manipulation, intrusion detection, wrong direction, object removal, tampering, loitering, stationary vehicle, object counting
Events	External input, analysis, network failure detection, regular event, manual triggering
Edge Recording	microSD/SDHC/SDXC
Number of streams	4 streams

Software

Network Configuration	IPv4/v6, TCP, RTP, RTSP, HTTP HTTPS, ICMP, FTP, SMTP, PPPoE, UPnP, IGMP, SNMP, QoS, ARP, NTP, DHCP, UDP,
Streaming	ONVIF Profile S, T, G, M

EC-932-TXF3TV2W-SM-M Art. No. 338431

Ambient Conditions

Ambient temperature	-60 – 60 °C
Ambient temperature note	+75 °C peak

Mechanical Data

Degree of protection (IP)	IP66, 67, 68, 69
Note on degree of protection	EN 60529, NEMA 4X
IK impact protection	IK10, front panel IK08
Vibration and shock	EN/IEC 60068-2-6; EN/IEC 60068-2-27; DNV-CG-0339
Enclosure material	Stainless steel 316L
Surface treatment	Electropolished
Cable length	0 m
Fibre optic wavelength	1310 nm
Max. fibre optic cable length	max. 20 km
Opening for cable gland	2x M25x1.5
Integrated wiper	Yes
Scope of delivery	Sun roof included
Weight	10.5 kg
Weight	23.15 lb

Dimensional Drawings (All Dimensions in mm [inches]) – Subject to Alterations

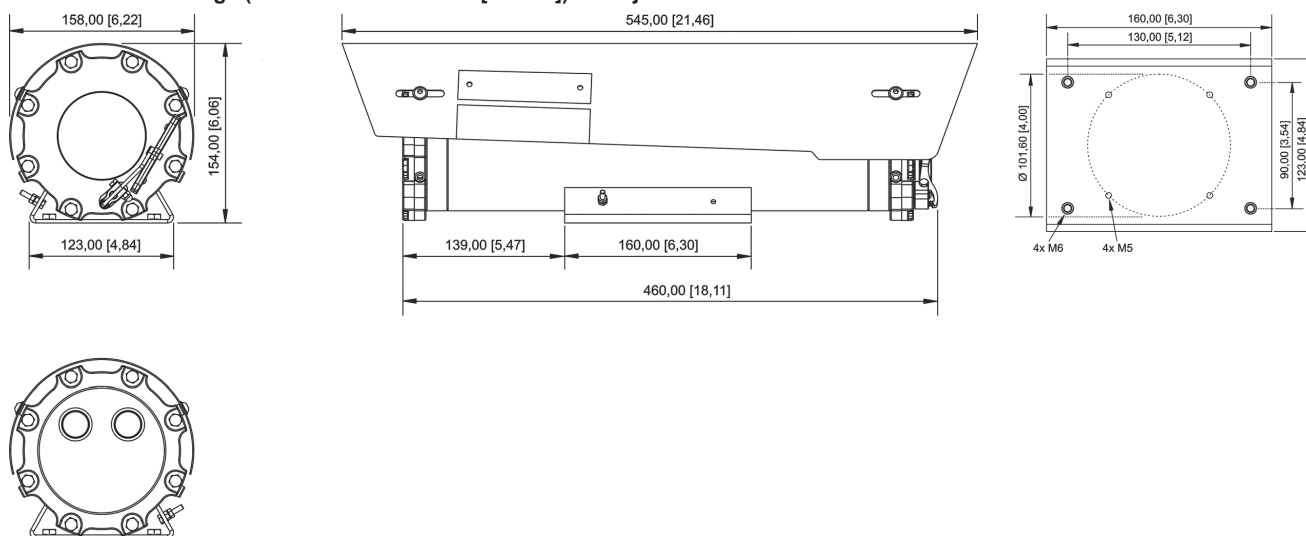

Accessories

Pole mount (pole) adapter



PMA-EC-932-SSPM-M
 Pole mount adapter for wall bracket type SSBK-L and SSBK-M for camera EC-932
 Material: 316L stainless steel (1.4404)
 Weight: 5 kg

Art. No.

341224

EC-932-TXF3TV2W-SM-M Art. No. 338431

Pole mount (top) adaptor

Art. No.



PMA-EC-932-SSPTM-M

Pole Top mount adaptor for EC-932
Material: 316L stainless steel (1.4404)
Weight: 2.5 kg

339153

Wall mount adaptor

Art. No.

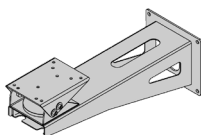

WB-EC-932-SSBK-M

Wall bracket for EC-932
Material: 316L stainless steel (1.4404)
Weight: 6 kg

339152

Multi-cable

Art. No.



VB-CAM-EC-932-5m-EXACCTF5-SCLC-C

Armoured multi-cable for EC-932 series fibre-optic cameras
Length 5 m
Cables for power supply, FO and data
Fibre-optic connections: SC - LC plug
Suitable for highly corrosive environments
Resistant to flames, UV and ozone, oil, petrol and hydrocarbons
Pre-assembled pressure-resistant brass screw connections at both ends
Temperature range -40 °C to +90 °C (-40 °F to +194 °F)

339156

Ex e Terminal box

Art. No.



JCT-8146-Ethernet+Analog 5xcable glands

Terminal box, polyester resin
Version for ethernet Tx or analog cameras
Dimensions without cable glands (HxWxD): 340.5 mm x 340.5 mm x 91 mm
Ingress protection: IP66
equipped with:
5 x cable glands:
2 x CMP-25SC2KVAR KLE MsNi M25x1.5
1 x 8161/7-M25-1707 with red stopping plug
2 x 8161/7-M20-1304 with red stopping plug

265668

EC-932-TXF3TV2W-SM-M Art. No. 338431

Terminal Box

		Art. No.
	<p>JCT-EC-9x2-FO-BOX-SM Terminal box, type 8146 consisting of: Terminal blocks: -XH1 1x 283117 STX mounting rail distributor with 6xLC duplex (single mode) -XD2 4x PT-2.5 grey (labelling: 1 – 4) 1x PT-2.5 green-yellow (labelling: PE) -XD1 2x PT-2.5 grey (labelling: L, L) 2x PT-2.5 blue (labelling: N, N) 2x PT-2.5 green/yellow (labelling: PE, PE) Cable entries (clamping range) (use): 1x CMP-20S-C2K (9.5 ... 15.9 mm) (fibre optic) 1x CMP-25S-C2K (14 ... 22 mm) (water tank) 1x CMP-20S-C2K (9.5 ... 15.9 mm) (power supply) 1x CMP-25C2KVAR (18.2 ... 26.2 mm) (Camera multi-cable) Cable entries, included separately: 2x 8161-M20 with red blind plugs 2x 8161-M25 with red blind plugs Housing material: Polyester resin Ambient temperature, operation: -40°C ... +65°C IP protection: IP66 Use (zone): 1/21, 2/22 Scope of validity: ATEX/IECEX</p>	344919

Watertank

		Art. No.
		339164

EC-932-TXF3TV2W-SM-M Art. No. 338431

Multi-cable

		Art. No.
	<p>VB-CAM-EC-932-5m-EXACCTF5-A Armoured multi-cable for Ethernet cameras of the EC-932 series Length 5 m Cables for power supply, Ethernet and data Suitable for highly corrosive environments Resistant to flames, UV and ozone, oil, petrol and hydrocarbons Pre-assembled pressure-resistant brass cable glands at both ends Temperature range -40 °C to +90 °C (-40 °F to +194 °F) Can be used with terminal box 265668</p>	339155
	<p>VB-CAM-EC-932-10m-EXACCTF10-A Armoured multi-cable for Ethernet cameras of the EC-932 series Length 10 m Cables for power supply, Ethernet and data Suitable for highly corrosive environments Resistant to flames, UV and ozone, oil, petrol and hydrocarbons Pre-assembled pressure-resistant brass cable glands at both ends Temperature range -40 °C to +90 °C (-40 °F to +194 °F) Can be used with terminal box 265668</p>	340600
	<p>VB-CAM-EC-932-5m-EXACCTF5-SCLC-C Armoured multi-cable for EC-932 series fibre-optic cameras Length 5 m Cables for power supply, FO and data Fibre-optic connections: SC - LC plug Suitable for highly corrosive environments Resistant to flames, UV and ozone, oil, petrol and hydrocarbons Pre-assembled pressure-resistant brass screw connections at both ends Temperature range -40 °C to +90 °C (-40 °F to +194 °F)</p>	339156

We reserve the right to make alterations to the technical data, dimensions, weights, designs and products available without notice. The illustrations cannot be considered binding.