

Installation Equipment and Accessories

Cable gland with multiple sealing insert

Red

8161/8-M32-9999-MFD-04050 Art. No. 265090



- For safe cable entry in Ex e and Ex i areas
- Can be used at temperatures of between -60 ... +75 °C, degree of protection IP68
- Available in Ex e and Ex i versions (Ex i version distinguished by its blue cap nut)
- Suitable for cable diameters from 1 ... 48 mm
- Versions with multi-seal inserts

MY R. STAHL 8161B



R. STAHL's 8161/7 and 8161/8 series cable entries can be used to safely run cables into Ex e enclosures. They are suitable for cables between 1 to 48 mm in diameter. They are available for Ex e and Ex i circuits – the Ex i version can be distinguished by its blue cap nut. A stopping plug can be integrated to seal any cable entries that are not being used.

Technical Data

Explosion Protection

| | |
|---------------------------------|------------------------|
| Ex version | Ex i |
| Application range (zones) | 1 2 21 22 |
| IECEX gas certificate | IECEX PTB 14.0011 X |
| IECEX gas explosion protection | Ex eb IIC Gb |
| IECEX dust certificate | IECEX PTB 14.0011 X |
| IECEX dust explosion protection | Ex tb IIIC Db |
| ATEX gas certificate | PTB 14 ATEX 1008 X |
| ATEX gas explosion protection | ⊕ II 2 G Ex eb IIC Gb |
| ATEX dust certificate | PTB 14 ATEX 1008 X |
| ATEX dust explosion protection | ⊕ II 2 D Ex tb IIIC Db |

Ambient Conditions

| | |
|----------------------|-------------------|
| Ambient temperature | -40 °C ... +75 °C |
| Use at the height of | < 2000 m |

Mechanical Data

| | |
|---------------------------|---|
| Version | Multiple seal |
| Strain relief | No |
| Degree of protection (IP) | IP66 |
| Degree of protection note | IP68 at 5 bar 30 min. (IP protection according to IEC/EN 60529) |
| Sealing material | EPDM profile seal |
| Sealing ring material | EPDM |
| Material | Polyamide |
| Material 2 | Glass fibre reinforced |
| Silicone-free | Yes |
| Self-extinguishing | Yes |

Installation Equipment and Accessories

Cable gland with multiple sealing insert

Red

8161/8-M32-9999-MFD-04050 Art. No. 265090



Mechanical Data

| | |
|-----------------------------|--|
| Flame-retardant | Yes |
| Halogen-free | Yes |
| Surface resistance | $\leq 10^{13} \Omega$ |
| Number of cables | 4 |
| Clamping range | 4.5 – 5 mm |
| Armouring type | Unarmoured cable types |
| Cable entry | 1 x M32 – 4 x \varnothing 4,5 – 5 mm |
| Clamping range | 4.5 ... 5 mm |
| Total length | 42 to 50 mm |
| Width across corners | 40 mm |
| Width across flats | 36 mm |
| Thread size | M32 |
| Thread length | 12 mm |
| Thread pitch | 1,5 mm |
| Impact strength (IEC 60079) | 7 J |
| Impact strength | 7 J |
| Colour | Blue |
| Lot size | 25 |
| Weight | 36 g |
| Weight | 0.08 lb |

Dimensional Drawings (All Dimensions in mm [inches]) – Subject to Alterations

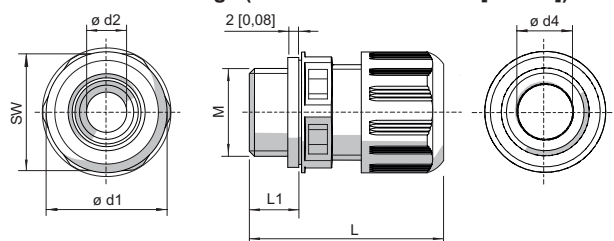

M = Thread size
 SW = Width across flats
 L1 = Thread length
 L = Total length

Cable glands without bend protection

| Thread size | Width across flats | Total length | Total length (with long thread) | Thread length | Thread length (long thread) | Clamping range | Clamping range + reduction sealing insert | Dimension d1 | Dimension d2 | Dimension d4 |
|-------------|--------------------|--------------|---------------------------------|---------------|-----------------------------|----------------|---|--------------|--------------|--------------|
| M12 | 16.00 mm | 29 to 34 mm | 35 to 40 mm | 9 mm | 15 mm | 3 - 6 mm | 1 - 6 mm | 18 mm | 7.3 mm | 6.3 mm |
| M16 | 20.00 mm | 31 to 37 mm | 37 to 43 mm | 9 mm | 15 mm | 5 - 9 mm | 2 - 9 mm | 22 mm | 10.3 mm | 9.3 mm |
| M20 | 24.00 mm | 36 to 43 mm | 41 to 48 mm | 10 mm | 15 mm | 7 - 13 mm | 4 - 13 mm | 27 mm | 13.3 mm | 13.3 mm |
| M25 | 29.00 mm | 38 to 46 mm | 43 to 51 mm | 10 mm | 15 mm | 10 - 17 mm | 7 - 17 mm | 32 mm | 17.3 mm | 17.3 mm |
| M32 | 36.00 mm | 42 to 50 mm | 45 to 53 mm | 12 mm | 15 mm | 13 - 21 mm | 9 - 21 mm | 40 mm | 21.3 mm | 21.3 mm |

Installation Equipment and Accessories

Cable gland with multiple sealing insert

Red

8161/8-M32-9999-MFD-04050 Art. No. 265090



| | | | | | | | | | | |
|-----|-------------|----------------|----------------|-------|-------|------------|------------|-------|------------|----------|
| M40 | 46.00 mm | 52 to 65 mm | 58 to 71 mm | 12 mm | 18 mm | 17 - 28 mm | 12 - 28 mm | 51 mm | 28.3 mm | 30 mm |
| M50 | 55.00 mm | 59 to 72 mm | 63 to 76 mm | 14 mm | 18 mm | 23 - 35 mm | 16 - 35 mm | 61 mm | 35.3 mm | 40 mm |
| M63 | 68.00 mm | 64 to 78 mm | 67 to 81 mm | 15 mm | 18 mm | 34 - 48 mm | 28 - 48 mm | 75 mm | 48.3 mm | 53 mm |

We reserve the right to make alterations to the technical data, dimensions, weights, designs and products available without notice. The illustrations cannot be considered binding.