



- The latest LED technology with a high luminous efficacy and a long service life
- Extremely high luminaire efficacy
- Can be adjusted from a 1.5 to a 3.0 h rated operating time
- Luminous flux after 100,000 h still 90% of the starting luminous flux
- Optionally with DALI for controlling and monitoring the luminaire
- Automatic weekly function test and annual rated operating time test

MY R. STAHL 6409C



The emergency luminaire with Series 6409/4 LED with integrated battery can be installed in stand-by switching, continuous mode or in switchable stand-by switching. A weekly functional test and annual rated operating time test are performed automatically. The results are indicated by an LED.

Technical Data

Explosion Protection

| | |
|---------------------------------|---|
| Ex version | Yes |
| Application range (zones) | 2 21 22 |
| IECEX gas certificate | IECEX IBE 16.0047 |
| IECEX gas explosion protection | Ex db ec IIC T4 Gc |
| IECEX dust certificate | IECEX IBE 16.0047 |
| IECEX dust explosion protection | Ex tb op is / tc IIIC T100 °C Db |
| ATEX gas certificate | IBExU 16 ATEX 1233 |
| ATEX gas explosion protection | ⊕ II 3 G Ex db ec IIC T4 Gc |
| ATEX dust certificate | IBExU 16 ATEX 1233 |
| ATEX dust explosion protection | ⊕ II 2 D Ex tb op is / tc IIIC T100 °C Db |
| Certificates and approvals | ATEX IECEX |
| Certificates | ATEX (IBE), IECEX (IBE), India (PESO) |
| Declaration of Conformity | ATEX (EUK), Declaration of Conformity (AUS) |

Electrical Data

| | |
|------------------------------|-------------------------|
| Rated operational voltage AC | 110 – 240 V |
| Battery version | NiCd battery, gas-tight |
| Battery operating voltage | 6 V |
| Battery capacity | 7 Ah |
| Self-test function | With (standard) |
| Frequency range | 50 – 60 Hz |

Lighting Data

| | |
|-----------------|------------------------|
| Number of lamps | 1 |
| Lamp wattage | 25 W |
| Lamp | LED |
| Light colour | 5000 K – neutral white |

Lighting

Emergency luminaire With LED

GRP

6409/4128-5103-162-1110-11-850011 Art. No. 267859



Lighting Data

| | |
|------------------------|------------------------------------|
| Light distribution | 120°x120° with diffusing glass |
| Luminaire efficacy | 116 lm/W |
| Luminous flux | 2910 lm |
| Operating time | 1.5 h emergency lighting operation |
| Emergency light output | 65% – 1.5 h |
| Colour rendering | ≥ 80 |
| Colour temperature | 5000 K |

Ambient Conditions

| | |
|---------------------|--|
| Ambient temperature | -30 °C ... +50 °C Note: Through wiring Max. 3x16 A -30 °C ... +55 °C Note: Through wiring 2 Max. 3x10 A |
|---------------------|--|

Mechanical Data

| | |
|---|---|
| Version | Standard |
| IP degree of protection (IEC 60598) | IP66/IP67 |
| Enclosure material | Polyester resin, Glass fibre reinforced |
| Enclosure colour | Light grey (RAL 7035) |
| Diffuser | With diffuser |
| Sealing material | Silicone |
| Silicone-free content | Contains silicone |
| Translucent cover material | Polycarbonate |
| Installed terminal strip | PE + N + L1 + L2 + L3 + L´ |
| Max. solid connection terminals | 6 mm ² |
| Max. finely stranded connection terminals | 4 mm ² |
| Type of connection cable | Finely stranded Solid |
| Size | 2 |
| Width | 183.5 mm |
| Height | 125 mm |
| Length | 857 mm |
| Impact strength (IEC 62262) | IK10 |
| Weight | 5.4 kg |
| Weight | 11.9 lb |
| Disconnection of the luminaire | All-pole disconnection |

Components

| | |
|--------------------------|---------------------------------------|
| Threaded plate | 2x plastic |
| Ballast | LED NLE 80W 110-240V/7Ah/1.5h/ |
| Through wiring | With 6 conductors 2.5 mm ² |
| Drilled holes | 3 x M25 |
| Cable glands and entries | 2 x M25 Ø 7 ... |
| Material cable gland | Polyamide, black |
| Stopping plugs | 2 x M25 x 1.5 |
| Stopping plug material | Polyamide, black |
| Cable entry material | Polyamide, black |
| Accessories | Provided |

Lighting

Emergency luminaire With LED

GRP

6409/4128-5103-162-1110-11-850011 Art. No. 267859



Dimensional Drawings (All Dimensions in mm [inches]) – Subject to Alterations

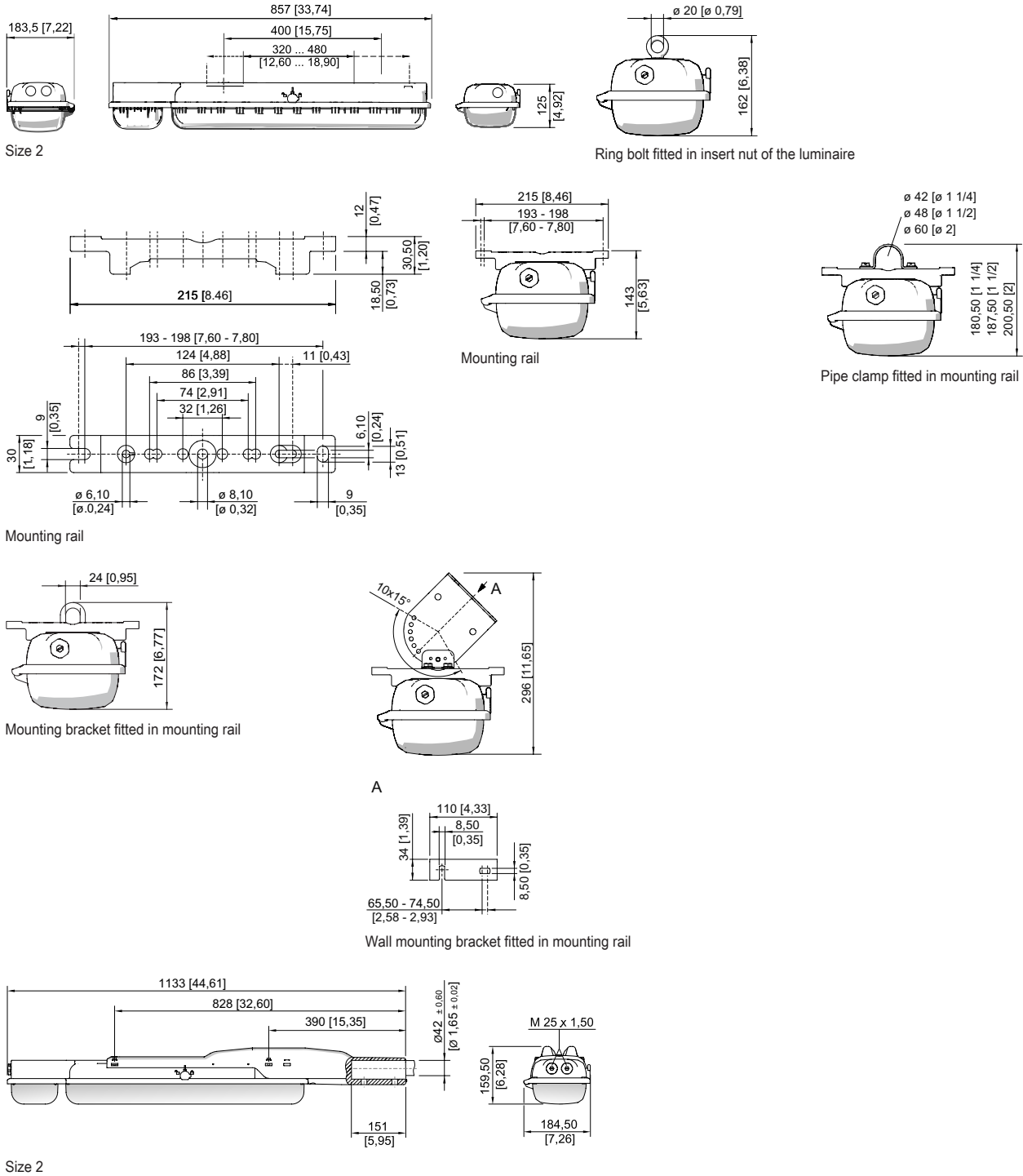

Accessories

Breather

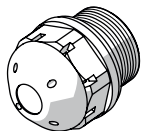

Thread: M25 x 1.5 (20 pieces); without jam nut

Art. No.

285780

Lighting

Emergency luminaire With LED

GRP

6409/4128-5103-162-1110-11-850011 Art. No. 267859

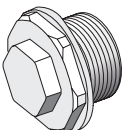

| | | |
|--|---|--------|
|  | Thread: M25 x 1.5 (1 piece); for installation in light fittings; made from stainless steel; without jam nut | 296608 |
|--|---|--------|

| | | |
|--|--|-----------------|
| Box spanner | | Art. No. |
|  | M8 / A/F 13; For actuating the central lock | 222430 |

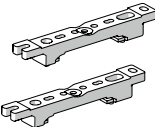
| | | |
|--|--|-----------------|
| Mounting rail | | Art. No. |
|  | for a variable mounting distance; 1 pair | 222826 |

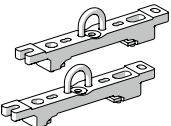
| | | |
|---|--|-----------------|
| Mounting bracket | | Art. No. |
|  | mounting clamp mounted on a mounting rail for a variable mounting distance; 1 pair | 222456 |

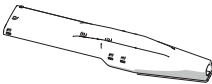
| | | |
|--|---|-----------------|
| Pole mounting sleeve | | Art. No. |
|  | for the subsequent mounting on lights size 2 and size 4, completely with assembly parts (for pipe diameter 42 mm) | 227512 |

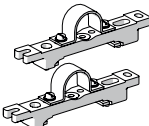
| | | |
|--|--|-----------------|
| Pipe clamp | | Art. No. |
|  | R 1 1/2"; with mounting rail for a variable mounting distance; material: stainless steel; 1 pair | 222459 |
| | R 1 1/4"; with mounting rail for a variable mounting distance; Material: stainless steel; 1 pair | 222458 |
| | R 2"; with mounting rail for a variable mounting distance; Material: stainless steel; 1 pair | 222460 |

| | | |
|--|--|-----------------|
| Ring bolt | | Art. No. |
|  | M8, direct mounting in insert nuts; 1 pair | 115736 |

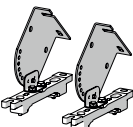
| | | |
|--|--|-----------------|
| Ceiling and wall mounting bracket | | Art. No. |
|  | mounted on a mounting rail for a variable mounting distance; Material: stainless steel; Lamp can be swiveled in steps of 15°; 1 pair | 222827 |

Spare Parts

| | | |
|--|----------------------|-----------------|
| Cover | | Art. No. |
|  | for luminaire size 2 | 222427 |

Lighting

Emergency luminaire With LED

GRP

6409/4128-5103-162-1110-11-850011 Art. No. 267859



Contact element

Art. No.



8080/1-3-L 2 NC contact element

132527

Battery set

Art. No.

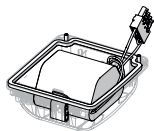

Battery cover with built-in battery. Gas-tight NiCd battery; 7 Ah / 6 V

223532

We reserve the right to make alterations to the technical data, dimensions, weights, designs and products available without notice. The illustrations cannot be considered binding.