



- Ex i temperature transmitter can be configured for virtually any common sensor type
- Space savings due to a slim design – 12.5 mm wide
- Can be used up to SIL 2 (IEC/EN 61508)

07 b

WebCode **9282A**



9282 series temperature transmitters for Ex i field circuits can be used to connect temperature sensors and potentiometers. The devices are easy to configure for virtually any sensor type by means of software. These sensor types include Pt100 sensors, thermocouples and potentiometers. These devices feature three-way galvanic separation.

	NEC® 500 CEC Appendix J					
	Class I		Class II		Class III	
Division	1	2	1	2	1	2
Ex interface	•	•	•	•	•	•
Installation in		•				

	CEC Section 18 NEC® 505 NEC® 506					
	Class I					
Zone	0	1	2	20	21	22
Ex interface	•	•	•			
Installation in			•			

	IECEX / ATEX					
	Zone	0	1	2	20	21
Ex interface	•	•	•	•	•	•
Installation in			•			

Selection Table						
Number of channels	1					
Signal type	Connection type		Product Type		Art. No.	Weight lb
RTD, potentiometer	Screw terminal		9282/11-51-16s		261452	0.37
Thermocouple, mV-source	Screw terminal		9282/12-51-16s		261453	0.39
<p>In the scope of delivery of 9282/12-51-16, a Pt100 is included as cold junction compensation, for mounting on the terminal. Alternatively, cold junction compensation 9191/VS-04 is also available (see accessories and spare parts section).</p> <p>Further versions on the Internet r-stahl.com.</p> <p>Parameterization adapter (software is readily available to download online at r-stahl.com, WebCode: 9282A)</p>						

Technical Data		
Variant	9282/11-51-16s	9282/12-51-16s
Explosion Protection		
IECEX gas explosion protection	Ex ec ic [ia Ga] IIC T4 Gc	Ex ec ic [ia Ga] IIC T4 Gc
IECEX dust explosion protection	[Ex ia Da] IIIC	[Ex ia Da] IIIC
IECEX firedamp protection	Ex [Ex ia Ma] I	Ex [Ex ia Ma] I
Certificates	ATEX (IBE), IECEX (IBE)	ATEX (IBE), IECEX (IBE)
Ship approval	DNV GL	DNV GL
Safety Data		
Max. voltage U_j/V_{oc}	6 V	6 V
Max. current I_j/I_{sc}	16.8 mA	16.8 mA

Technical Data		
Variant	9282/11-51-16s	9282/12-51-16s
Safety Data		
Max. power P_o	25.2 mW	25.2 mW
Safety-related maximum voltage	253 V	253 V
Functional Safety		
SIL	2	2
Auxiliary Power		
Auxiliary power	24 V DC	24 V DC
Input		
Input thermocouple	—	J, K, E, R, S, T, B, N (IEC 584), C, D (ASTM), U, L (DIN 43710), L, A1, A2, A3, M (GOST 8.585)
Input resistance temperature detector (RTD)	Pt 50, Pt 100, Pt 200, Pt 500, Pt 100S, Pt 500S, Ni 100, Ni 500, Cu 50, Cu 53	—
Input resistance temperature detector (RTD) Connection type	2-, 3-, 4-wire connection	—
Input potentiometer	up to 50 k Ω	—
Output		
Output	0/4 ... 20 mA active / source	0/4 ... 20 mA active / source
Load resistance R_L max.	600 Ω	600 Ω
Ambient Conditions		
Ambient temperature °F	-40°F ... +158°F	-40°F ... +158°F
Ambient temperature °C	-40 °C ... +70 °C	-40 °C ... +70 °C
Storage temperature °F	-40°F ... +176°F	-40°F ... +176°F
Storage temperature °C	-40 °C ... +80 °C	-40 °C ... +80 °C
Mounting / Installation		
Mounting type	NS35/15, NS35/7.5 DIN rail	NS35/15, NS35/7.5 DIN rail

Technical Drawings – Subject to Alterations

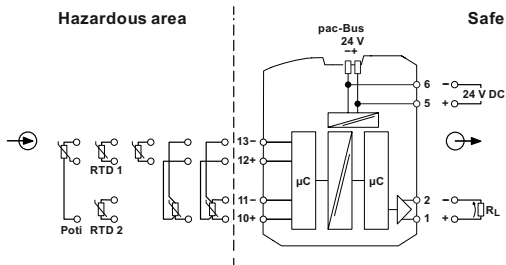

Connection diagram 9282/11-51-16

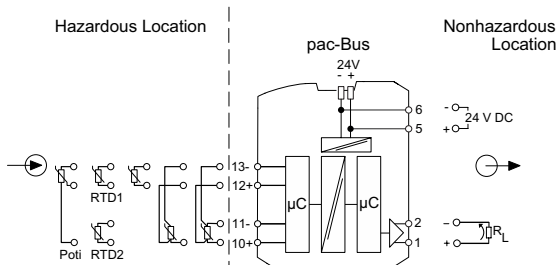

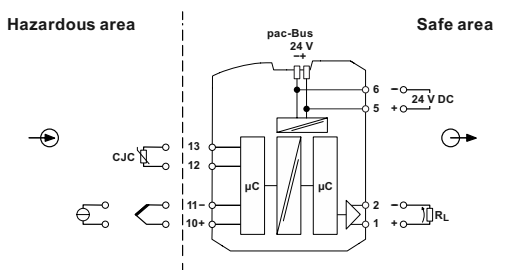

Connection diagram 9282/11-51-16

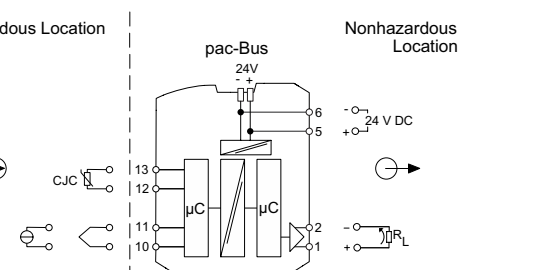

Connection diagram 9282/12-51-16



Connection diagram 9282/12-51-16

Accessories				
Figure	Description	Product Type	Art. No.	Weight lb
External reference junction				
	External reference junction for 2 x thermocouple (1 x Pt100 for 2, 3 or 4 wire connection) integrated into the 4-pole terminal block. Installation takes place on the DIN rail.	9191/VS-04	160675 ▲	0.07
Parameterization adapter				
	Used for parameterization and diagnostics on 9282 series ISpac isolators. Interface to PC: USB Scope of delivery: Adapter and cable (software is available to download online at r-stahl.com, WebCode: 9282A)	-	261507	0.35

Dimensional Drawings (All Dimensions in mm [inches]) – Subject to Alterations

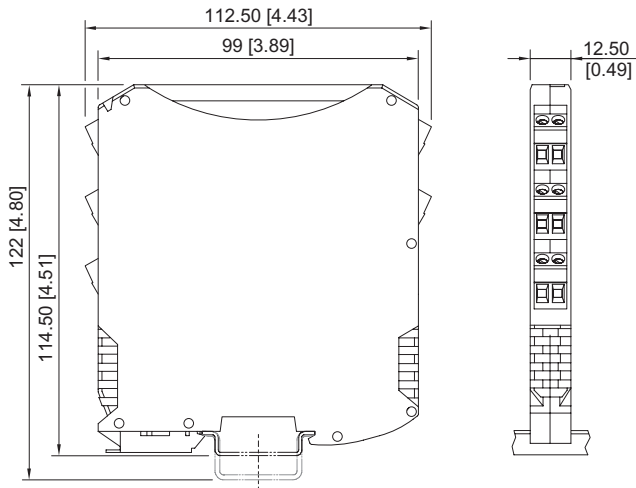

ISpac Series 9260, 9265, 9270, 9275, 9276, 9282 with screw terminal