

## Control Devices

Control device system ConSig 8040 series

Maintained selector switch with contact elements 8082

8040/11E8Z-26M03SA04 Art. No. 287024

STAHL

ConSig



- Quad certified control stations (NEC®, CE Code, ATEX, IECEX)
- Lightweight enclosure made from fiberglass reinforced polyester (FRP), excellent for corrosive atmospheres
- Offers a variety of pushbuttons, illuminated pushbuttons, control switches and LEDs for different configurations
- Customizable control stations available upon request with different entry, contact options and additional certifications

MY R. STAHL 8040E



R. STAHL's series 8040 NEC®/ CE Code control stations utilize explosion-protected components with non-metallic enclosures for the ultimate flexibility, safety and durability in hazardous and hostile locations. Choose from one of the standard versions or contact us for a customized solution.

### Technical Data

#### Explosion Protection

|                                 |   |
|---------------------------------|---|
| Scope of validity               | European Union (ATEX)<br>Canada<br>IECEX<br>USA   |
| Application range (Zones)       | 1<br>2<br>21<br>22  |
| IECEX gas certificate           | IECEX PTB 06.0025   |
| IECEX gas explosion protection  | Ex db eb IIC T6 Gb  |
| IECEX dust certificate          | IECEX PTB 06.0025   |
| IECEX dust explosion protection | Ex tb IIIC T80 °C Db  |
| ATEX gas certificate            | PTB 01 ATEX 1105  |
| ATEX gas explosion protection   | ⊕ II 2 G Ex db eb IIC T6 Gb   |
| ATEX dust certificate           | PTB 01 ATEX 1105  |
| ATEX dust explosion protection  | ⊕ II 2 D Ex tb IIIC T80 °C Db   |
| Certificate ULus                | E182378V1S5   |
| Marking ULus                    | Class I, Div. 2, Groups A,B,C,D<br>Class II, III, Div. 2, F,G<br>Class I, Zone 1, AEx db eb IIC T6<br>Enclosure Type 3, 4, 4X |
| Certificate cUL                 | E182378V1S5   |
| Marking cUL                     | Ex db eb IIC T6<br>Class I, Div. 2, Groups A,B,C,D<br>Class II, III, Div. 2, F, G<br>Enclosure Type 3, 4, 4X                  |
| Certificates                    | ATEX (PTB), Brazil (ULB), China (NEPSI), IECEX (PTB), India (PESO), Korea (KGS), Taiwan (ITRI)                                |
| Ship approval                   | DNVGL   |

# Control Devices



Control device system ConSig 8040 series

Maintained selector switch with contact elements 8082

8040/11E8Z-26M03SA04 Art. No. 287024

## Explosion Protection

|       |  |
|-------|--|
| Notes | Product label for standard configurations as NEC®, CE Code, ATEX, and IECEx. For additional certifications, contact factory. |
|-------|--|

## Electrical Data

|                              |       |
|------------------------------|-------|
| Rated operational voltage AC | 550 V |
| Rated operational current    | 10 A  |

## Ambient Conditions

|                        |                    |
|------------------------|--------------------|
| Ambient temperature °C | -50 °C ... +40 °C  |
| Ambient temperature °F | -58 °F ... +104 °F |

## Mechanical Data

|  |  |
|--|--|
| Degree of protection (IP)                    | IP66   |
| Degree of protection IP (IEC 60529)          | IP66   |
| Enclosure Type (UL50 & UL50E)                | 3, 4, 4X                                       |
| Enclosure material                           | Polyester resin, Fiberglass reinforced         |
| Enclosure color                              | Dark grey                                      |
| Silicone-free                                | No   |
| AWG clamping range                           | 14 AWG   |
| Connection cross-section max.                | 2.5 mm <sup>2</sup>                            |
| Solid connection cross section               | 0.32 – 2.5 mm <sup>2</sup>                     |
| Connection cross-section AWG single stranded | 22 AWG to 14 AWG                               |
| Finely stranded connection cross section     | 0.32 – 2.5 mm <sup>2</sup>                     |
| Finely stranded connection cross-section AWG | 22 AWG - 14 AWG                                |
| Cover fixing type                            | With captive screws, M4 stainless steel screws |
| Width  | 80 mm  |
| Width, inches                                | 3.15 in  |
| Height                                       | 93 mm  |
| Height, inches                               | 3.66 in  |
| Depth  | 72 mm  |
| Depth, inches                                | 2.76 in  |
| Seal   | Silicone, foamed                               |
| Weight                                       | 746 g  |
| Weight                                       | 1.64 lb  |

## Mounting / Installation

|   |             |
|---|-------------|
| Tightening torque of cover screw 1        | 1.4 Nm      |
| Tightening torque of cover screw 1 lbf in | 12.4 lbf in |

## Components

|                              |  |
|------------------------------|--|
| Installation position middle | Small handle, Latching/latching/latching, HAND-0-AUTO (2x 60°), With silicone seal |
| Built-in element middle      | Contact element NO/NO  |
| Flange and plates            | Metal plate, bottom  |
| Entry type                   | CMP  |
| Entry 1 type                 | Metal adapter  |
| Entry 1                      | NPT 3/4"   |
| Metal entry possible 1       | Yes  |

# Control Devices



Control device system ConSig 8040 series

Maintained selector switch with contact elements 8082

8040/11E8Z-26M03SA04 Art. No. 287024

## Technical Drawings – Subject to Alterations



## Dimensional Drawings (All Dimensions in mm [inches]) – Subject to Alterations

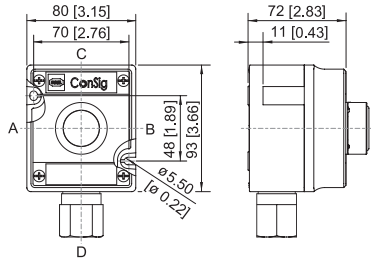



ConSig 8040/11E

## Accessories

### Small rotary actuator, not lockable

|  |  | Art. No. |
|--|--|----------|
|  | Ø 39 mm<br>Black<br>Designation plate: I – 0 – II<br>Number of switching positions: 3<br>Lockable in: Not padlockable<br>Switching function: maintained / maintained / maintained<br>Silicone-free: No | 244649   |

## Spare Parts

|  |  | Art. No. |
|--|--|----------|
|  | Size 1, without insert disc, 1-line label for actuators Ø 39           | 223566   |
|  | Size 2, without insert disc, 1- or 2-line label for actuators Ø 39     | 223567   |
|  | Size 3, without insert disc, 1-, 2- or 3-line label for actuators Ø 39 | 223568   |

## Control Devices



Control device system ConSig 8040 series

Maintained selector switch with contact elements 8082

8040/11E8Z-26M03SA04 Art. No. 287024

| Special key  |                                    | Art. No. |
|--|------------------------------------|----------|
|  | for tightening plastic locking nut | 169101   |

We reserve the right to make alterations to the technical data, dimensions, weights, designs and products available without notice. The illustrations cannot be considered binding.