

EC-932-TXF5TV4W-IP-M Art. No. 338432



- 4K high-resolution camera with electronic image stabiliser and edge recording
- Easy maintenance – innovative modular system
- Single-cable solution (PoE+)
- Cleaning wiper and day & night function
- Wide temperature range: -60 °C ... +60 °C, +75 °C peak

MY R. STAHL EC932A



The EC-932-TXF5TV4W-IP-M IP camera is a certified camera station made entirely of electropolished AISI316L stainless steel and specially designed for use in potentially explosive areas. It's got the latest generation of a day/night IP camera, a sun shield, a heater and a windscreen wiper.

The camera uses the latest technologies and is a great video surveillance solution for potentially explosive applications such as oil and gas exploration/production, oil and gas refining/transportation, and installations in the harshest environments both onshore and offshore.

The camera has been designed with ease of maintenance in mind. The well thought-out enclosure concept allows easy access to all relevant internal components.

The EC-932-TXF5TV4W-IP-M IP camera, available as a PoE+ version, offers multi-stream H264/H265/MJPEG encoding, is ONVIF®-compliant and compatible with most VMS solutions available on the market.

### Technical Data

General	
Series	Bullet Autofokus Zoom Camera - EC-932
Version	Autofocus zoom camera
Description	4K bullet camera
Variant	with PoE+ splitter
Explosion Protection	
Application range (zones)	1, 2, 21, 22
Scope	EU (CE / ATEX) Global (IECEX) United Kingdom (UKCA) United Kingdom (UKEX) Brazil (INMETRO)
IECEX gas certificate	IECEX EXV 22.0032X
IECEX gas explosion protection	Ex db IIC T6...T4 Gb
IECEX dust certificate	IECEX EXV 22.0032X
IECEX dust explosion protection	Ex tb IIIC T85°C...T135°C Db
ATEX gas certificate	ExVeritas 22ATEX1325X
ATEX gas explosion protection	Ex II 2 G Ex db IIC T6...T4 Gb
ATEX dust certificate	ExVeritas 22ATEX1325X
ATEX dust explosion protection	Ex II 2 D Ex tb IIIC T85°C...T135
UKEX certification	ExVeritas 22UKEX1326X
INMETRO certification	CPEX 23.1071 X

EC-932-TXF5TV4W-IP-M Art. No. 338432

### Explosion Protection

UKEX gas explosion protection	Ex II 2 G Ex db IIC T6/5/4 Gb
UKEX dust explosion protection	Ex II 2 D Ex tb IIIC T85/100/135°C Db
INMETRO gas explosion protection	Ex db IIC T6...T4 Gb
INMETRO dust explosion protection	Ex tb IIIC T85°C...T135°C Db
EMC Directive	EN 55035; EN/IEC 61000-3-2; EN/IEC 61000-3-3; EN/IEC 61000-6-2; EN/IEC 61000-6-4; CISPR-32; CISPR-35; DNV-CG-0339
RoHS Directive	2011/65/EU + 2015/863/EU (RoHS 3)
WEEE Directive	2012/19/EU
Low-voltage Directive	EN/IEC 62368-1
FCC certification	FCC part 15B

### Electrical Data

Power consumption	Max. 40 W
Interfaces	TX, PoE+
Connection	Ethernet LAN 100Base-TX, RJ45
I/O relay	External input

### Camera Data

Sensor	1/1.8" progressive CMOS
Day/night camera	Yes
Viewing angle	64° – 3° H, 37° – 2° V
Focus	Automatic focus
Zoom	22x optical, 10x digital
Resolution	4 K, 3864x2180 pixels
Min.light. B/W (ICR-ON)	0,002 lx
Minimum illumination color (ICR-OFF)	0.04 lx
Frame rate (fps)	60 fps (2 MP), 30 fps (4K/WDR)
Compression	H.264, H.265, MJPEG
White balance	Yes
Wide Dynamik Range	Yes
Web server	Yes
Special feature	Edge recording, NDAA-compliant,
Analytics	Motion detection / manipulation, intrusion detection, wrong direction, object removal, tampering, loitering, stationary vehicle, object counting
Events	External input, analysis, network failure detection, regular event, manual triggering
Edge Recording	microSD/SDHC/SDXC
Number of streams	4 streams

### Software

Network Configuration	IPv4/v6, TCP, RTP, RTSP, HTTP HTTPS, ICMP, FTP, SMTP, PPPoE, UPnP, IGMP, SNMP, QoS, ARP, NTP, DHCP, UDP,
Streaming	ONVIF Profile S, T, G, M

### Ambient Conditions

Ambient temperature	-60 – 60 °C
Ambient temperature note	+75 °C peak

### Mechanical Data

Degree of protection (IP)	IP66, 67, 68, 69
Note on degree of protection	EN 60529, NEMA 4X

# Surveillance solutions and cameras

## Autofocus Zoom camera 4K bullet



EC-932-TXF5TV4W-IP-M Art. No. 338432

### Mechanical Data

Vibration and shock	EN/IEC 60068-2-6; EN/IEC 60068-2-27; DNV-CG-0339
Enclosure material	Stainless steel 316L
Surface treatment	Electropolished
Cable length	0 m
Opening for cable gland	2x M25x1.5
Integrated wiper	Yes
Package weight	12 kg
Scope of delivery	Sun roof included
Weight	10.5 kg
Weight	23.15 lb

Dimensional Drawings (All Dimensions in mm [inches]) – Subject to Alterations

### Accessories

#### Pole mount (pole) adapter

Art. No.



##### **PMA-EC-932-SSPM-M**

Pole mount adapter for wall bracket type SSBK-L and SSBK-M for camera EC-932  
Material: 316L stainless steel (1.4404)  
Weight: 5 kg

341224

#### Pole mount (top) adapter

Art. No.



##### **PMA-EC-932-SSPTM-M**

Pole Top mount adapter for EC-932  
Material: 316L stainless steel (1.4404)  
Weight: 2.5 kg

339153

#### Wall mount adaptor

Art. No.

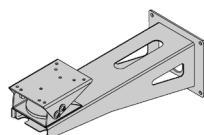

##### **WB-EC-932-SSBK-M**

Wall bracket for EC-932  
Material: 316L stainless steel (1.4404)  
Weight: 6 kg

339152

EC-932-TXF5TV4W-IP-M Art. No. 338432

### Multi-cable

		Art. No.
	<p><b>VB-CAM-EC-932-5m-EXACCTF5-A</b>                      Armoured multi-cable for Ethernet cameras of the EC-932 series                      Length 5 m                      Cables for power supply, Ethernet and data                      Suitable for highly corrosive environments                      Resistant to flames, UV and ozone, oil, petrol and hydrocarbons                      Pre-assembled pressure-resistant brass cable glands at both ends                      Temperature range -40 °C to +90 °C (-40 °F to +194 °F)                      Can be used with terminal box 265668</p>	339155
	<p><b>VB-CAM-EC-932-10m-EXACCTF10-A</b>                      Armoured multi-cable for Ethernet cameras of the EC-932 series                      Length 10 m                      Cables for power supply, Ethernet and data                      Suitable for highly corrosive environments                      Resistant to flames, UV and ozone, oil, petrol and hydrocarbons                      Pre-assembled pressure-resistant brass cable glands at both ends                      Temperature range -40 °C to +90 °C (-40 °F to +194 °F)                      Can be used with terminal box 265668</p>	340600

### Ex e Terminal box

		Art. No.
	<p><b>JCT-8146-Ethernet+Analog 5xcable glands</b>                      Terminal box, polyester resin                      Version for ethernet Tx or analog cameras                      Dimensions without cable glands (HxWxD): 340.5 mm x 340.5 mm x 91 mm                      Ingress protection: IP66                      equipped with:                      5 x cable glands:                      2 x CMP-25SC2KVAR KLE MsNi M25x1.5                      1 x 8161/7-M25-1707 with red stopping plug                      2 x 8161/7-M20-1304 with red stopping plug</p>	265668

EC-932-TXF5TV4W-IP-M Art. No. 338432

### Terminal Box

		Art. No.
	<p><b>JCT-EC-9x2-FO-BOX-SM</b> Terminal box, type 8146 consisting of: Terminal blocks: -XH1 1x 283117 STX mounting rail distributor with 6xLC duplex (single mode) -XD2 4x PT-2.5 grey (labelling: 1 – 4) 1x PT-2.5 green-yellow (labelling: PE) -XD1 2x PT-2.5 grey (labelling: L, L) 2x PT-2.5 blue (labelling: N, N) 2x PT-2.5 green/yellow (labelling: PE, PE) Cable entries (clamping range) (use): 1x CMP-20S-C2K (9.5 ... 15.9 mm) (fibre optic) 1x CMP-25S-C2K (14 ... 22 mm) (water tank) 1x CMP-20S-C2K (9.5 ... 15.9 mm) (power supply) 1x CMP-25C2KVAR (18.2 ... 26.2 mm) (Camera multi-cable) Cable entries, included separately: 2x 8161-M20 with red blind plugs 2x 8161-M25 with red blind plugs Housing material: Polyester resin Ambient temperature, operation: -40°C ... +65°C IP protection: IP66 Use (zone): 1/21, 2/22 Scope of validity: ATEX/IECEX</p>	344919

### Watertank

		Art. No.
		339164

EC-932-TXF5TV4W-IP-M Art. No. 338432

### Multi-cable

		Art. No.
	<p><b>VB-CAM-EC-932-5m-EXACCTF5-A</b>                      Armoured multi-cable for Ethernet cameras of the EC-932 series                      Length 5 m                      Cables for power supply, Ethernet and data                      Suitable for highly corrosive environments                      Resistant to flames, UV and ozone, oil, petrol and hydrocarbons                      Pre-assembled pressure-resistant brass cable glands at both ends                      Temperature range -40 °C to +90 °C (-40 °F to +194 °F)                      Can be used with terminal box 265668</p>	339155
	<p><b>VB-CAM-EC-932-10m-EXACCTF10-A</b>                      Armoured multi-cable for Ethernet cameras of the EC-932 series                      Length 10 m                      Cables for power supply, Ethernet and data                      Suitable for highly corrosive environments                      Resistant to flames, UV and ozone, oil, petrol and hydrocarbons                      Pre-assembled pressure-resistant brass cable glands at both ends                      Temperature range -40 °C to +90 °C (-40 °F to +194 °F)                      Can be used with terminal box 265668</p>	340600
	<p><b>VB-CAM-EC-932-5m-EXACCTF5-SCLC-C</b>                      Armoured multi-cable for EC-932 series fibre-optic cameras                      Length 5 m                      Cables for power supply, FO and data                      Fibre-optic connections: SC - LC plug                      Suitable for highly corrosive environments                      Resistant to flames, UV and ozone, oil, petrol and hydrocarbons                      Pre-assembled pressure-resistant brass screw connections at both ends                      Temperature range -40 °C to +90 °C (-40 °F to +194 °F)</p>	339156

We reserve the right to make alterations to the technical data, dimensions, weights, designs and products available without notice. The illustrations cannot be considered binding.