



THE STRONGEST LINK.



PANEL MOUNTED CONTROL DEVICES









QUICK SELECTION GUIDE

Revolutionize your control setup with our panel mounted control devices 8602C3, offering flexibility, safety, and reliability for hazardous environments. Customize your control arrangement with a simple 3-step process. First, choose an actuator kit from our extensive range of options. Next, decide on the type and quantity of control blocks to meet your specific needs. Finally, order your components and easily customize your control panel.

- Certified for Class I, II, Division 2, Zone 1, 21 (NEC®, Canadian Electrical Code, ATEX, and IECEx)
- Reliable performance in extreme ambient temperatures from -76 °F to +158 °F (-60 °C to +70 °C)
- Rated IP66 and NEMA 4X for robust protection against environmental elements
- Up to 3 control blocks per actuator



Actuator Kits:

	<table border="1"> <tr><td>CATALOG NUMBER</td><td>8602C3-001-S</td></tr> <tr><td>DESCRIPTION</td><td>Momentary black pushbutton kit</td></tr> <tr><td>SAP / ART. NO.</td><td>223692</td></tr> </table>	CATALOG NUMBER	8602C3-001-S	DESCRIPTION	Momentary black pushbutton kit	SAP / ART. NO.	223692		<table border="1"> <tr><td>CATALOG NUMBER</td><td>8602C3-015-S Ø55</td></tr> <tr><td>DESCRIPTION</td><td>Jumbo maintained red/yellow E-STOP kit</td></tr> <tr><td>SAP / ART. NO.</td><td>244637</td></tr> </table>	CATALOG NUMBER	8602C3-015-S Ø55	DESCRIPTION	Jumbo maintained red/yellow E-STOP kit	SAP / ART. NO.	244637
CATALOG NUMBER	8602C3-001-S														
DESCRIPTION	Momentary black pushbutton kit														
SAP / ART. NO.	223692														
CATALOG NUMBER	8602C3-015-S Ø55														
DESCRIPTION	Jumbo maintained red/yellow E-STOP kit														
SAP / ART. NO.	244637														
	<table border="1"> <tr><td>CATALOG NUMBER</td><td>8602C3-003-S</td></tr> <tr><td>DESCRIPTION</td><td>Momentary black mushroom pushbutton kit</td></tr> <tr><td>SAP / ART. NO.</td><td>244564</td></tr> </table>	CATALOG NUMBER	8602C3-003-S	DESCRIPTION	Momentary black mushroom pushbutton kit	SAP / ART. NO.	244564		<table border="1"> <tr><td>CATALOG NUMBER</td><td>8602C3-009-S</td></tr> <tr><td>DESCRIPTION</td><td>Maintained red/yellow E-STOP with key kit including 2 keys MS1</td></tr> <tr><td>SAP / ART. NO.</td><td>223694</td></tr> </table>	CATALOG NUMBER	8602C3-009-S	DESCRIPTION	Maintained red/yellow E-STOP with key kit including 2 keys MS1	SAP / ART. NO.	223694
CATALOG NUMBER	8602C3-003-S														
DESCRIPTION	Momentary black mushroom pushbutton kit														
SAP / ART. NO.	244564														
CATALOG NUMBER	8602C3-009-S														
DESCRIPTION	Maintained red/yellow E-STOP with key kit including 2 keys MS1														
SAP / ART. NO.	223694														
	<table border="1"> <tr><td>CATALOG NUMBER</td><td>8602C3-703-S Ø55</td></tr> <tr><td>DESCRIPTION</td><td>Jumbo momentary black mushroom pushbutton kit</td></tr> <tr><td>SAP / ART. NO.</td><td>244643</td></tr> </table>	CATALOG NUMBER	8602C3-703-S Ø55	DESCRIPTION	Jumbo momentary black mushroom pushbutton kit	SAP / ART. NO.	244643		<table border="1"> <tr><td>CATALOG NUMBER</td><td>8602C3-004-S</td></tr> <tr><td>DESCRIPTION</td><td>Momentary red/black mushroom pushbutton kit</td></tr> <tr><td>SAP / ART. NO.</td><td>244566</td></tr> </table>	CATALOG NUMBER	8602C3-004-S	DESCRIPTION	Momentary red/black mushroom pushbutton kit	SAP / ART. NO.	244566
CATALOG NUMBER	8602C3-703-S Ø55														
DESCRIPTION	Jumbo momentary black mushroom pushbutton kit														
SAP / ART. NO.	244643														
CATALOG NUMBER	8602C3-004-S														
DESCRIPTION	Momentary red/black mushroom pushbutton kit														
SAP / ART. NO.	244566														
	<table border="1"> <tr><td>CATALOG NUMBER</td><td>8602C3-012-S</td></tr> <tr><td>DESCRIPTION</td><td>Maintained black mushroom pushbutton kit</td></tr> <tr><td>SAP / ART. NO.</td><td>223700</td></tr> </table>	CATALOG NUMBER	8602C3-012-S	DESCRIPTION	Maintained black mushroom pushbutton kit	SAP / ART. NO.	223700		<table border="1"> <tr><td>CATALOG NUMBER</td><td>8602C3-014-S Ø55</td></tr> <tr><td>DESCRIPTION</td><td>Jumbo momentary red/black mushroom pushbutton kit</td></tr> <tr><td>SAP / ART. NO.</td><td>244635</td></tr> </table>	CATALOG NUMBER	8602C3-014-S Ø55	DESCRIPTION	Jumbo momentary red/black mushroom pushbutton kit	SAP / ART. NO.	244635
CATALOG NUMBER	8602C3-012-S														
DESCRIPTION	Maintained black mushroom pushbutton kit														
SAP / ART. NO.	223700														
CATALOG NUMBER	8602C3-014-S Ø55														
DESCRIPTION	Jumbo momentary red/black mushroom pushbutton kit														
SAP / ART. NO.	244635														
	<table border="1"> <tr><td>CATALOG NUMBER</td><td>8602C3-010-S</td></tr> <tr><td>DESCRIPTION</td><td>Maintained red/yellow E-STOP kit</td></tr> <tr><td>SAP / ART. NO.</td><td>223698</td></tr> </table>	CATALOG NUMBER	8602C3-010-S	DESCRIPTION	Maintained red/yellow E-STOP kit	SAP / ART. NO.	223698		<table border="1"> <tr><td>CATALOG NUMBER</td><td>8602C3-006-S</td></tr> <tr><td>DESCRIPTION</td><td>Maintained red/black pushbutton with key kit including 2 keys MS1</td></tr> <tr><td>SAP / ART. NO.</td><td>223696</td></tr> </table>	CATALOG NUMBER	8602C3-006-S	DESCRIPTION	Maintained red/black pushbutton with key kit including 2 keys MS1	SAP / ART. NO.	223696
CATALOG NUMBER	8602C3-010-S														
DESCRIPTION	Maintained red/yellow E-STOP kit														
SAP / ART. NO.	223698														
CATALOG NUMBER	8602C3-006-S														
DESCRIPTION	Maintained red/black pushbutton with key kit including 2 keys MS1														
SAP / ART. NO.	223696														

Actuator Kits:



CATALOG NUMBER	8602C3-023-S
DESCRIPTION	Momentary twin pushbutton kit
SAP / ART. NO.	244639



CATALOG NUMBER	8602C3-008-S-M01-02-MS01
DESCRIPTION	Key-operated switch 2-position kit including 2 keys MS1
SAP / ART. NO.	244574



CATALOG NUMBER	8602C3-008-S-M03-03-MS01
DESCRIPTION	Key-operated switch 3-position kit including 2 keys MS1
SAP / ART. NO.	244633



CATALOG NUMBER	8602C3-727-S-M01-02-E08
DESCRIPTION	Padlock switch, 2-position kit
SAP / ART. NO.	244651



CATALOG NUMBER	8602C3-727-S-M03-03-E03
DESCRIPTION	Padlock switch 3-position kit
SAP / ART. NO.	244653



CATALOG NUMBER	8602C3-054-S-C06
DESCRIPTION	Indicator lamp actuator kit including colored lenses
SAP / ART. NO.	223123



CATALOG NUMBER	8602C3-735-S-C06
DESCRIPTION	Illuminated pushbutton kit including colored lenses
SAP / ART. NO.	244655

Notes:

- Kits include panel mount bracket and hardware
- Switches with coding elements. Conversion to "spring return" or "key not removable" function is possible during installation
- Colors include RD, WH, YE, GN and BU

Control Blocks:



CATALOG NUMBER	8082C3-21-1-0
DESCRIPTION	SAP / ART. NO.
Contact block N.C. 1 piece	315695
Contact block N.C. 10 pieces	315697



CATALOG NUMBER	8082C3-21-2-0
DESCRIPTION	SAP / ART. NO.
Contact block N.O. 1 piece	315696
Contact block N.O. 10 pieces	315698



CATALOG NUMBER	8082C3-21-3-0
DESCRIPTION	SAP / ART. NO.
Contact block N.C. + N.O. 5 pieces	315699



CATALOG NUMBER	8010C6-21-1
DESCRIPTION	SAP / ART. NO.
LED module 1 piece	315700
LED module 5 pieces	315711

Accessories:

DESCRIPTION	SAP / ART. NO.
Spare keys MS1	107109
Actuator wrench for 8602	169101
Label holder for 39 mm actuator – 2 lines of text	223567
Black plug / Place holder 8602C3-&33-S	244307
Button plate set all colors	321791
Switch label set (Blank, H-O-A, Local-Remote)	321792

Knockout Details:

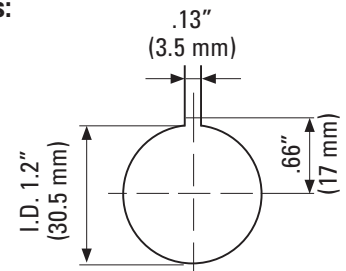

R. STAHL INC
 13259 N. Promenade Blvd
 Stafford, TX 77477
 USA
 sales.us@r-stahl.com
 rstahl.com

R. STAHL Ltd
 8925-51 Avenue NW, Unit 303
 Edmonton, AB T6E5J3
 Canada
 sales.ca@r-stahl.com
 rstahl.com