

## Retrofitting kit for panel mounting devices

Series 8003

## Contents

1	General Information .....	2
1.1	Manufacturer .....	2
1.2	Information regarding the operating instructions .....	2
1.3	Conformity with standards and regulations .....	2
2	Explanation of the symbols .....	3
2.1	Symbols in these modification instructions .....	3
2.2	Warning notes .....	3
2.3	Symbols on the device .....	3
3	Safety .....	4
4	Safety notes .....	4
4.1	Operating instructions storage .....	4
4.2	Safe use .....	4
4.3	Modifications and alterations .....	4
5	Intended Use .....	5
6	Mounting / dismantling, operating position .....	5
6.1	Panel mounting device with connection chamber .....	5
6.2	Panel mounting device without connection chamber .....	8
6.3	Installation of field installation kit 1 for 8602/2 with protective collar or locking device .....	10
7	Disposal .....	11
8	Accessories and Spare parts .....	11

## 1 General Information

### 1.1 Manufacturer

R. STAHL Schaltgeräte GmbH  
 Am Bahnhof 30  
 74638 Waldenburg  
 Germany

Phone: +49 7942 943-0  
 Fax: +49 7942 943-4333  
 Internet: [www.stahl-ex.com](http://www.stahl-ex.com)  
 E-Mail: [info@stahl.de](mailto:info@stahl.de)

### 1.2 Information regarding the operating instructions



ID-No.: 261612 / 8003612300  
 Publication Code: 2017-07-06-BA00-III-en-00

### 1.3 Conformity with standards and regulations

See certificates and EU Declaration of Conformity: [www.stahl-ex.com](http://www.stahl-ex.com).

## 2 Explanation of the symbols



### 2.1 Symbols in these modification instructions

Symbol	Meaning
	Tips and recommendations on the use of the device
	Danger due to explosive atmosphere

### 2.2 Warning notes

Warning notes must be observed under all circumstances, in order to minimize the risk due to construction and operation. The warning notes have the following structure:

- Signalling word: DANGER, WARNING, CAUTION, NOTICE
- Type and source of danger/damage
- Consequences of danger
- Taking countermeasures to avoid the danger/damage

	<b>DANGER</b>
	Danger to persons Non-compliance with the instruction results in severe or fatal injuries to persons.
	<b>WARNING</b>
	Danger to persons Non-compliance with the instruction can result in severe or fatal injuries to persons.
	<b>CAUTION</b>
	Danger to persons Non-compliance with the instruction can result in light injuries to persons.
<b>NOTICE</b>	
Avoiding material damage Non-compliance with the instruction can result in material damage to the device and / or its environment.	

### 2.3 Symbols on the device

Symbol	Meaning
NB 0158 <small>16338E00</small>	Notified body for quality control.
 <small>02198E00</small>	Device certified for hazardous areas in accordance with the marking.

### 3 Safety

Qualified specialist personnel are required to perform the activities described in these modification instructions. This primarily applies to work in the following areas:

- Product selection, project engineering and modification
- Mounting/dismounting the device
- Installation
- Commissioning
- Maintenance, repair, cleaning

**Specialists who perform these tasks must have a level of knowledge that meets applicable national standards and regulations.**

**Additional knowledge is required for tasks in hazardous areas! R. STAHL recommends having a level of knowledge equal to that described in the following standards:**

- IEC/EN 60079-14 (Electrical installations design, selection and erection)
- IEC/EN 60079-17 (Inspection and maintenance of electrical installations)
- IEC/EN 60079-19 (Equipment repair, overhaul and reclamation)

## 4 Safety notes

### 4.1 Operating instructions storage

- Read the modification instructions carefully and store them at the mounting location of the device.
- Observe applicable documents and operating instructions of the devices to be connected.

### 4.2 Safe use

**Observe the following information during installation and operation:**

- Any damage can invalidate the explosion protection
- National and local safety regulations
- National and local accident prevention regulations
- National and local assembly and installation regulations
- Generally recognized technical regulations
- Safety notes in these operating instructions
- Characteristic values and rated operating conditions on the rating plates and data plates
- Additional information plates fixed directly to the device
- Do not damage circumferential seal.

### 4.3 Modifications and alterations

	DANGER
	<p>Explosion hazard due to improper use! Non-compliance results in severe or fatal injuries.</p> <ul style="list-style-type: none"> <li>• Use the device only according to the operating conditions described in these modification instructions.</li> </ul>

## 5 Intended Use

These retrofitting instructions describe the correct method for retrofitting the 8003/.. panel mounting device

## 6 Mounting / dismounting, operating position

### 6.1 Panel mounting device with connection chamber

Procedure for replacing a panel mounting device:

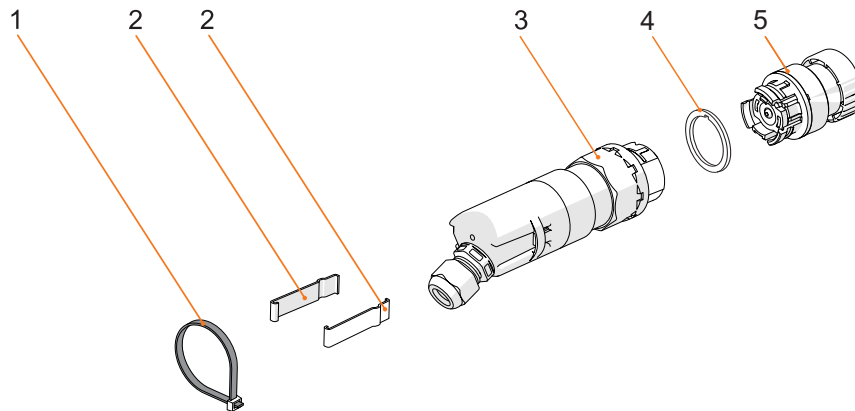

19451E00

#### Field installation kit 2: 8003/1.1 and 8003/1.3

1. Stainless steel cable strap
2. Stainless steel retaining clip
3. Panel mounting device

#### Field installation kit 1: 8602/2

4. Seal (2x enclosed. The second seal is required when using a protective collar or locking device)
5. 8602/2 actuator

Dismounting the installed actuator:

Step 1:

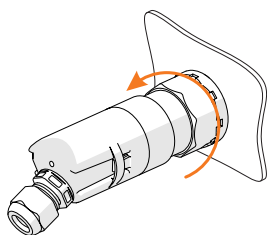

19511E00

- Loosen the threaded nuts on the panel mounting device (3).

Step 2:

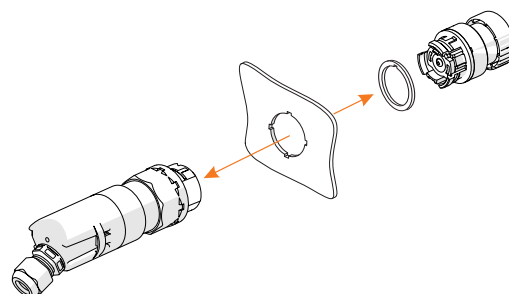

19512E00

- Separate the actuator (5) with seal (4) and panel mounting device (3) from each other.

**Procedure for replacing a panel mounting device:**

**Installation of field installation kit 1 for 8602/2**

**Step 1:**

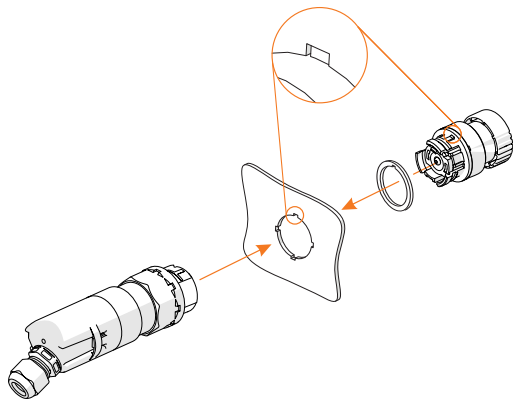

19513E00

- Correctly fit the seal (4) to the actuator (5) supplied.
- Check that the seal (4) is correctly positioned and aligned. When doing so, ensure that the groove of the actuator (5) is positioned in the cut-out provided in the seal (4).
- Push the supplied actuator (5) into the enclosure cover. When doing so, ensure that the groove of the actuator (5) is positioned in the cut-out provided in the enclosure cover (6).
- Fasten the panel mounting device (3) to the actuator (5) from the rear using the snap fit.

**Step 2:**

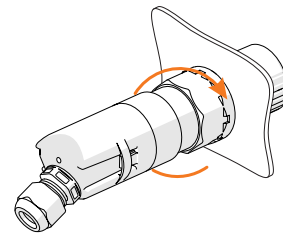

19514E00

- Tighten the locknut on the panel mounting device (3) to a torque of 2.5 Nm.

**Procedure for replacing a panel mounting device:**

**Installation of field installation kit 2: 8003/1.1 and 8003/1.3**

**Step 1:**

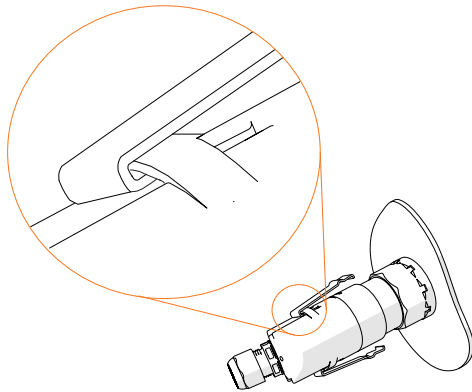

19546E00

- Hook the retaining clips (2) into the groove on the side of the panel mounting device (3).

**Step 2:**

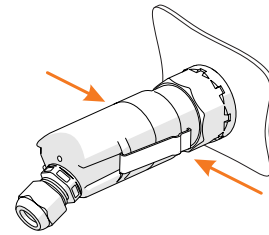

19452E00

- Apply pressure in the direction of the arrow to snap the retaining clips (2) onto the panel mounting device (3).

**Step 3:**

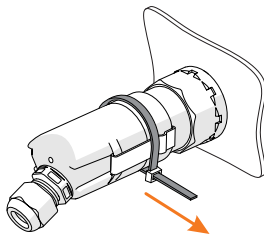

19453E00

- Tighten the cable strap (1) to secure the retaining clips (2) in place (without twisting them).
- Check that the retaining clips (2) are secure.

**Step 4:**

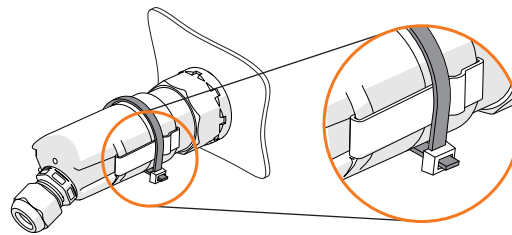

19454E00

- The protruding end of the cable strap (1) has to be cut off.

## 6.2 Panel mounting device without connection chamber

Procedure for replacing a panel mounting device:

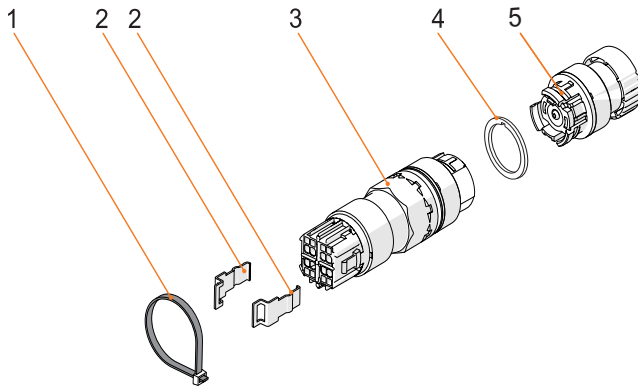

19446E00

**Field installation kit 3: 8003/1.2 and 8003/1.4**

1. Stainless steel cable strap
2. Stainless steel retaining clip
3. Panel mounting device

**Field installation kit 1: 8602/2**

4. Seal (2x enclosed. The second seal is required when using a protective collar or locking device)
5. 8602/2 actuator

**Dismounting the installed actuator:**

**Step 1:**

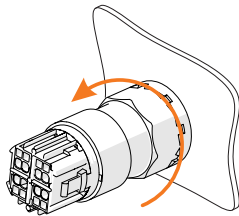

19563E00

- Loosen the threaded nuts on the panel mounting device (3).

**Step 2:**

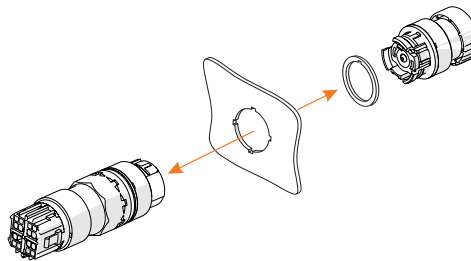

19564E00

- Separate the actuator (5) with seal (4) and panel mounting device (3) from each other.



**Procedure for replacing a panel mounting device:**

**Installation of field installation kit 1 for 8602/2**

**Step 1:**

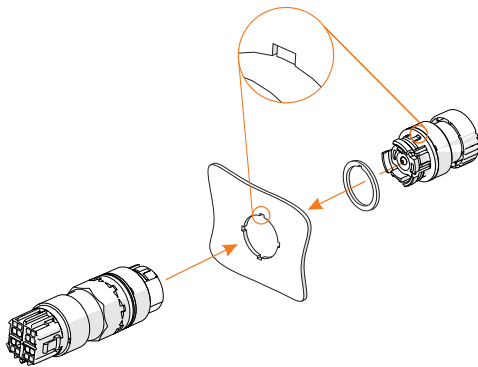

19565E00

- Correctly fit the seal (4) to the actuator (5) supplied.
- Check that the seal (4) is correctly positioned and aligned. When doing so, ensure that the groove of the actuator (5) is positioned in the cut-out provided in the seal (4).
- Push the supplied actuator (5) into the enclosure cover. When doing so, ensure that the groove of the actuator (5) is positioned in the cut-out provided in the enclosure cover (6).
- Fasten the panel mounting device (3) to the actuator (5) from the rear using the snap fit.

**Step 2:**

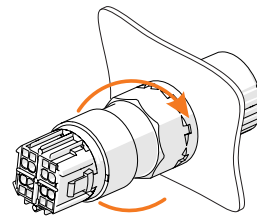

19566E00

- Tighten the locknut on the panel mounting device (3) to a torque of 2.5 Nm.

**Installation of field installation kit 3: 8003/1.2 and 8003/1.4**

**Step 1:**

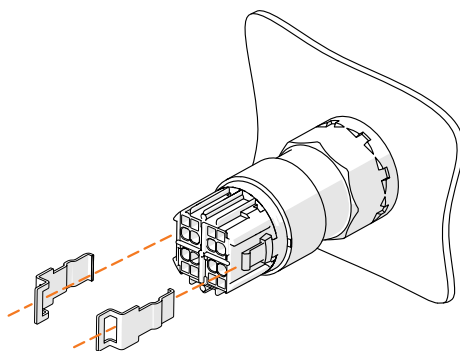

19447E00

- Insert the retaining clips (2) into the groove on the side of the panel mounting device (3).

**Step 2:**

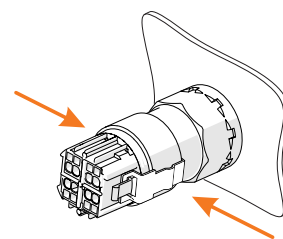

19567E00

- Apply pressure in the direction of the arrow to snap the retaining clips (2) onto the panel mounting device (3).

**Procedure for replacing a panel mounting device:**

**Step 3:**

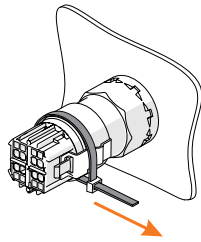

19448E00

- Tighten the cable strap (1) to secure the retaining clips (2) in place (without twisting them).
- Check that the retaining clips (2) are secure.

**Step 4:**

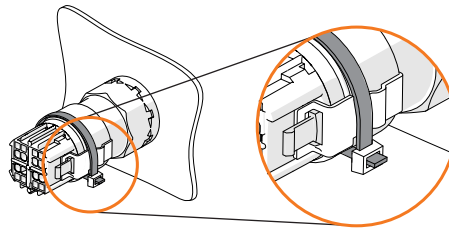

19449E00

- The protruding end of the cable strap (1) has to be cut off.

**6.3 Installation of field installation kit 1 for 8602/2 with protective collar or locking device**

**Procedure for replacing the actuator  
(installation of field installation kit 1 for 8602/2):  
with protective collar or locking device**

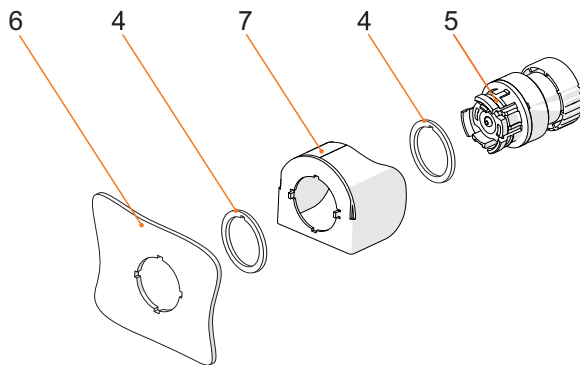

19441E00

- When adding an accessory (7) to the actuator (5) and reassembling it, one seal (4) must be used between the actuator (5) and the accessory (7), and one seal (4) must be used between the accessory (7) and the enclosure cover (6). Checks must be carried out to ensure that the seals (4) are seated correctly.

## 7 Disposal

- Observe national and local regulations and statutory regulation regarding disposal.
- Separate materials when sending it for recycling.
- Ensure environmentally friendly disposal of all components according to the statutory regulations.

## 8 Accessories and Spare parts

### *NOTICE*

Malfunction or damage to the device due to the use of non-original components.  
Non-compliance can result in material damage.

- Use only original accessories and spare parts from R. STAHL Schaltgeräte GmbH.



For accessories and spare parts, see data sheet on our homepage  
[www.stahl-ex.com](http://www.stahl-ex.com).